

LOC	DIST	REVISIONS			
GP	00	REV	DATE	BY	CHKD
		C	07DEC2011	TX	AC
		C1	09SEP2013	PP	SH
		C2	16JAN2014	PP	SH
		C3	24MAR2014	JZ	SH

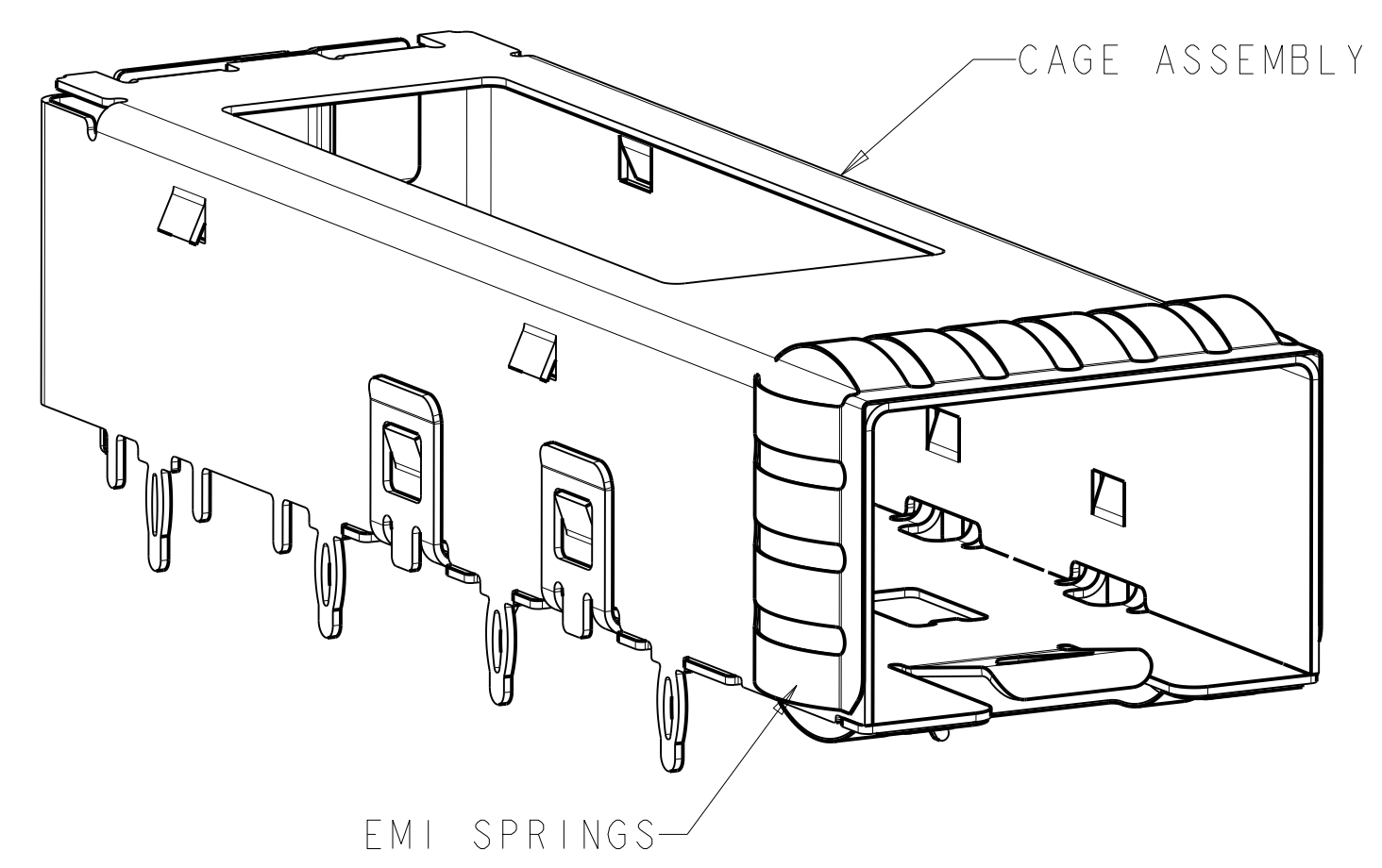

2007198-2  
SCALE 5:1

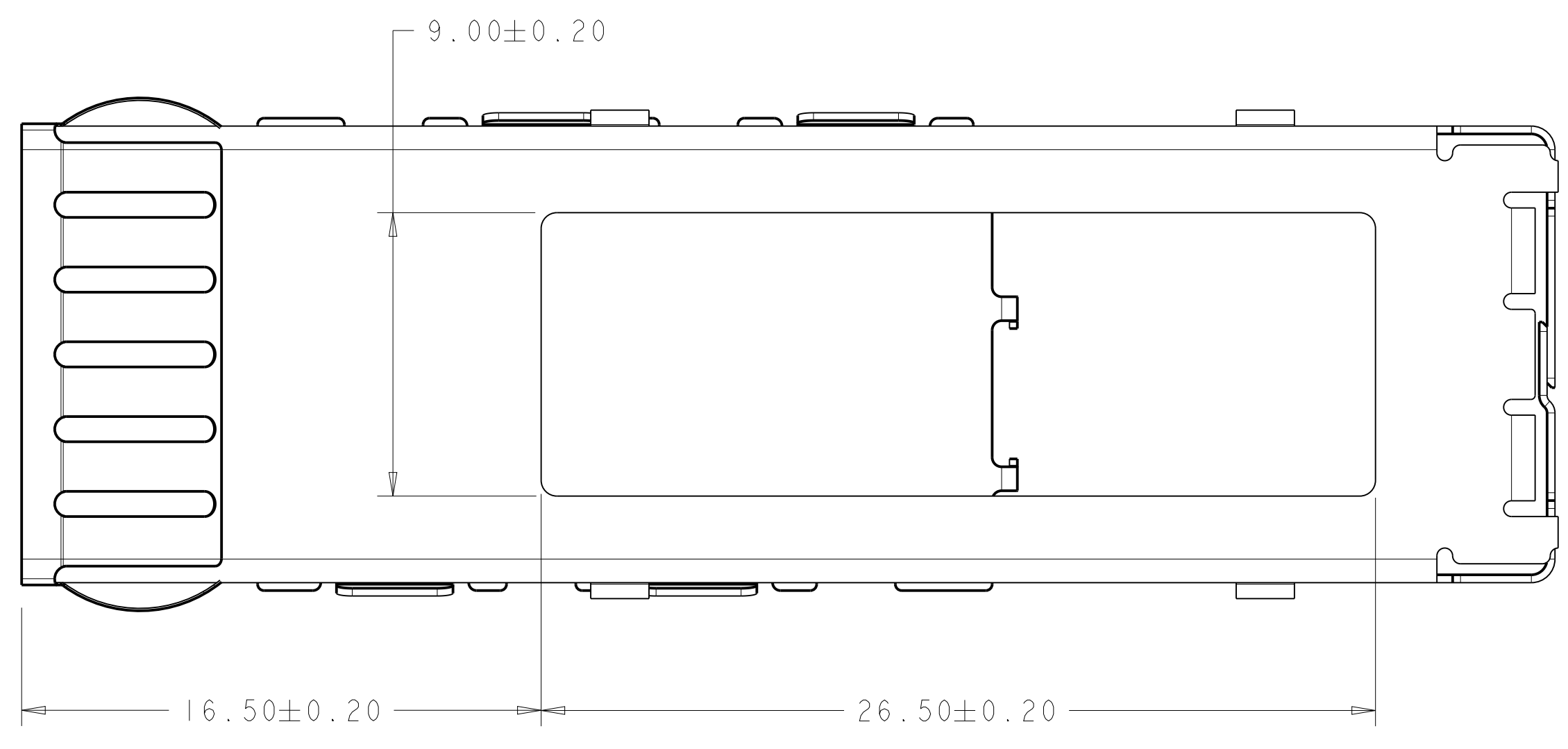

2007198-2  
SAME AS 2007198-1 EXCEPT AS SHOWN  
TOP VIEW

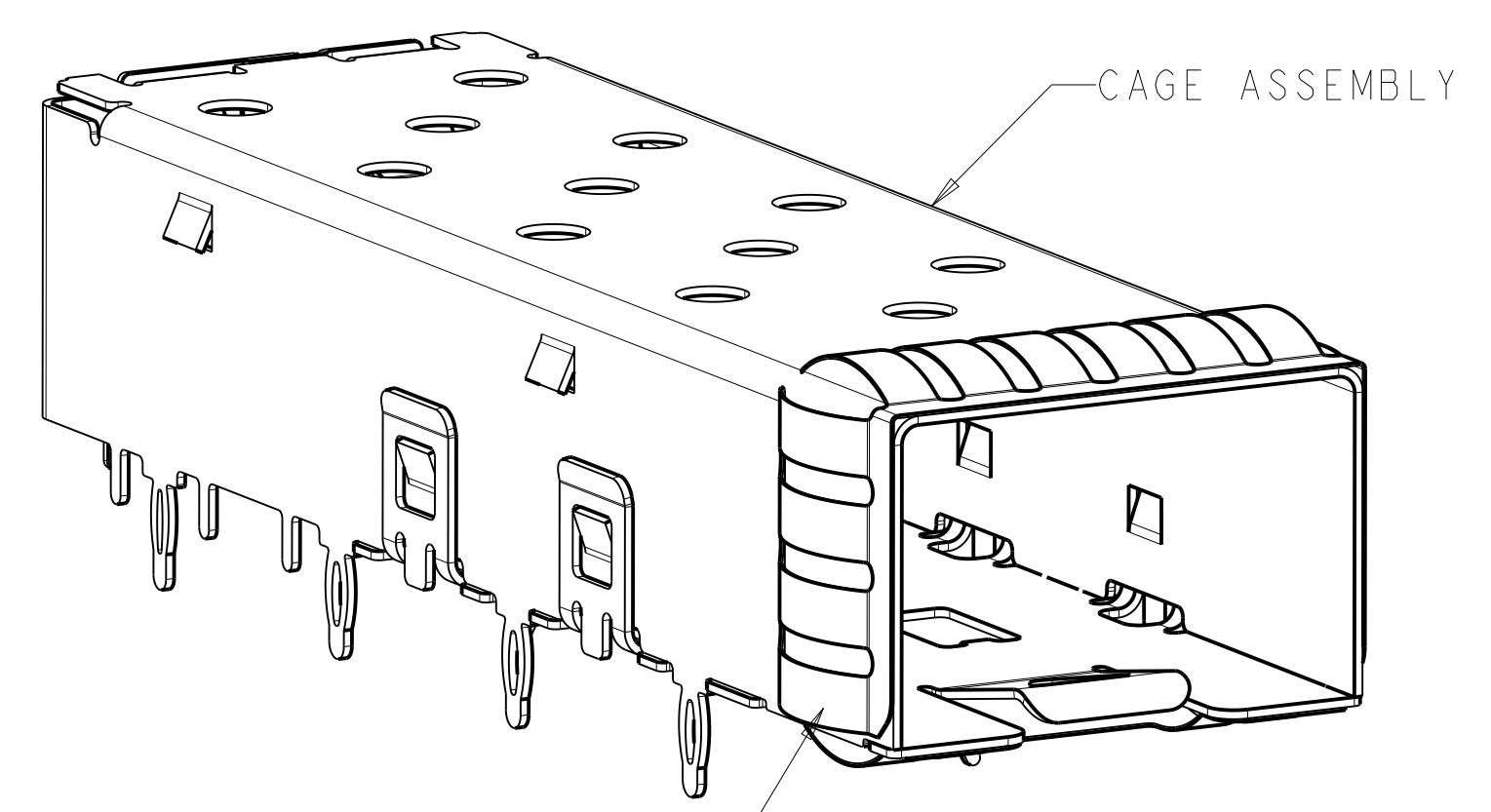

2007198-1/-9  
2007198-9 SAME AS 2007198-1, ONLY PACKAGE DIFFER  
SCALE 5:1

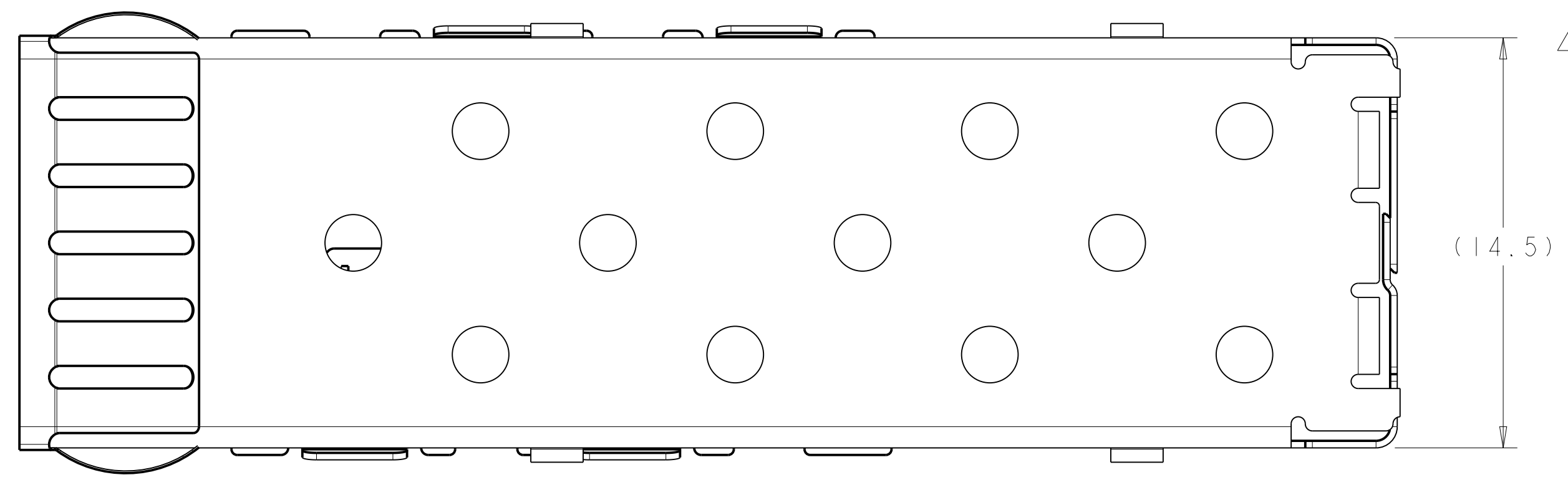

2007198-1/-9  
TOP VIEW

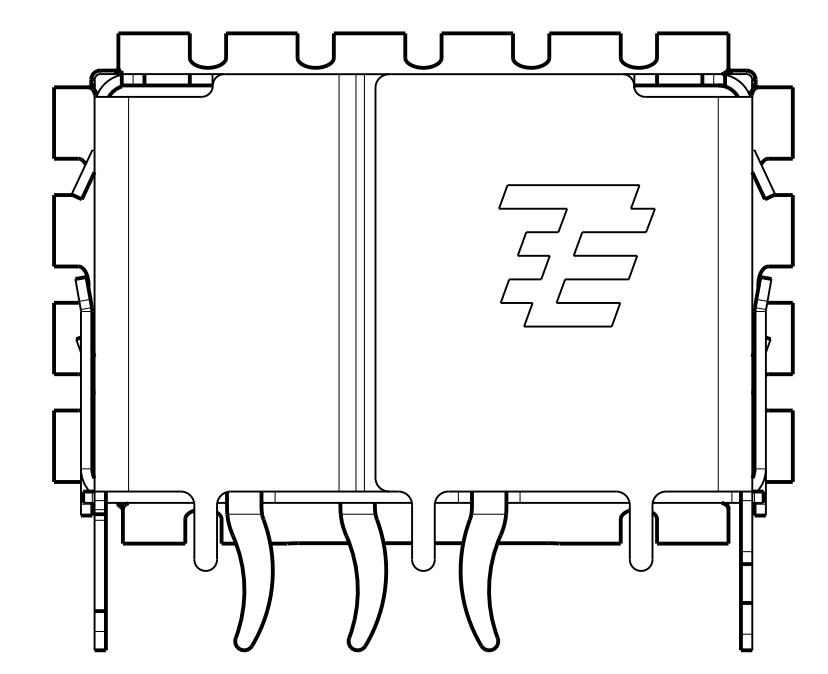
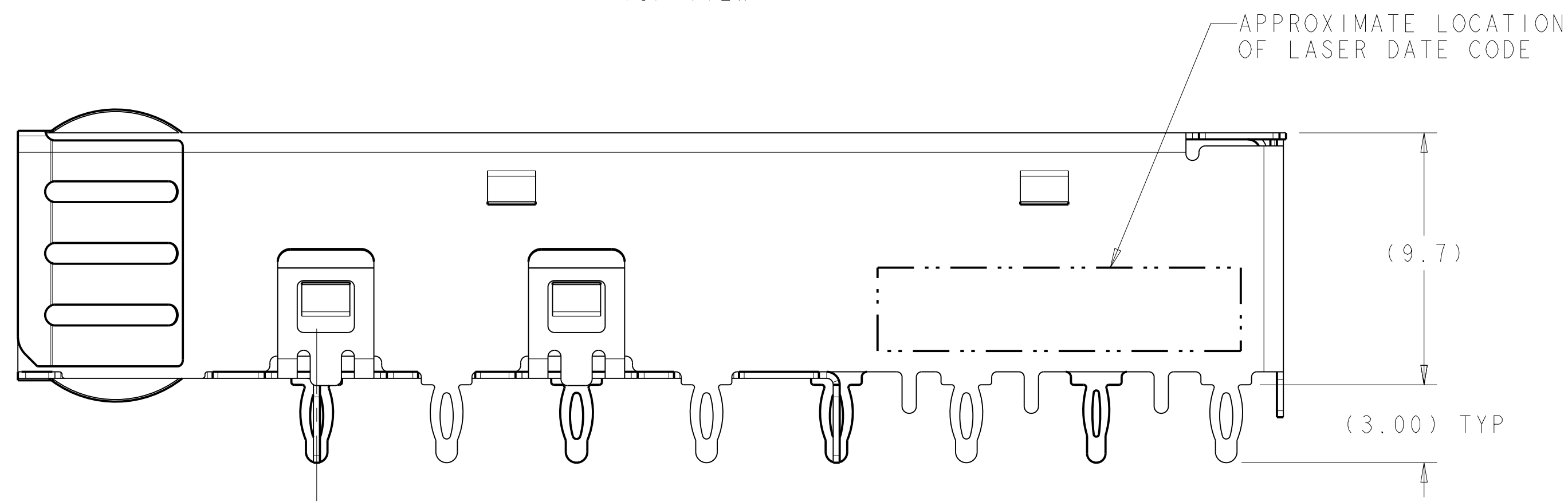
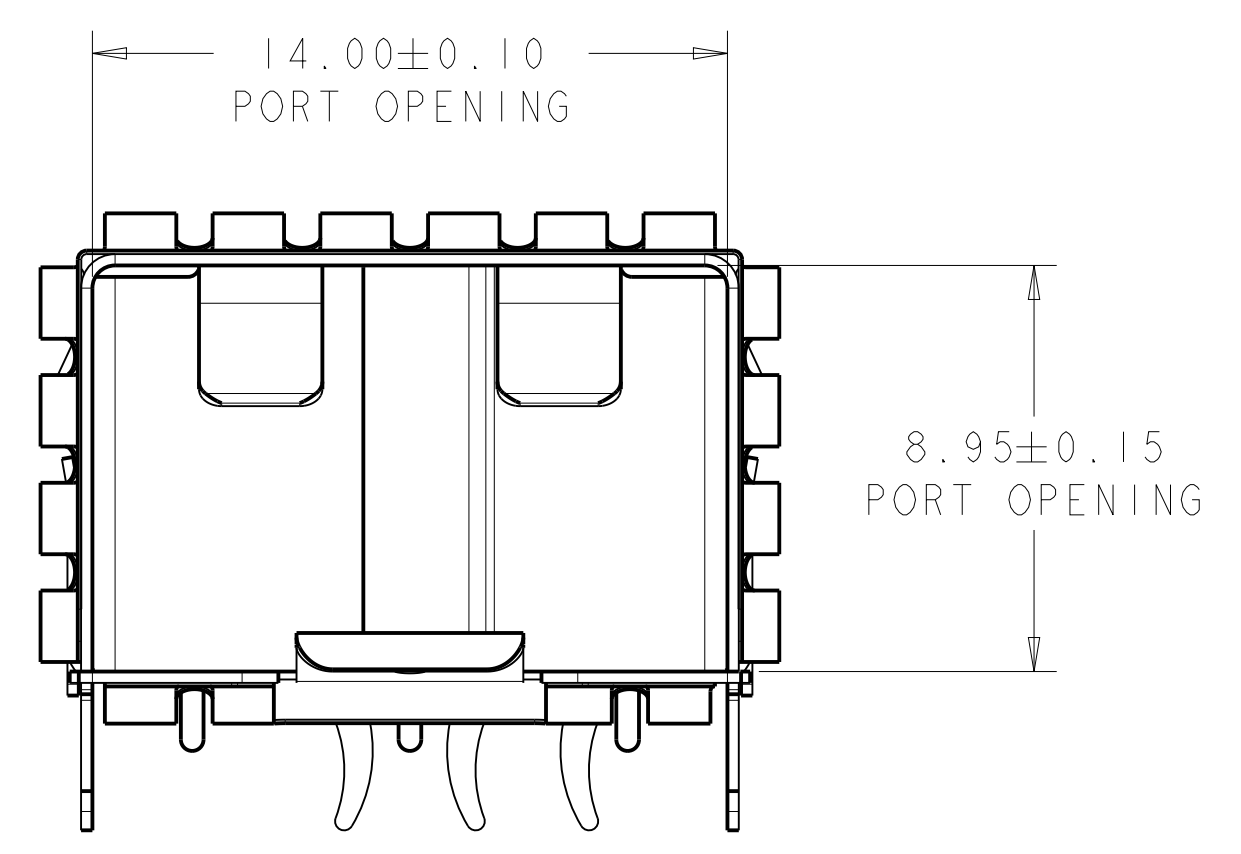

- 1. MATERIAL:  
CAGE ASSEMBLY - 0.25mm THICK NICKEL SILVER ALLOY.  
EMI SPRINGS - COPPER ALLOY.
- 2. FINISH  
EMI SPRINGS - 0.8um MIN MATTE TIN OVER 0.8um MIN NICKEL,  
NON-PLATED EDGES PERMISSIBLE.
- 3. MATES WITH SFP MSA COMPLIANT TRANSCEIVERS.
- 4. PADS AND VIAS CHASSIS GROUND.
- 5. DATUM AND BASIC DIMENSION ESTABLISHED BY CUSTOMER.
- 6. MINIMUM PC BOARD THICKNESS:  
SINGLE SIDED = 1.50 mm  
DOUBLE SIDED = 3.00 mm
- 7. REFERENCE APPLICATION SPEC. 114-13120, HOLE A, FOR  
RECOMMENDED DRILL HOLE DIAMETER AND PLATING THICKNESS.
- 8. REFERENCE APPLICATION SPEC. 114-13120, HOLE C, FOR  
RECOMMENDED DRILL HOLE DIAMETER AND PLATING THICKNESS.
- 9. NOTE DELETED
- 10. PACKAGE TYPE IS TAPE AND REEL.

DESCRIPTION	PART NUMBER
W/O INSULATING TAPE EMI HOLES	2007198-9
W/O INSULATING TAPE NEW LANCE	2007198-7
W/ INSULATING TAPE EMI HOLES	2007198-5
W/O INSULATING TAPE HEATSINK OPENING	2007198-2
W/O INSULATING TAPE EMI HOLES	2007198-1
INSULATING TAPE	PART NUMBER

THIS DRAWING IS A CONTROLLED DOCUMENT.

DIMENSIONS:	TOLERANCES UNLESS OTHERWISE SPECIFIED:	APVD	DATE
mm	0 PLC ±0.1 1 PLC ±0.1 2 PLC ±0.1 3 PLC ±0.05 4 PLC ±0.05 ANGLES ±0.05	M. SCHMITT	07JUN07
MATERIAL	FINISH	CHK	DATE
		M. SCHMITT	07JUN07
		APVD	DATE
		B. WERTZ	07JUN07
		NAME	
		SFP+ 1X1 CAGE ASSEMBLY, PRESS-FIT PRESS-FIT, EMI SPRINGS	
		SIZE	CAGE CODE DRAWING NO
		A1	108-2364
		WEIGHT	114-13120
		Customer Drawing	Customer Drawing

STC TE Connectivity

SCALE 6:1 SHEET 1 OF 4 REV C.3

LOC		DIST		REVISIONS			
GP	00	P	LTN	DESCRIPTION	DATE	DMN	APVD
		-		SEE SHEET 1			

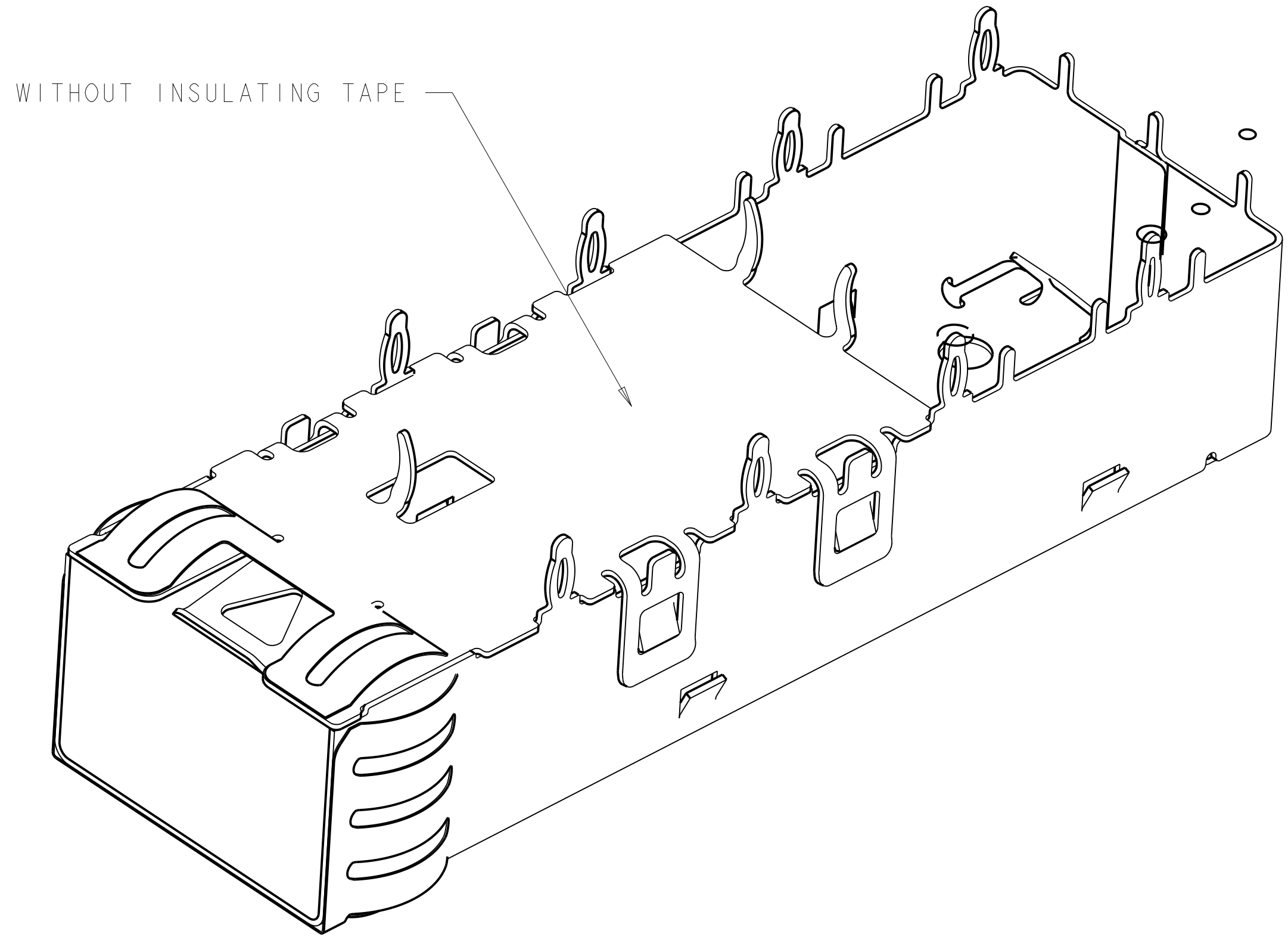

2007198-1,2,9 AS SHOWN WITHOUT INSULATING TAPE

WITH INSULATING TAPE

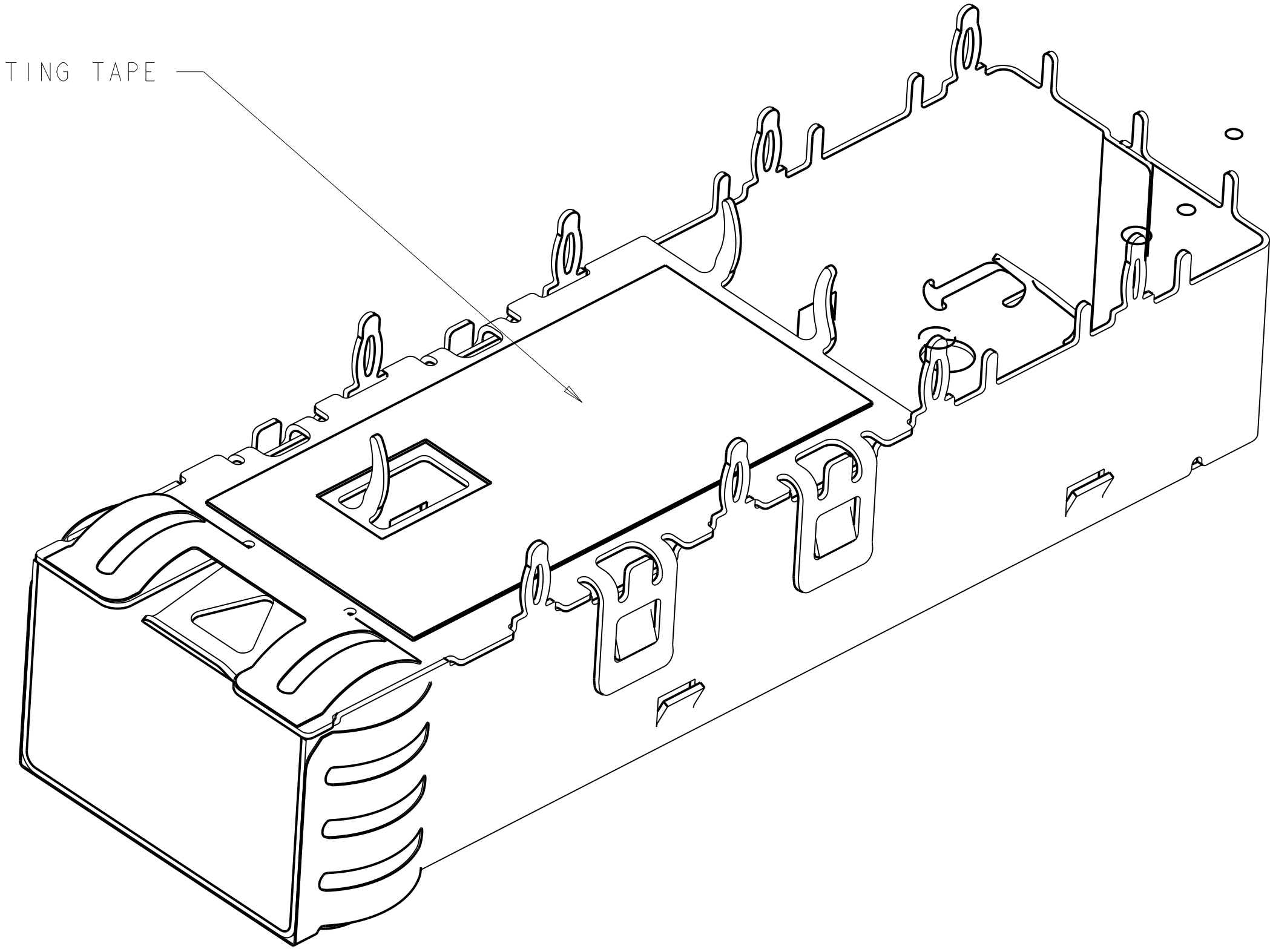

2007198-5 AS SHOWN WITH INSULATING TAPE

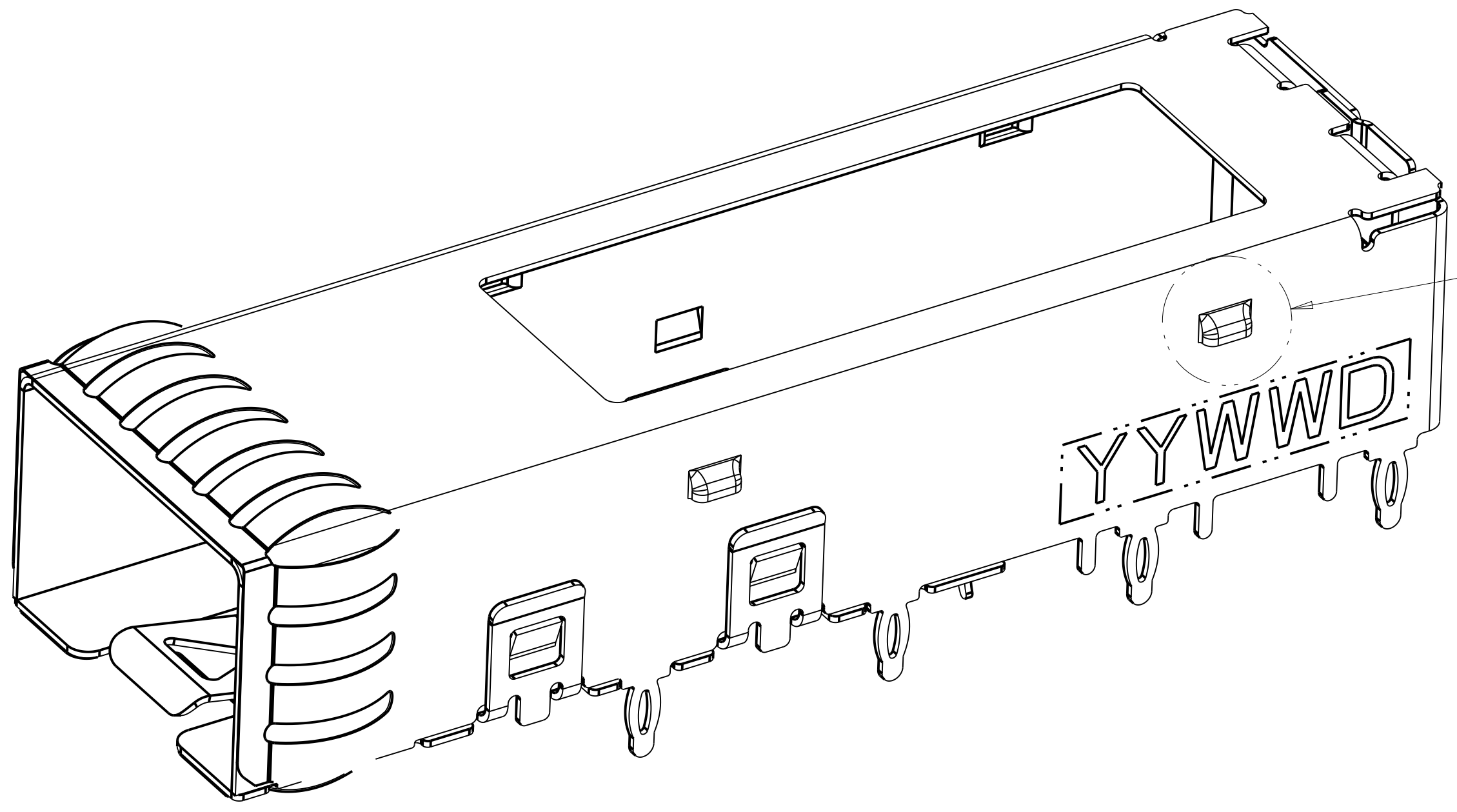

2007198-7  
 SAME AS 2007198-2 EXCEPT AS SHOWN  
 TOP VIEW

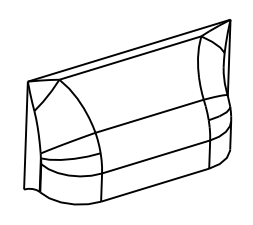

DETAIL C  
 SCALE 15:1

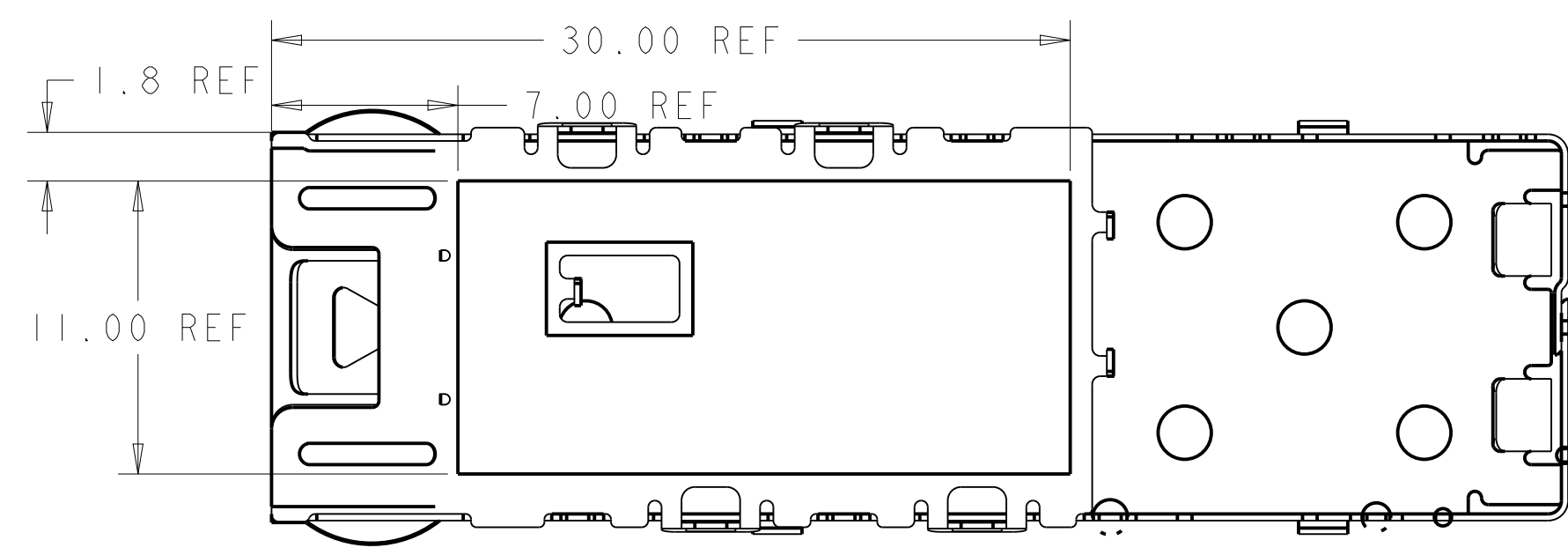

SCALE 4:1  
 2007198-5 AS SHOWN THE LOCATION OF THE TAPE

THIS DRAWING IS A CONTROLLED DOCUMENT.		DMN M. SCHMITT 07JUN07	<b>STE</b> TE Connectivity
DIMENSIONS: mm		CHK M. SCHMITT 07JUN07	
TOLERANCES UNLESS OTHERWISE SPECIFIED:		APVD B. WERTZ 07JUN07	NAME SFP+ IXI CAGE ASSEMBLY, PRESS-FIT PRESS-FIT, EMI SPRINGS
0 PLC ±0.1		PRODUCT SPEC	SIZE CAGE CODE DRAWING NO RESTRICTED TO
1 PLC ±0.1		108-2364	A1 00779C=2007198
2 PLC ±0.1		APPLICATION SPEC	SCALE 6:1 SHEET 2 OF 4 REV C.3
3 PLC ±0.05		114-13120	
4 PLC ±0.05		WEIGHT	
ANGLES ±0.05		Customer Drawing	
FINISH			

LOC	DIST	REV	DATE	BY	APPV
GP	00				

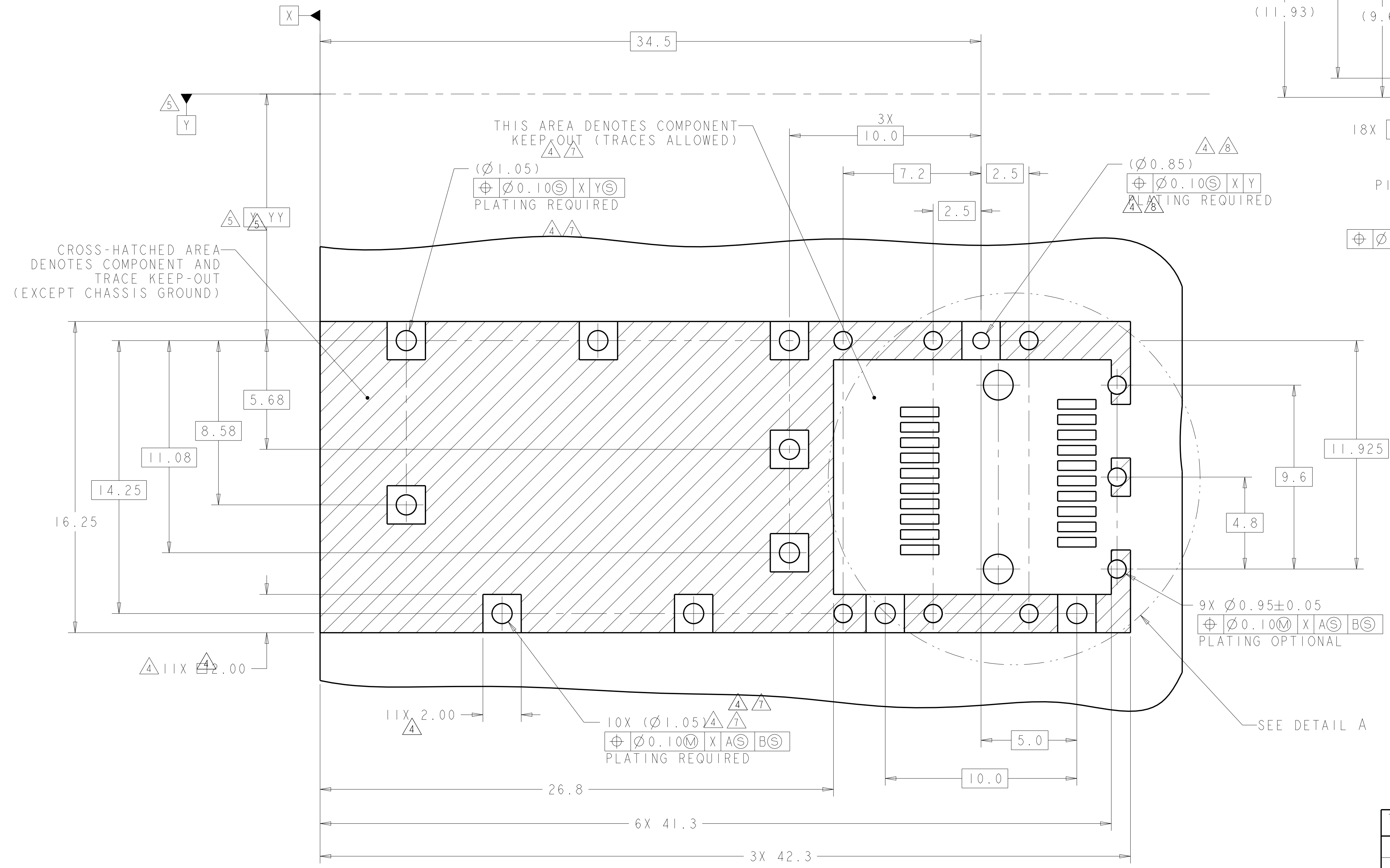
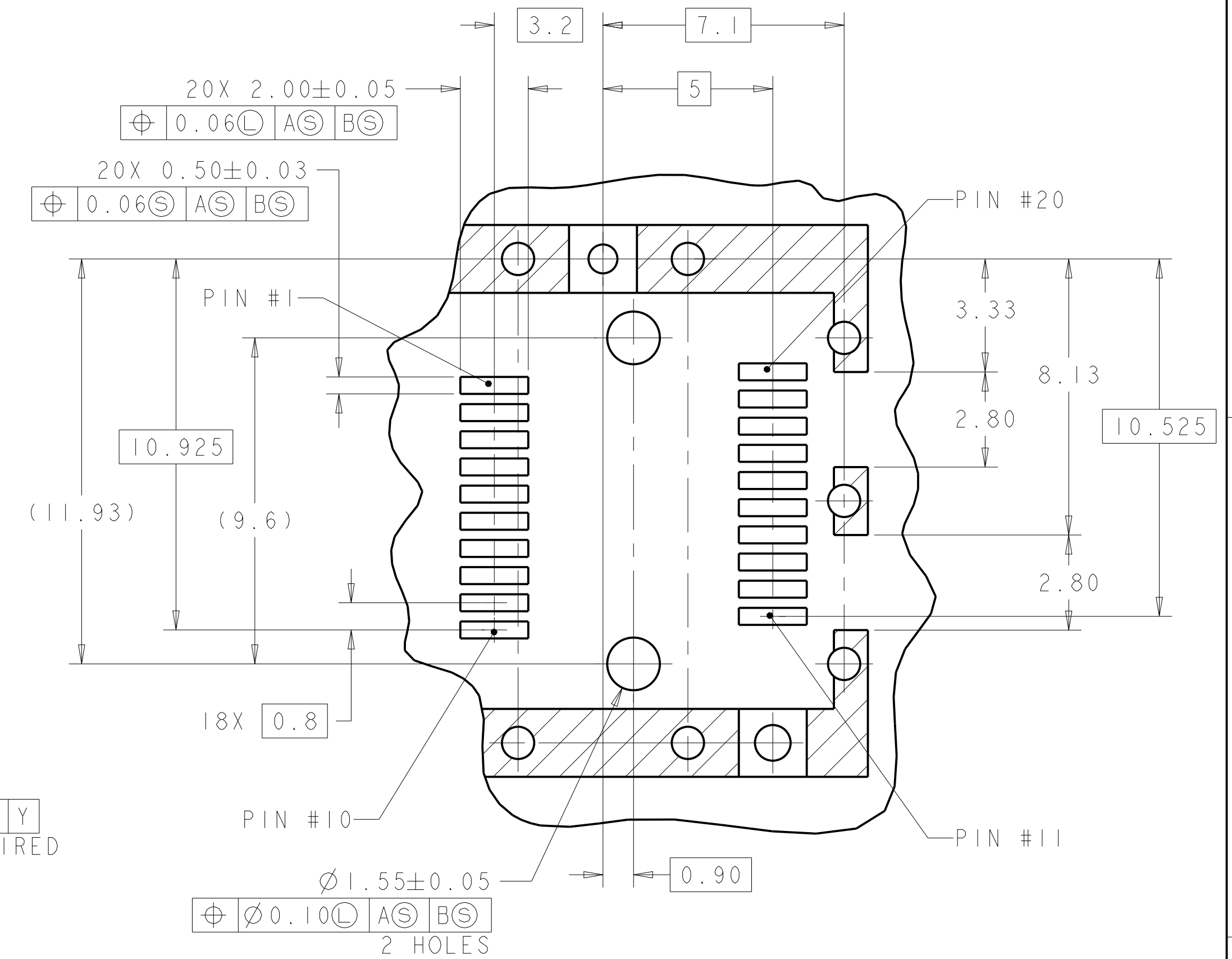
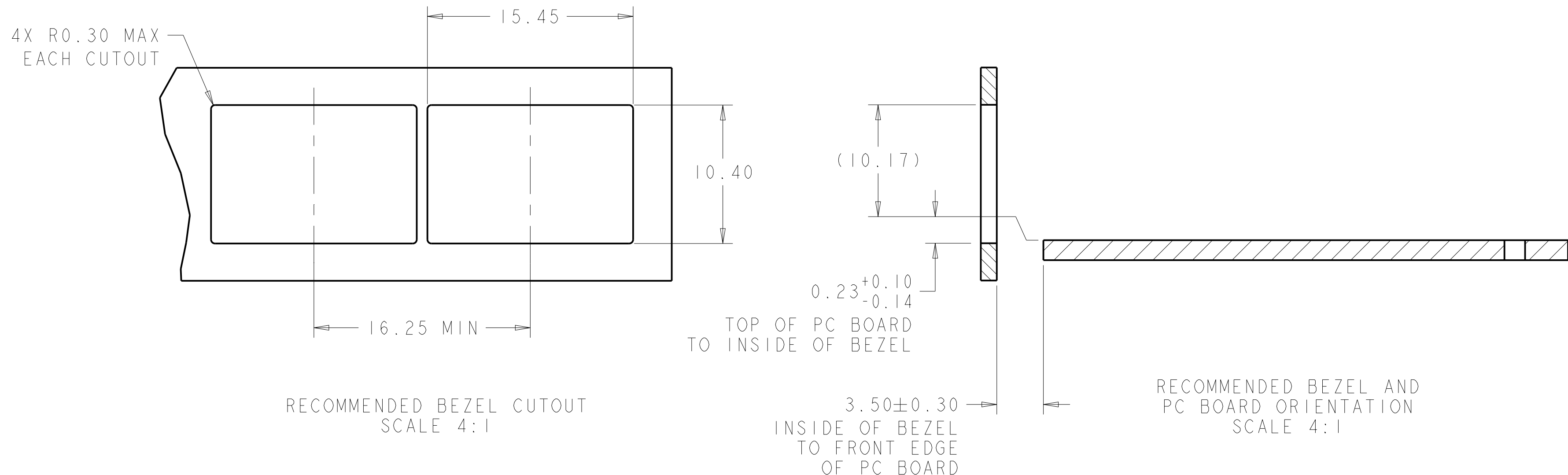

THIS DRAWING IS A CONTROLLED DOCUMENT.		OWN: M. SCHMITT 07JUN07	 TE Connectivity
DIMENSIONS: mm		CHK: M. SCHMITT 07JUN07	
TOLERANCES UNLESS OTHERWISE SPECIFIED:		APPV: B. WERTZ 07JUN07	
0 PLC ±0.1 1 PLC ±0.1 2 PLC ±0.1 3 PLC ±0.05 4 PLC ±0.05 ANGLES ±0.05		NAME: SFP+ 1X1 CAGE ASSEMBLY, PRESS-FIT PRESS-FIT, EMI SPRINGS PRODUCT SPEC: 108-2364 APPLICATION SPEC: 114-13120 WEIGHT: - Customer Drawing	
MATERIAL: FINISH: -		SIZE: A100779C=2007198	RESTRICTED TO: -
		SCALE: 6:1	SHEET 3 OF 4
		REV: C3	

LOC	DIST	REV	DATE	APP'D	REVISED
GP	00				
					SEE SHEET 1

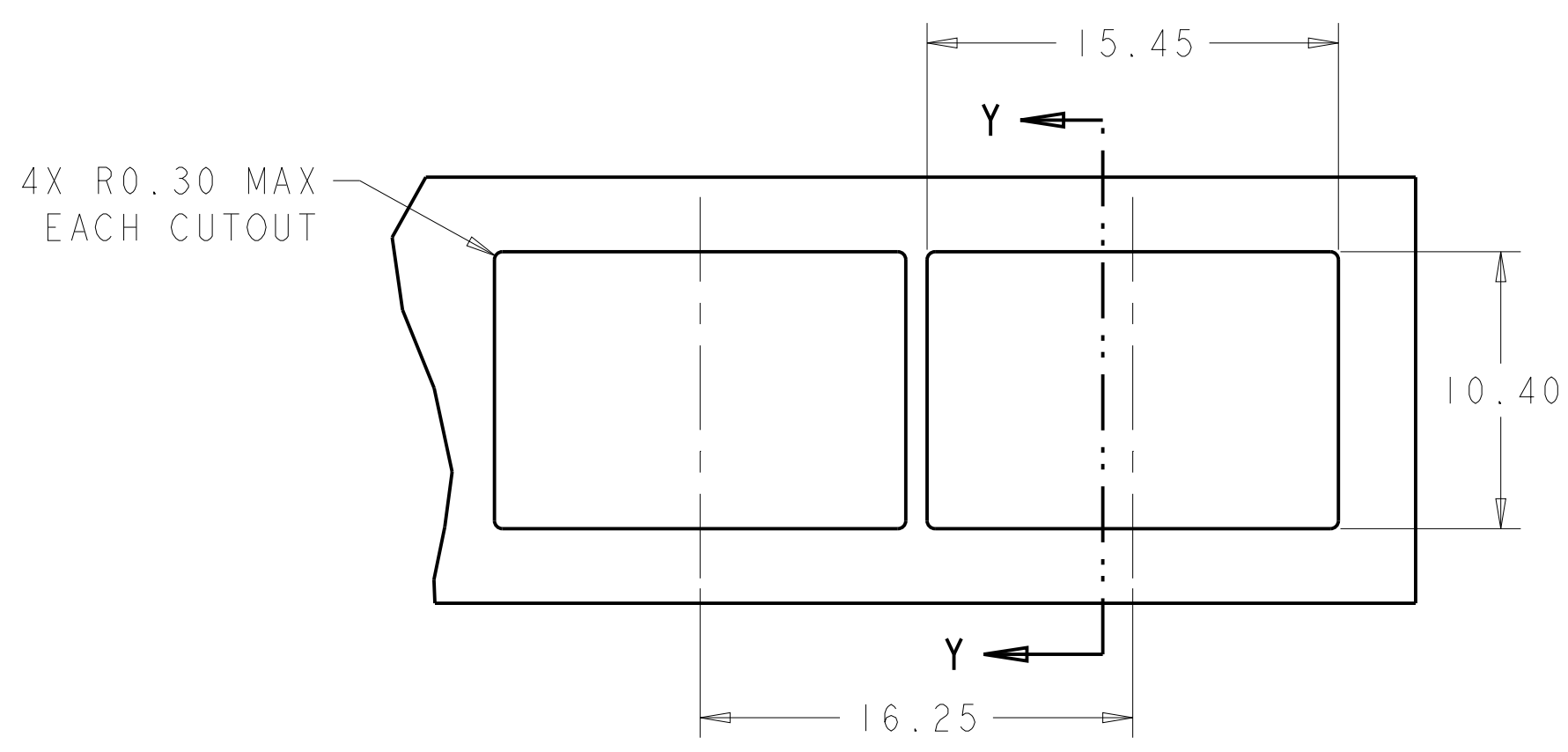

RECOMMENDED BEZEL CUTOUT  
SCALE 4:1

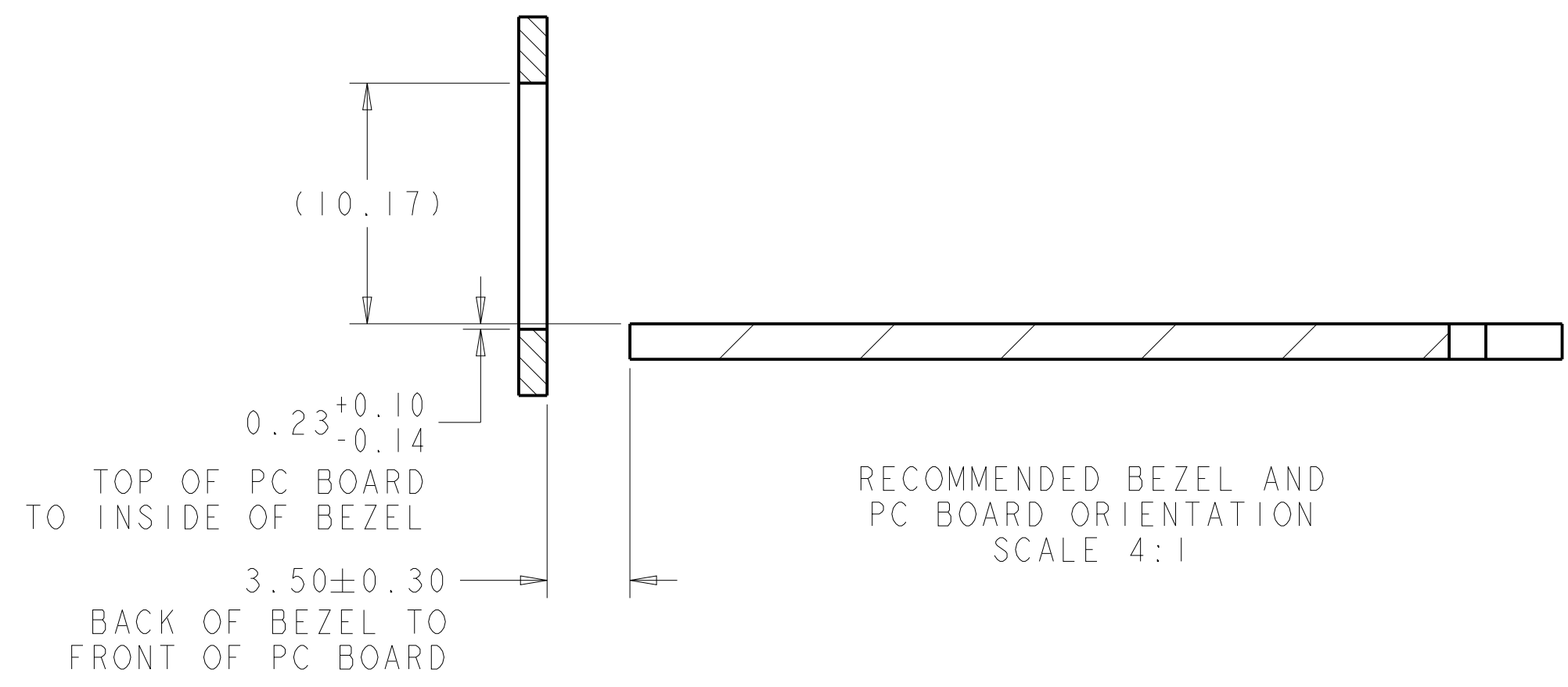

RECOMMENDED BEZEL AND  
PC BOARD ORIENTATION  
SCALE 4:1

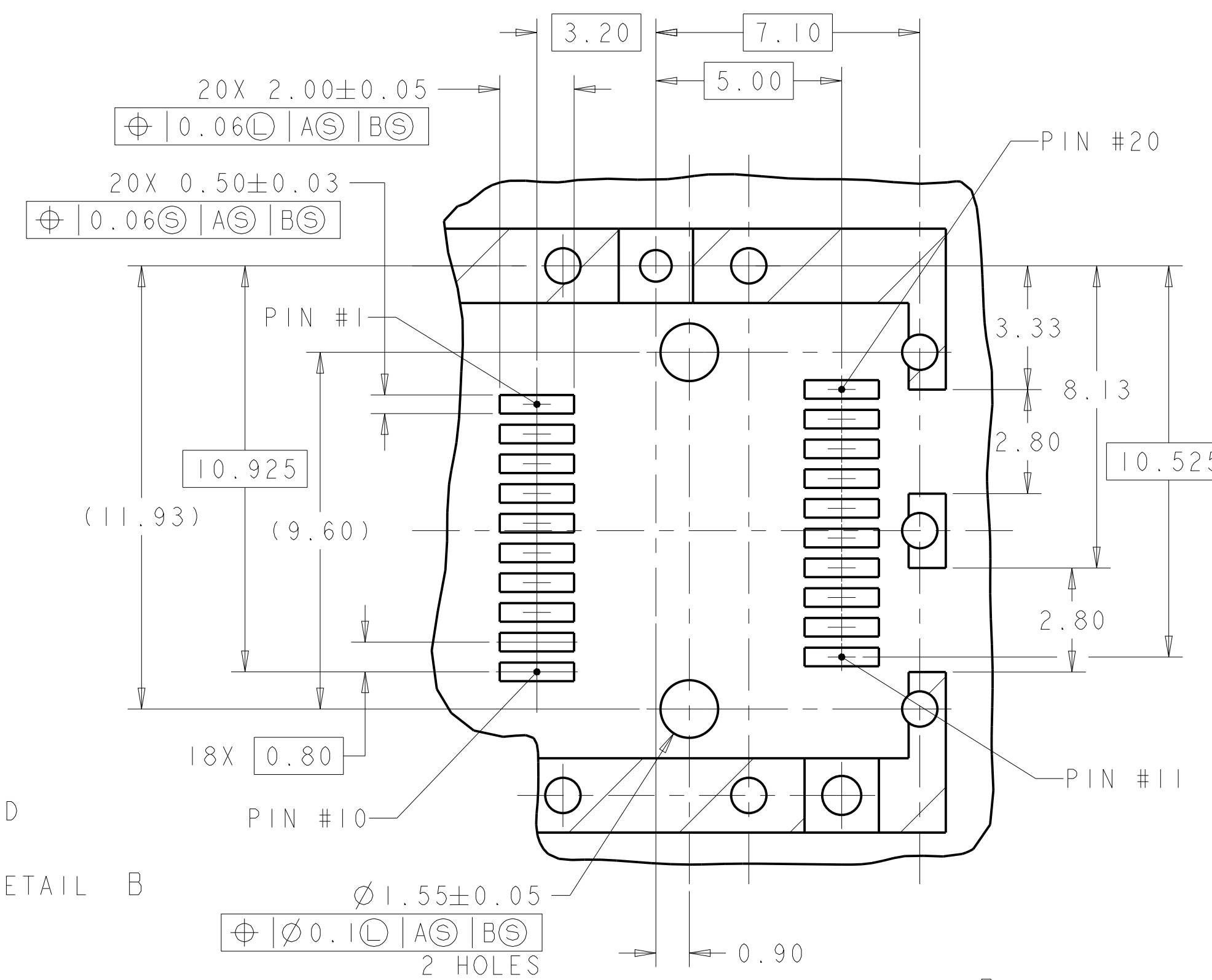

DETAIL B  
SCALE 8:1

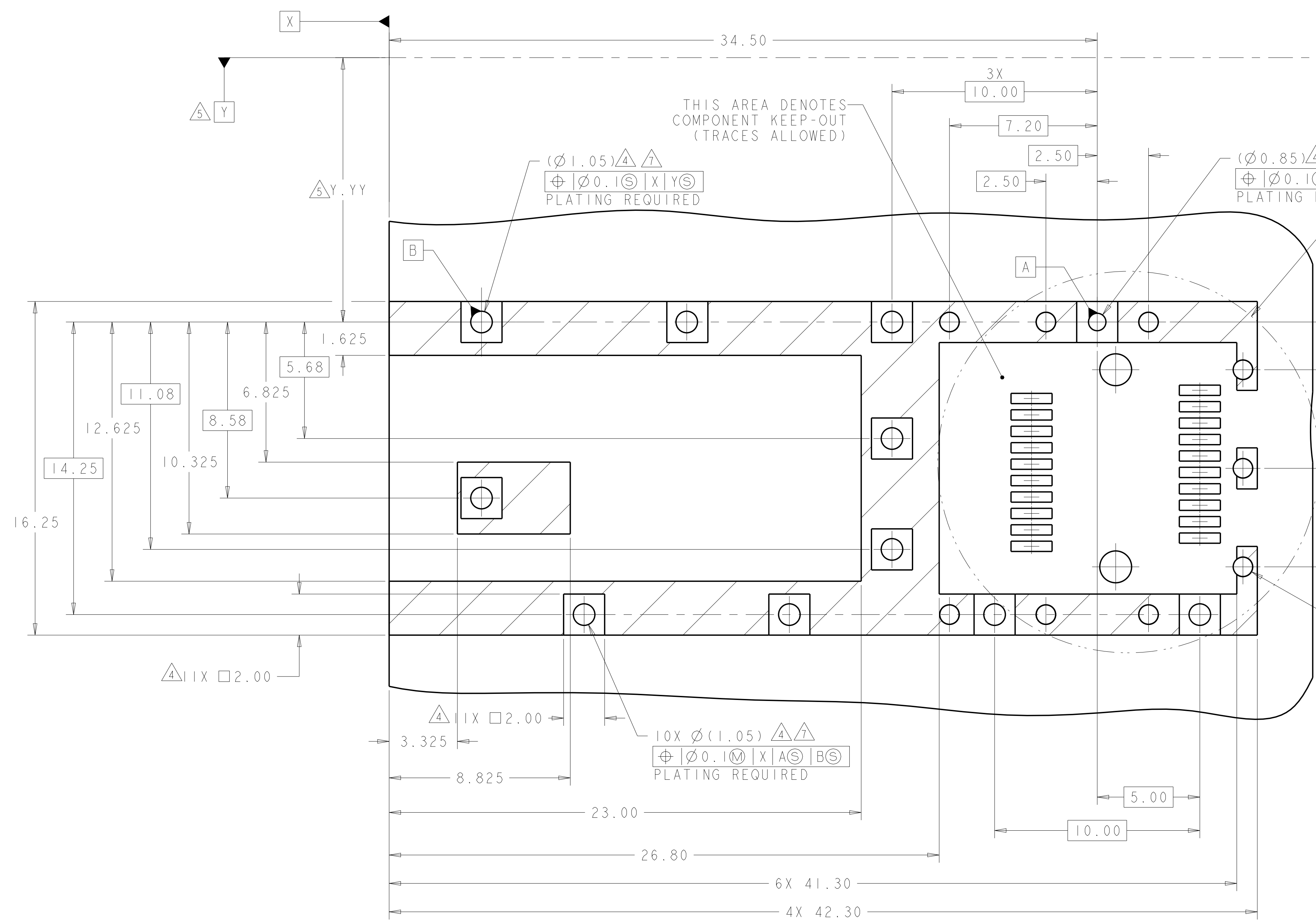

RECOMMENDED PCB LAYOUT FOR WITH  
INSULATING TAPE PART  
SCALE 8:1

THIS DRAWING IS A CONTROLLED DOCUMENT.		OWN: M. SCHMITT 07JUN07	TE Connectivity
DIMENSIONS: mm		CHK: M. SCHMITT 07JUN07	
TOLERANCES UNLESS OTHERWISE SPECIFIED:		APP'D: B. WERTZ 07JUN07	NAME: SFP+ IXI CAGE ASSEMBLY, PRESS-FIT WITH HEATSINK
0 PLC ±0.1		PRODUCT SPEC	108-2364
2 PLC ±0.1		APPLICATION SPEC	114-13120
3 PLC ±0.05		WEIGHT	
4 PLC ±0.05		FINISH	
ANGLES ±0.05			
MATERIAL		Customer Drawing	SCALE 6:1 SHEET 4 OF 4 REV C3