

THIS DRAWING IS UNPUBLISHED. RELEASED FOR PUBLICATION 20  
 © COPYRIGHT 20 ALL RIGHTS RESERVED.

| LOC |     | DIST          |           | REVISIONS |      |  |  |
|-----|-----|---------------|-----------|-----------|------|--|--|
| P   | LTR | DESCRIPTION   | DATE      | DWN       | APVD |  |  |
| C   |     | ECR-13-008068 | 03JUL2013 | TB        | DM   |  |  |
| D   |     | ECR-17-014255 | 20SEP2017 | GSK       | WG   |  |  |

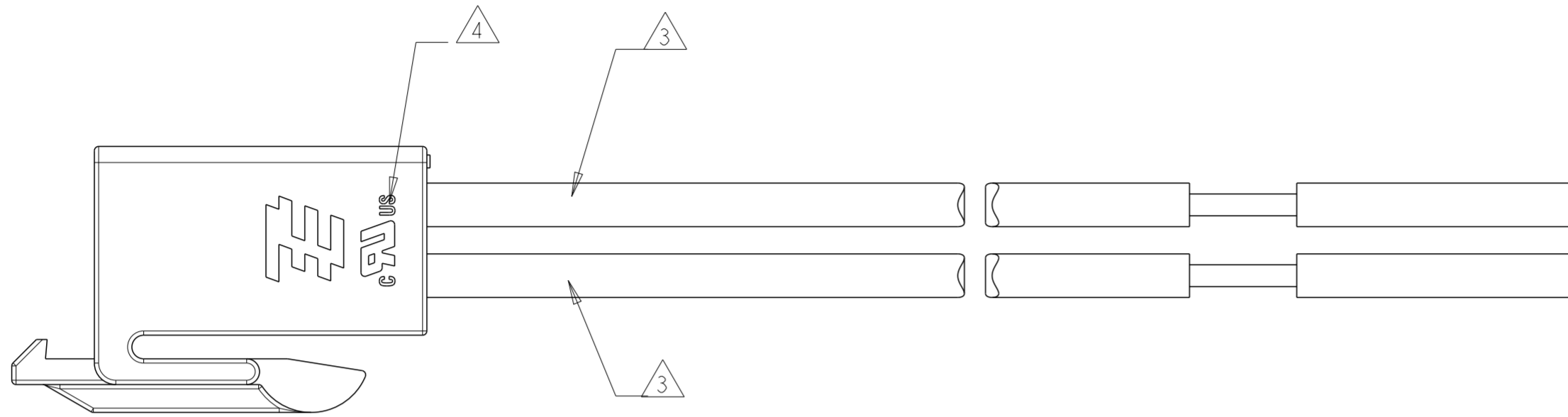

NOTES:

- 1 MATERIALS AND FINISH:  
 -HOUSING: PBT, COLOR: SEE TABLE  
 -CONTACTS: COPPER ALLOY, FINISH: PRE-TIN  
 -WIRE: 18 AWG, STRANDED, UL 1007 STYLE
- 2. MUST COMPLY WITH DIRECTIVE 2002/95/EC (ROHS)
- 3 REFER TO TABLE FOR WIRE COLOR
- 4 PENDING APPROVAL

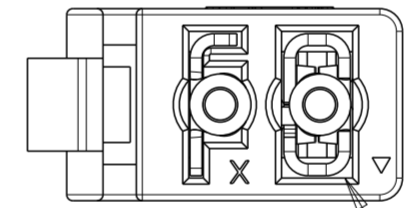
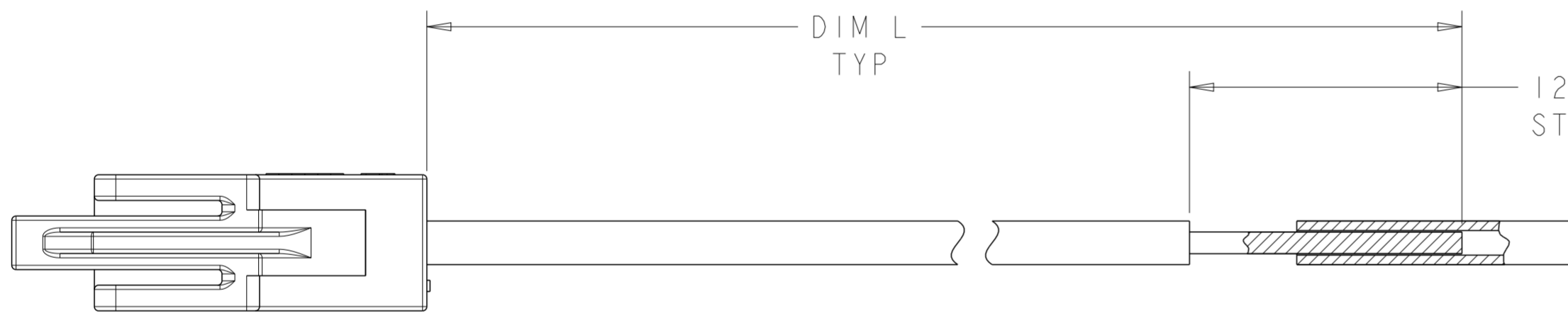

2058300-1 AND 2-2058300-0 SHOWN

|             |               |      |             |
|-------------|---------------|------|-------------|
| 101.6±3.0   | NATURAL       | 6    | 2-2058300-2 |
| 101.6±3.0   | NATURAL       | 4    | 2-2058300-1 |
| 101.6±3.0   | NATURAL       | 2    | 2-2058300-0 |
| 150±5.0     | NATURAL       | 6    | 1-2058300-4 |
| 101.6±3.0   | BLACK         | 6    | 1-2058300-3 |
| 101.6±3.0   | BLACK         | 4    | 1-2058300-2 |
| 101.6±3.0   | BLACK         | 2    | 1-2058300-1 |
| 457.2±10.0  | NATURAL       | 2    | 2058300-7   |
| 304.8±10.0  | NATURAL       | 2    | 2058300-6   |
| 152.4±5.0   | NATURAL       | 2    | 2058300-5   |
| 1000.0±15.0 | NATURAL       | 2    | 2058300-4   |
| 101.6±3.0   | NATURAL       | 6    | 2058300-3   |
| 101.6±3.0   | NATURAL       | 4    | 2058300-2   |
| 101.6±3.0   | NATURAL       | 2    | 2058300-1   |
| DIM L       | HOUSING COLOR | POSN | PART NO.    |

| WIRE COLOR 3 |       |        |        |       |                       |                       |                       |       |        |        |        |       |        |        |
|--------------|-------|--------|--------|-------|-----------------------|-----------------------|-----------------------|-------|--------|--------|--------|-------|--------|--------|
| 6            | -     | -      | WHITE  | -     | -                     | -                     | -                     | -     | -      | WHITE  | WHITE  | -     | -      | WHITE  |
| 5            | -     | -      | YELLOW | -     | -                     | -                     | -                     | -     | -      | YELLOW | YELLOW | -     | -      | YELLOW |
| 4            | -     | ORANGE | ORANGE | -     | -                     | -                     | -                     | -     | ORANGE | ORANGE | ORANGE | -     | ORANGE | ORANGE |
| 3            | -     | BLUE   | BLUE   | -     | -                     | -                     | -                     | -     | BLUE   | BLUE   | BLUE   | -     | BLUE   | BLUE   |
| 2            | RED   | RED    | RED    | RED   | WHITE WITH RED STRIPE | WHITE WITH RED STRIPE | WHITE WITH RED STRIPE | RED   | RED    | RED    | RED    | RED   | RED    | RED    |
| 1            | BLACK | BLACK  | BLACK  | BLACK | WHITE                 | WHITE                 | WHITE                 | BLACK | BLACK  | BLACK  | BLACK  | BLACK | BLACK  | BLACK  |
| CKT          | -1    | -2     | -3     | -4    | -5                    | -6                    | -7                    | 1-1   | 1-2    | 1-3    | 1-4    | 2-0   | 2-1    | 2-2    |
| PART NUMBER  |       |        |        |       |                       |                       |                       |       |        |        |        |       |        |        |

THIS DRAWING IS A CONTROLLED DOCUMENT. DWN R BROWN 02SPR2009  
 CHK R NARANG 02APR2009

**STE** TE Connectivity

CABLE ASSEMBLY, WIRE TO BOARD CONNECTOR

SIZE: A2 CAGE CODE: 00779 DRAWING NO: C-2058300 RESTRICTED TO: -

MATERIAL: 1 - FINISH: 1 - WEIGHT: - SCALE: 4:1 SHEET 1 OF 1 REV D

# Mouser Electronics

Authorized Distributor

Click to View Pricing, Inventory, Delivery & Lifecycle Information:

[TE Connectivity:](#)

[1-2058300-1](#)