



# TAI-SAW TECHNOLOGY CO., LTD.

No. 3, Industrial 2nd Rd., Ping-Chen Industrial District,  
Taoyuan, 324, Taiwan, R.O.C.

TEL: 886-3-4690038 FAX: 886-3-4697532

E-mail: [tstsales@mail.taisaw.com](mailto:tstsales@mail.taisaw.com) Web: [www.taisaw.com](http://www.taisaw.com)

## Product Specifications Approval Sheet

Product Name: SAW Filter 1586.36 MHz (BW 40MHz) SMD 1.4X1.1 mm

TST Parts No.: TA1560A

Customer Parts No.: \_\_\_\_\_

Company: _____
Division: _____
Approved by : _____
Date: _____

Checked by: \_\_\_\_\_ Michael Yang *Michael 11/28/12*

Approval by: \_\_\_\_\_ Francis Chen *[Signature]*

Date: \_\_\_\_\_ 2012/11/28

1. Customer signed back is required before TST can proceed with sample build and receive orders.
2. Orders received without customer signed back will be regarded as agreement on the specifications.
3. Any specifications changes must be approved upon by both parties and a new revision of specifications shall be released to reflect the changes



# TAI-SAW TECHNOLOGY CO., LTD.

No. 3, Industrial 2nd Rd., Ping-Chen Industrial District,  
Taoyuan, 324, Taiwan, R.O.C.

TEL: 886-3-4690038 FAX: 886-3-4697532

E-mail: [tstsales@mail.taisaw.com](mailto:tstsales@mail.taisaw.com) Web: [www.taisaw.com](http://www.taisaw.com)

## SAW Filter 1586.36MHz

MODEL NO.:TA1560A

REV. NO.:1.0

### A. MAXIMUM RATING:

1. Input Power Level: 13 dBm
2. DC Voltage : 0V
3. Operating Temperature: -35°C to +85°C
4. Storage Temperature: -40°C to +85°C

RoHS Compliant  
Lead free  
Lead-free soldering

Electrostatic Sensitive Device (ESD)

### B. ELECTRICAL CHARACTERISTICS:

Terminating source impedance (single) :  $Z_s = 50$

Terminating load impedance(single) :  $Z_L = 50$

Item	Unit	25±2	Type.	-30 ~ +85
<b>Center Frequency</b> <b>Fc</b>	MHz	-	1590	-
<b>Insertion Loss</b> (1574.42~1576.42 MHz) <b>IL</b>	dB	1.4max	1.2	1.6max
<b>Insertion Loss</b> (1597.55~1605.89 MHz) <b>IL</b>	dB	1.9max	1.8	2.1max
<b>VSWR</b> (1574.42~1576.42 MHz)		1.9max	1.5	2.1max
<b>VSWR</b> (1597.55~1605.89 MHz)		1.9max	1.5	2.1max
<b>Amplitude ripple</b> (1574.42~1605.89 MHz)	dB	0.7max	0.5	1.0max
<b>Attenuation</b>				
1 ~ 960 MHz	dB	32min	35	32min
1427 ~ 1463 MHz	dB	38min	45	38min
1710 ~ 1785 MHz	dB	39min	42	38min
1850 ~ 2570 MHz	dB	35min	40	35min
Package size	mm	SMD 1.4x1.1		

**C.OUTLINE DRAWING:**

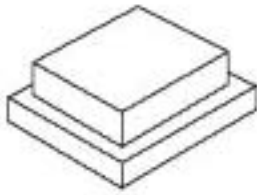

**Electrical Connections**

Connection	Terminals
Input	A
Output	D
Ground	B, C, E

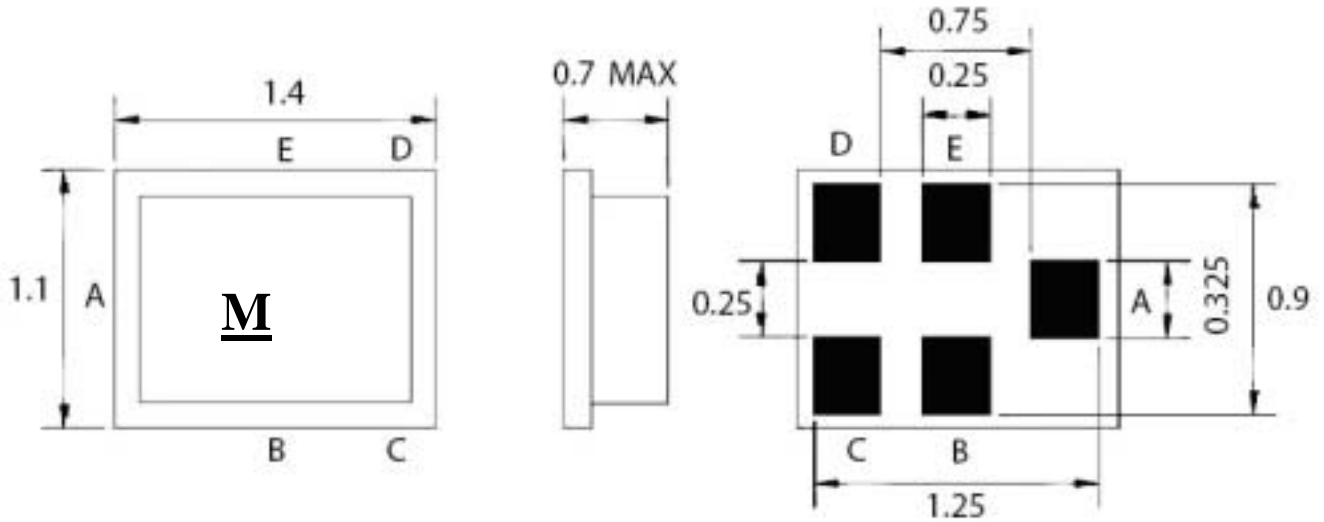

Δ: Data Code

**D. MEASUREMENT CIRCUIT:**

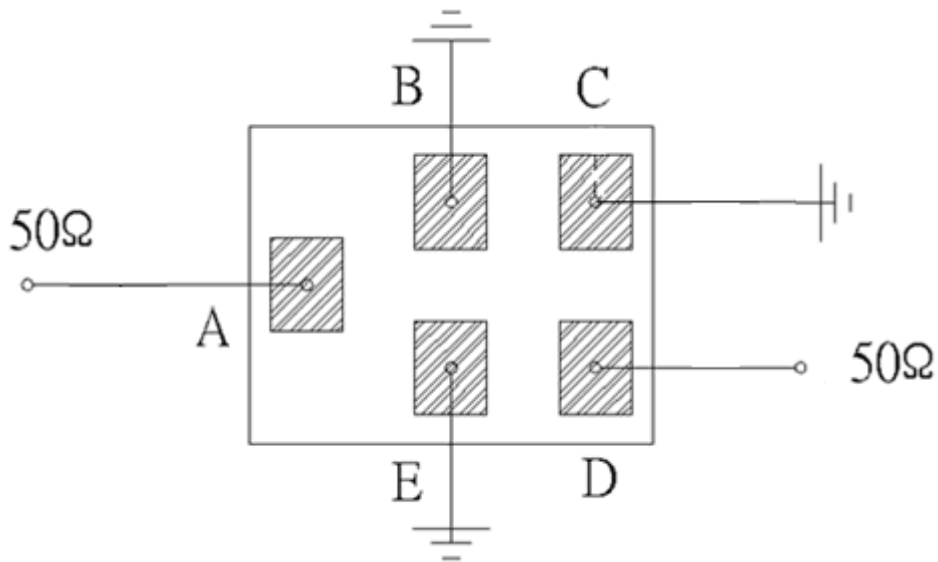

**E. Frequency Characteristics :**  
**S21 response: (span 300MHz)**

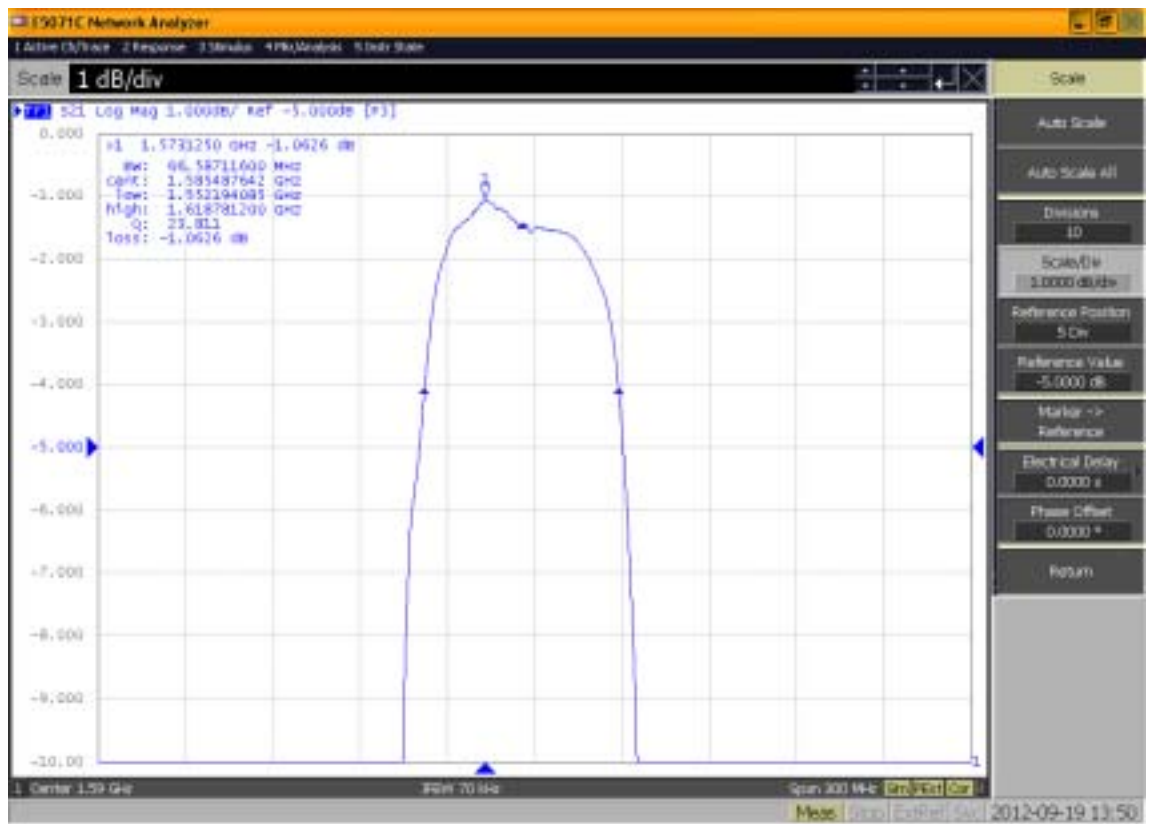
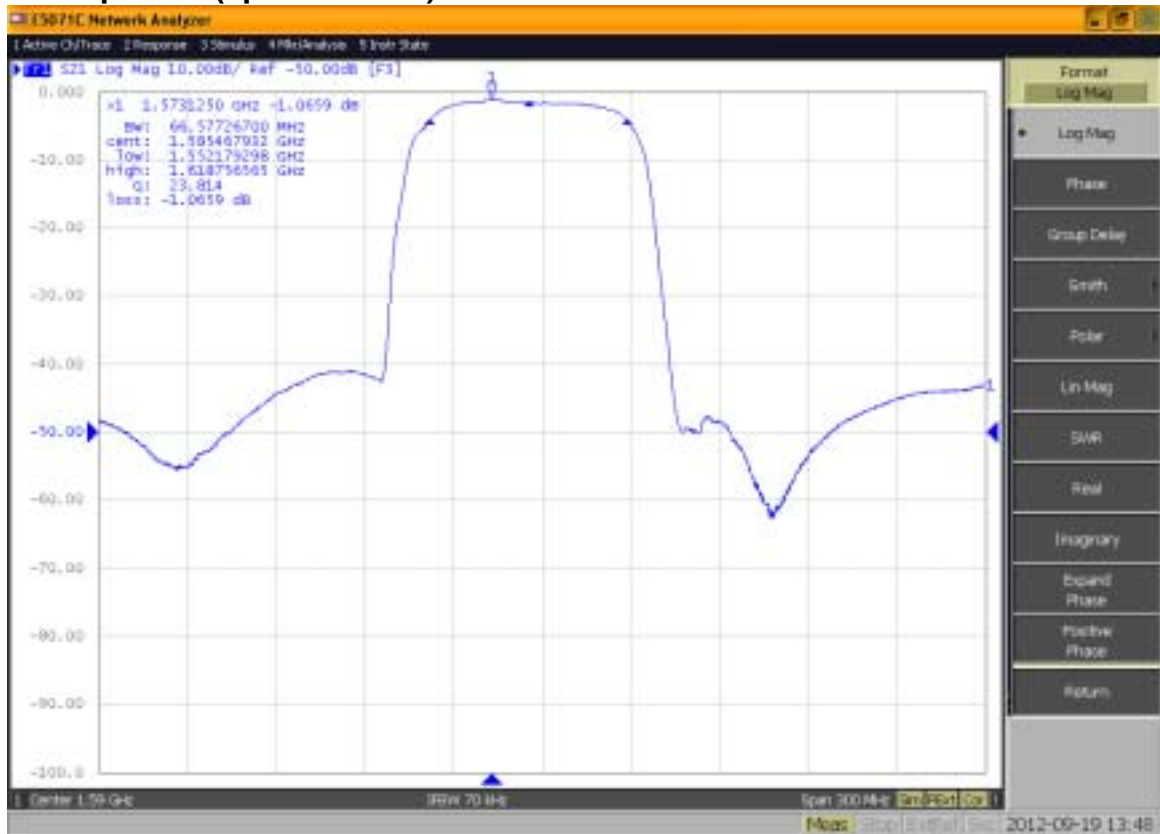

**VSWR response: (span 300MHz)**



**S21 response: (span 8.5GHz)**



S11&S22 : (span 300MHz)

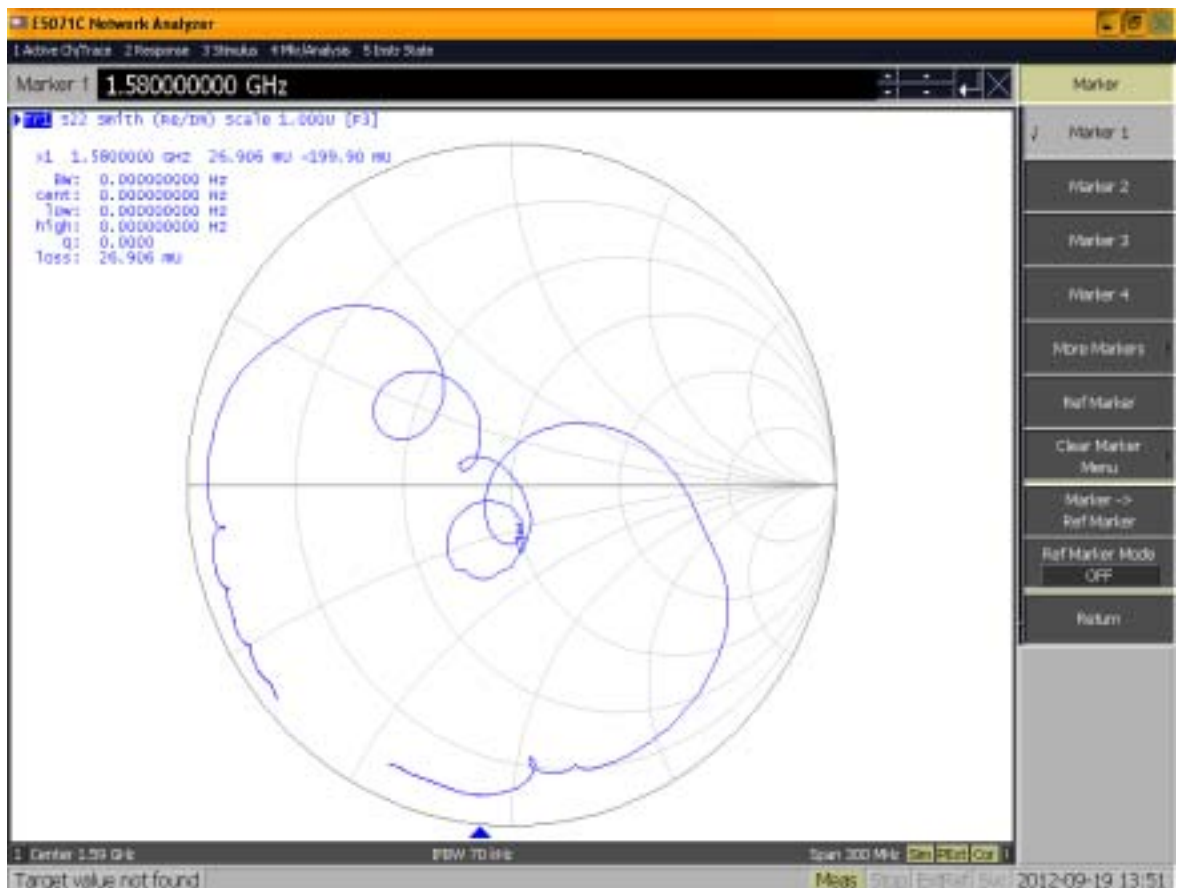
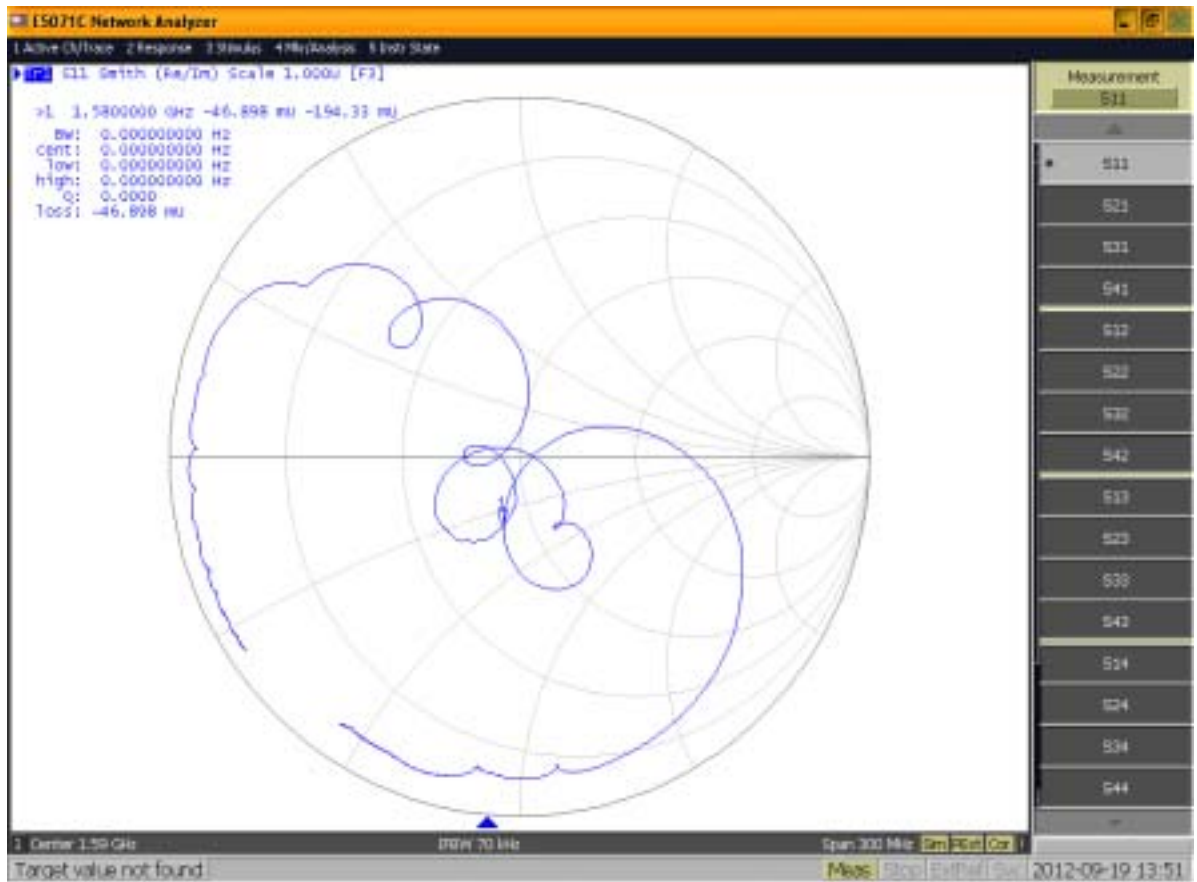

**F. PACKING:**

**1. REEL DIMENSION**

(Please refer to FR-75D10 for packing quantity)

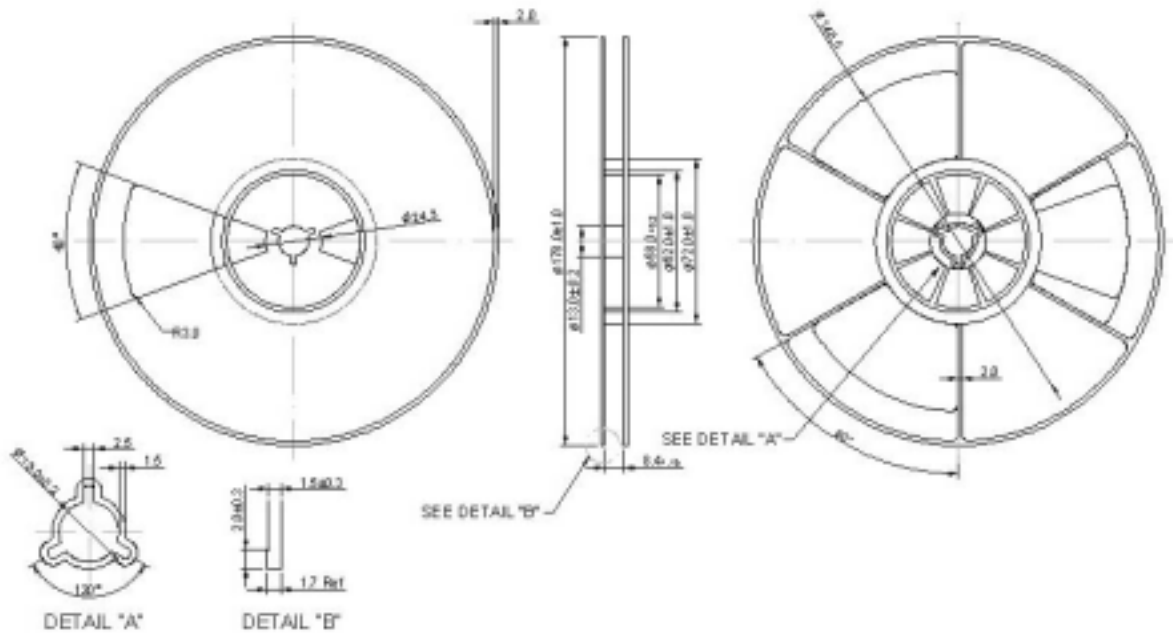

**2. TAPE DIMENSION**

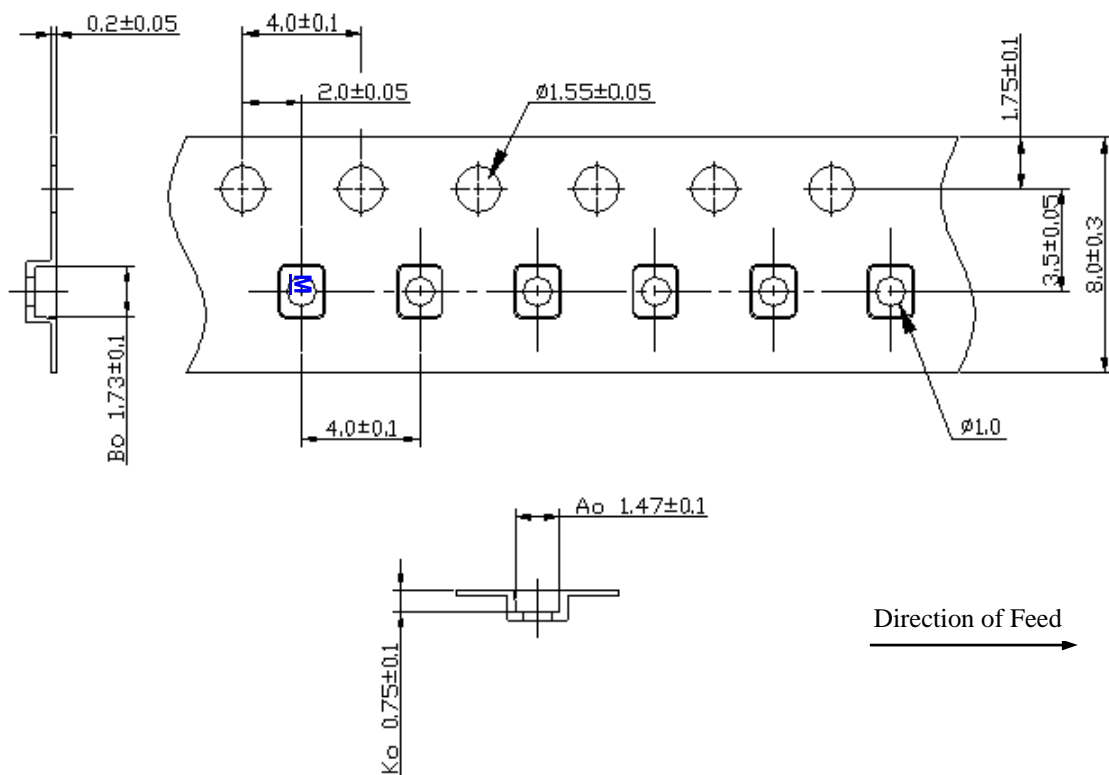

**F. RECOMMENDED REFLOW PROFILE :**

