

MJE13008
MJE13009

SILICON NPN TRANSISTORS

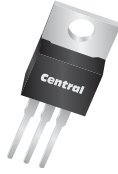

TO-220 CASE



www.centrasemi.com

DESCRIPTION:

The CENTRAL SEMICONDUCTOR MJE13008 and MJE13009 are silicon NPN transistors designed for high voltage, high speed switching applications.

MARKING: FULL PART NUMBER

MAXIMUM RATINGS: ($T_C=25^\circ\text{C}$)

Collector-Emitter Voltage
Collector-Emitter Voltage
Emitter-Base Voltage
Continuous Collector Current
Peak Collector Current
Continuous Base Current
Power Dissipation
Operating and Storage Junction Temperature
Thermal Resistance

SYMBOL	MJE13008	MJE13009	UNITS
V_{CEO}	300	400	V
V_{CEV}	600	700	V
V_{EBO}		9.0	V
I_C		12	A
I_{CM}		24	A
I_B		6.0	A
P_D		100	W
T_J, T_{stg}		-65 to +150	$^\circ\text{C}$
θ_{JC}		1.25	$^\circ\text{C/W}$

ELECTRICAL CHARACTERISTICS: ($T_C=25^\circ\text{C}$ unless otherwise noted)

SYMBOL	TEST CONDITIONS	MIN	TYP	MAX	UNITS
I_{CEV}	$V_{CE}=\text{Rated } V_{CEV}, V_{BE(OFF)}=1.5\text{V}$			1.0	mA
I_{CEV}	$V_{CE}=\text{Rated } V_{CEV}, V_{BE(OFF)}=1.5\text{V}, T_C=100^\circ\text{C}$			5.0	mA
I_{EBO}	$V_{EB}=9.0\text{V}$			1.0	mA
BV_{CEO}	$I_C=10\text{mA (MJE13008)}$	300			V
BV_{CEO}	$I_C=10\text{mA (MJE13009)}$	400			V
$V_{CE(SAT)}$	$I_C=5.0\text{A}, I_B=1.0\text{A}$			1.0	V
$V_{CE(SAT)}$	$I_C=8.0\text{A}, I_B=1.6\text{A}$			1.5	V
$V_{CE(SAT)}$	$I_C=12\text{A}, I_B=3.0\text{A}$			3.0	V
$V_{BE(SAT)}$	$I_C=5.0\text{A}, I_B=1.0\text{A}$			1.2	V
$V_{BE(SAT)}$	$I_C=8.0\text{A}, I_B=1.6\text{A}$			1.6	V
h_{FE}	$V_{CE}=5.0\text{V}, I_C=5.0\text{A}$	8.0		40	
h_{FE}	$V_{CE}=5.0\text{V}, I_C=8.0\text{A}$	6.0		30	
f_T	$V_{CE}=10\text{V}, I_C=500\text{mA}, f=1.0\text{MHz}$	4.0			MHz
C_{ob}	$V_{CB}=10\text{V}, I_E=0, f=100\text{kHz}$		180		pF
t_d	$V_{CC}=125\text{V}, I_C=8.0\text{A}, I_{B1}=I_{B2}=1.6\text{A}$ $t_p=25\mu\text{s}, \text{Duty Cycle} \leq 1.0\%$			0.1	μs
t_r				1.0	μs
t_s				3.0	μs
t_f				0.7	μs

R1 (12-February 2015)

MJE13008
MJE13009

SILICON NPN TRANSISTORS



TO-220 CASE - MECHANICAL OUTLINE

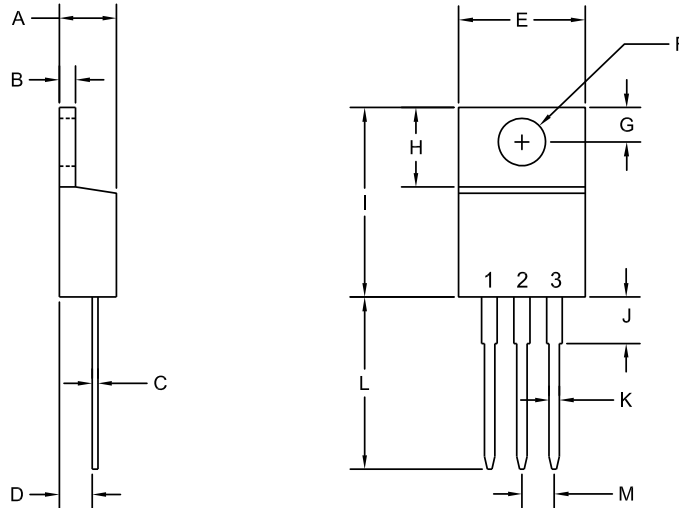

R2

LEAD CODE:

- 1) Base
- 2) Collector
- 3) Emitter
- Tab is common to pin 2

MARKING:

FULL PART NUMBER

DIMENSIONS				
SYMBOL	INCHES		MILLIMETERS	
	MIN	MAX	MIN	MAX
A	0.170	0.190	4.31	4.82
B	0.045	0.055	1.15	1.39
C	0.013	0.026	0.33	0.65
D	0.083	0.107	2.10	2.72
E	0.394	0.417	10.01	10.60
F (DIA)	0.140	0.157	3.55	4.00
G	0.100	0.118	2.54	3.00
H	0.230	0.270	5.85	6.85
I	0.560	0.625	14.23	15.87
J	-	0.250	-	6.35
K	0.025	0.038	0.64	0.96
L	0.500	0.579	12.70	14.70
M	0.090	0.110	2.29	2.79

TO-220 (REV: R2)

R1 (12-February 2015)

MJE13008
MJE13009

SILICON NPN TRANSISTORS



SERVICES

- Bonded Inventory
- Custom Electrical Screening
- Custom Electrical Characteristic Curves
- SPICE Models
- Custom Packaging
- Package Base Options
- Custom Device Development/ Multi Discrete Modules (MDM™)
- Bare Die Available for Hybrid Applications

LIMITATIONS AND DAMAGES DISCLAIMER: In no event shall Central be liable for any collateral, indirect, punitive, incidental, consequential, or exemplary damages in connection with or arising out of a purchase order or contract or the use of products provided hereunder, regardless of whether Central has been advised of the possibility of such damages. Excluded damages shall include, but not be restricted to: cost of removal or reinstallation, rework, ancillary costs to the procurement of substitute products, loss of profits, loss of savings, loss of use, loss of data, or business interruption. No claim, suit, or action shall be brought against Central more than two (2) years after the related cause of action has occurred.

In no event shall Central's aggregate liability from any warranty, indemnity, or other obligation arising out of or in connection with a purchase order or contract, or any use of any Central product provided hereunder, exceed the total amount paid to Central for the specific products sold under a purchase order or contract with respect to which losses or damages are claimed. The existence of more than one (1) claim against the specific products sold to Buyer under a purchase order or contract shall not enlarge or extend this limit.

Buyer understands and agrees that the foregoing liability limitations are essential elements of a purchase order or contract and that in the absence of such limitations, the material and economic terms of the purchase order or contract would be substantially different.

R1 (12-February 2015)