

TOP VIEW

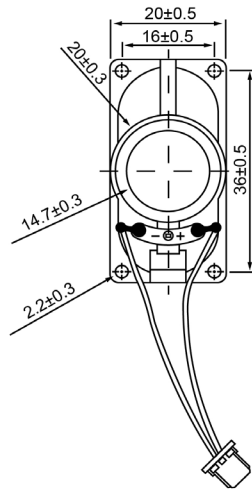

SIDE VIEW

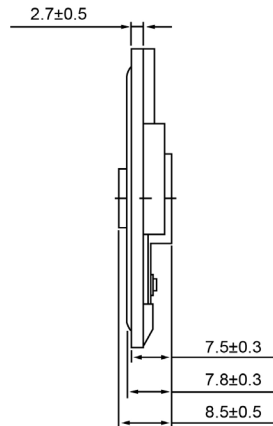

BOTTOM VIEW

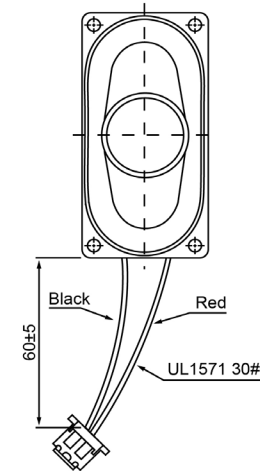

Specifications

Description	Value	Unit
Shape	Rectangle	
Resonant Frequency	900	(Hz)
Frequency Range	900 ~ 20,000	(Hz)
SPL @ 10cm	90	(dBA)
Impedance	8	(Ohm)
Cone Material	Cloth	
Nominal Power	1	(W)
Max Power	1.5	(W)
Mount Type	Frame Mount	
Operating Temperature	-25 ~ +80	°C
Storage Temperature	-25 ~ +80	°C
Weight	6.5	(g)

Notes

- 1) All dimensions are in mm unless otherwise noted
- 2) All parts meet RoHS



Revision History

Version	Description			Date	Approved
1	Released from Engineering			1/27/2014	J.S

High Temp Dynamic Speaker

SC400908-2