

RECOMMENDED P.C.B. LAYOUT

SCALE 4:1

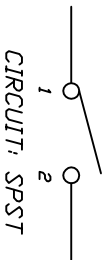

- NOTES:
1. ALL DIMENSIONS IN MM [INCH]
  2. GENERAL TOLERANCE: X.X=±0.4  
X.XX=±0.25
  3. TERM. NOS. FOR REFERENCE ONLY.
  4. RATINGS: 12VDC, 50mA
  5. OPERATING FORCE: 100±50gf
  6. TRAVEL: 0.25±0.1mm
  7. CONTACT RESISTANCE: 100 Milli Ω Max.
  8. DIELECTRIC STRENGTH: 250V RMS min.
  9. INSULATION RESISTANCE: 100 Mega Ω min.
  10. ELECTRICAL LIFE: 100,000 CYCLES min.
  11. DESIGNATE MAJOR FEATURE:
  12. HOUSING COLOR: BLACK
  13. 2002/95/EC (ROHS) COMPLIANT

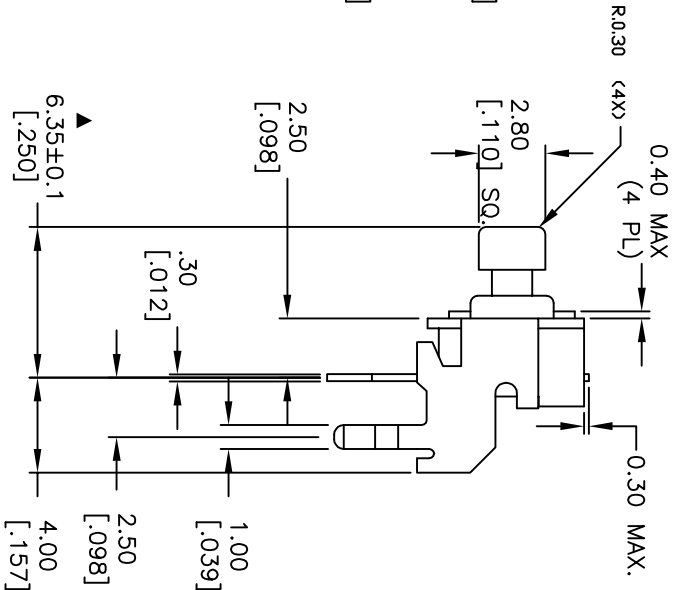
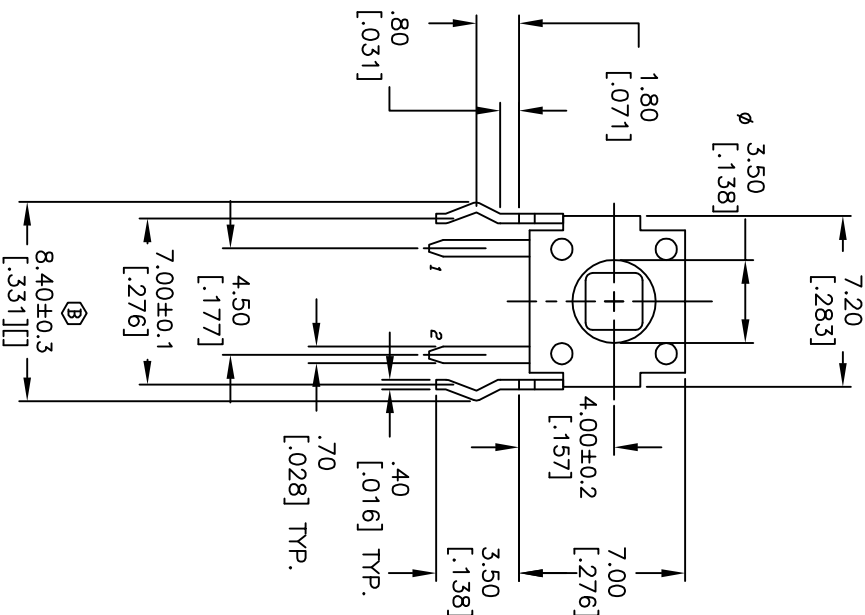

REV. A		ECN NO. 12357	ADD NOTCH	DATE 9/23/02	CHKD CB	TITLE		SCALE 3:1		DATE 1/11/10	DR BLR	DWG P010209	REV B
REV. B		ECN NO. 18742	LEG TOLERANCE WAS +/- 0.1	DATE 1/11/10	CHKD BLR	TITLE		SCALE 3:1		DATE 1/11/10	DR BLR	DWG P010209	REV B
THE INFORMATION CONTAINED IN THIS DOCUMENT IS PROPRIETARY TO E-SWITCH AND IS NOT TO BE COPIED OR TRANSMITTED													
TL1105JA F100 Q (STD BRACKET)													
E-SWITCH® LAMB INDUSTRIES®													