

SRH2-C Panel mount or 35mm Din Rail (EN50022)



Characteristics

Ambient temperature	-40 to 70 °C
Rated voltage	300VAC
Rated current	15A (Per pole)
Insulation voltage	> 5KV
Protection degree	IP20
Socket material	Self-extinguishing-PA66+GF (V0)
Contacts spring material	QSn6.5-0.1
Hold down spring	Steel
Stew Torque	1.0Nm
Wire Strip length	7mm



Mounting dimension

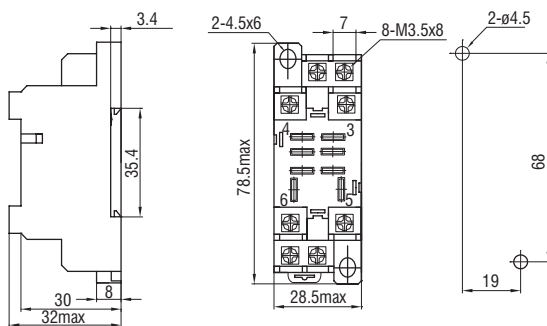

Inter connection

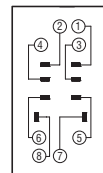

Retainer dimension

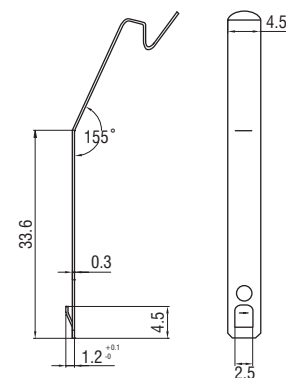

SRN4-C Panel mount or 35mm Din Rail (EN50022)

Characteristics

Ambient temperature	-40 to 70 °C
Rated voltage	300VAC
Rated current	12A (Per pole)
Insulation voltage	> 5KV
Protection degree	IP20
Socket material	Self-extinguishing-PA66+GF (V0)
Contacts spring material	QSn6.5-0.1
Stew Torque	0.6Nm
Wire strip	7mm



Mounting dimension

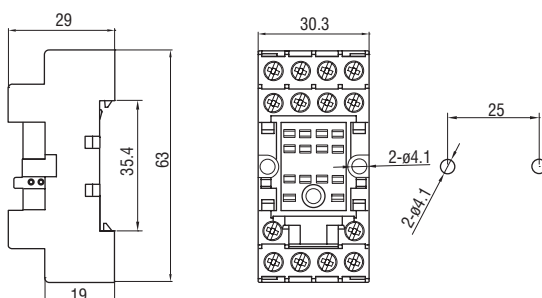

Inter connection

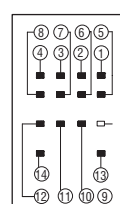

SRR8 Panel mount or 35mm Din Rail (EN50022)



Characteristics

Ambient temperature	-40 to 70 °C
Rated voltage	300VAC
Rated current	15A (Per pole)
Insulation voltage	>5KV
Protection degree	IP20
Socket material	Self-extinguishing-PA66+GF (V0)
Contacts spring material	QSn6.5-0.1
Hold down spring	No
Stew Torque	0.6Nm
Wire Strip length	7mm



Mounting dimension

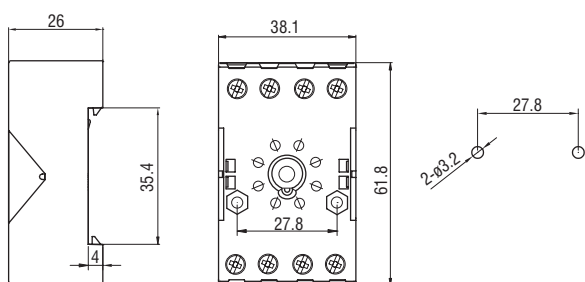

Inter connection

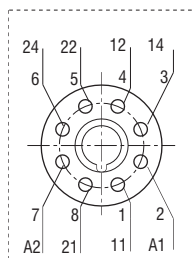

SRR11 Panel mount or 35mm Din Rail (EN50022)

Characteristics

Ambient temperature	-40 to 70 °C
Rated voltage	300VAC
Rated current	15A (Per pole)
Insulation voltage	>5KV
Protection degree	IP20
Socket material	Self-extinguishing-PA66+GF (V0)
Contacts spring material	QSn6.5-0.1
Hold down spring	No
Wire strip length	7mm



Mounting dimension

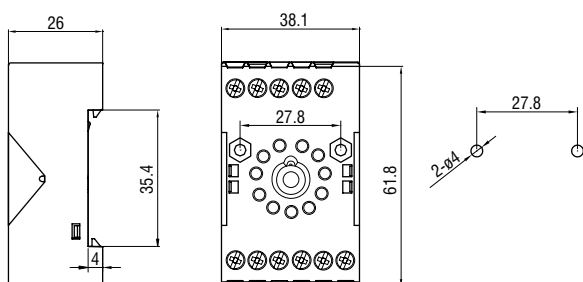

Inter connection

