

DASH NO.	M CODE	MADE FROM
----------	--------	-----------

# GSD

1203-32-9

REVISIONS	
ISSUE	CHANGES
0	ER 39580 DRK 08/17/06
1	CN 39971 C DRK 06/18/07

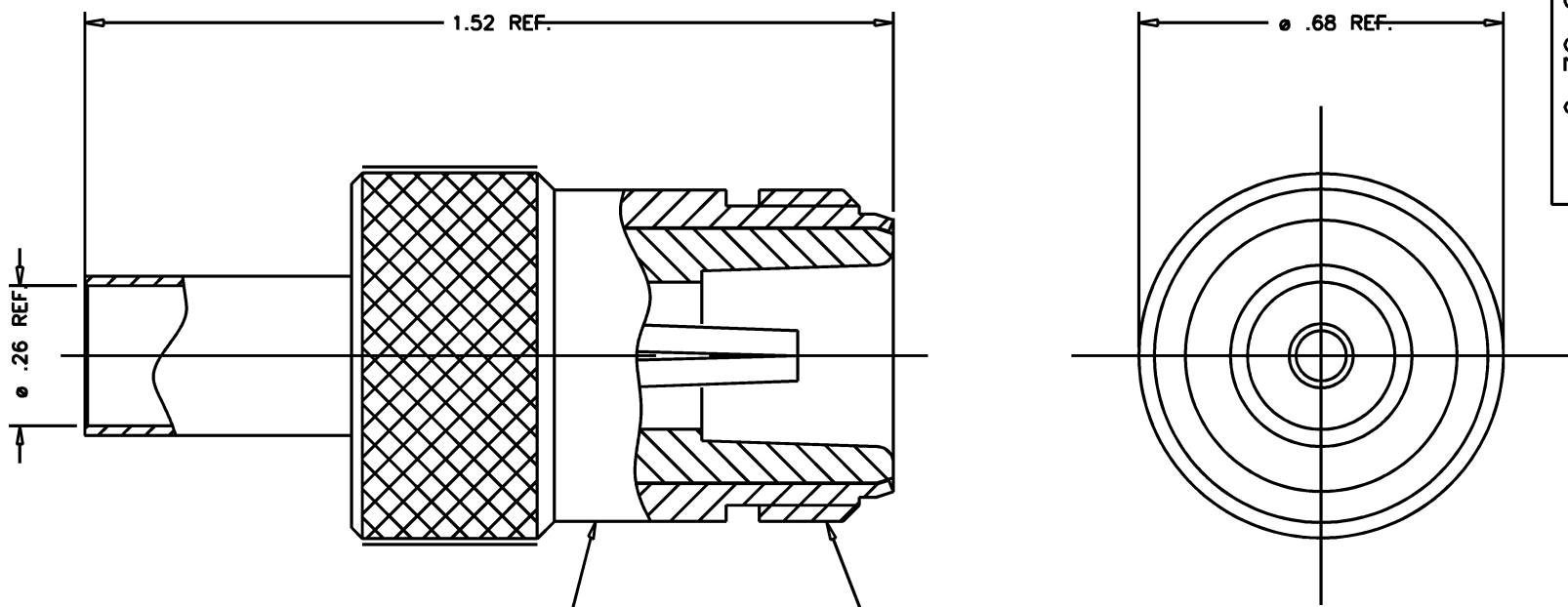

STAMP: KINGS 1203-32-9 5/8-24UNEF-2A THREAD  
YRWK(DATE CODE)

- NOTES:**
- FOR USE WITH BELDEN RF 240 CABLE.
  - FOR CABLING INSTRUCTIONS SEE 3-800.
  - FOR CRIMPING USE DIE KTH-2002
  - INTERFACE PER MIL-STD-348, FIG. 304-1.
  - CRIMPING SLEEVE (S-89-06-2 M06) AND CENTER CONTACT (1-8729-1 MC9) TO BE SUPPLIED UNASSEMBLED.
  - MATERIALS:**  
INSULATOR: TEFLON ASTM-D4894.  
K-GRIP SLEEVE: COMMERCIAL BRONZE ASTM-B140.  
ALL OTHER METAL PARTS: BRASS ASTM-B16.
  - FINISHES:**  
CENTER CONTACT: GOLD PLATE ASTM-B488.  
ALL OTHER METAL PARTS: KINGS TARNISH RESISTANT FINISH (TR-5).
  - ELECTRICAL CHARACTERISTICS:**  
NOMINAL IMPEDANCE: 50 OHMS.  
WORKING VOLTAGE: 1000 VRMS.  
FREQUENCY RANGE: DC TO 11 GHZ.

SCALE 4:1	
APPROX SURFACE AREA	
USED ON	
REF: EQR 933	
JACK, N	
DRAWN DRK	DATE 04/05/06
DESIGN DRK	DATE 04/05/06
APPR.	DATE

- UNLESS OTHERWISE SPECIFIED**
- |  |   |  |
|--|---|--|
| 1. TOLERANCES: FRACTIONS & 2 PLACE DECIMALS ± .010<br>3 PLACE DECIMALS ± .004 ANGLES ± 1°<br>CONCENTRICITY OF ANY 2 DIAMETERS MAY NOT EXCEED HALF THE SUM OF THEIR TOLERANCES. | 2. REMOVE ALL BURRS, BREAK SHARP EDGES .005 MAX.<br>3. NO FILLETS PERMITTED.<br>4. SURFACE ROUGHNESS 63 MICRONS RMS MAX.<br>5. ALL DIMENSIONS PRIOR TO PLATING.<br>6. ALL PLATING IN ACCORDANCE WITH KER 10004. | 7. ALL LEAD THREADS TO BE CHAMFERED 45° TO ROOT DIAMETER.<br>* CRITICAL DIMENSIONS |
|--|---|--|

# GSD

A Winchester Electronics Company

1203-32-9