

REV	DATE	DESCRIPTION	ECO	SIGN
1	04/11/97	RELEASE TO PILOT	490	RAB

**SPECIFICATIONS:**

Capacity	3,000 pounds
Rated output at capacity, typical. (See calibration data sheet.)	2 mV/V
Combined error (See calibration data sheet.)	0.5%
Non-repeatability	0.05%
No load zero balance	± 10%
Temperature range, compensated	50°F to 150°F
Temperature effects, output	0.001%/°F
Temperature effects, zero balance	0.005%/°F
Input impedance, typical	350 ohms
Output impedance, typical	350 ohms
Excitation Voltage, typical	10 VDC or AC rms
Excitation voltage, maximum	15 VDC or AC rms
Insulation resistance	<5,000 Megohms @ 50 VDC
Maximum load, safe	150%
Maximum load, ultimate	200%

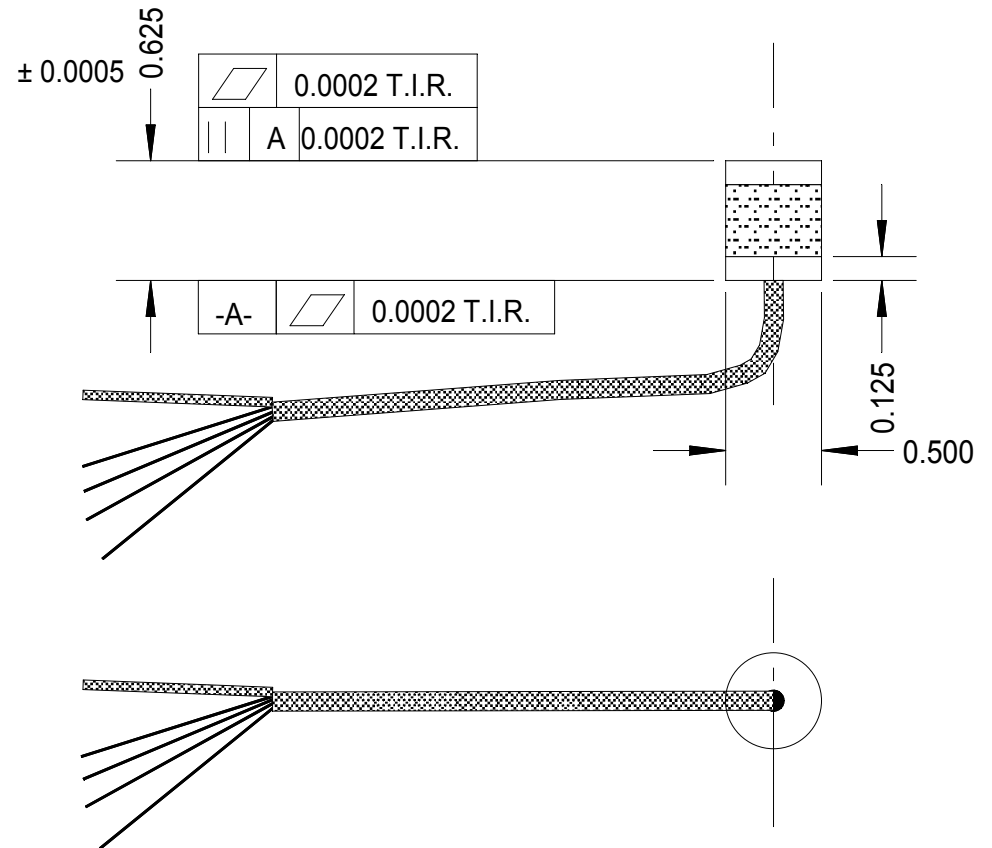

**COLOR CODE:**

YELLOW + EXC.

BLACK - EXC.

WHITE + EXC.

RED - EXC.

SHIELD FLOATS AT CELL

CABLE: MICROTECH MS4-30 0.110 DIAMETER BY 10 FT. LONG.

REF. SS1071

TOLERANCES UNLESS OTHERWISE SPECIFIED:

.XXX = ± 0.005

.XX = ± 0.015

.X = ± 0.025

SCALE: FULL

FINISH: FINE BRUSHED LOOK

MAT'L: ALLOY STEEL

HARDNESS: Rc 40-46



TOLEDO  
TRANSDUCERS,  
INC.

Designed By: **Mettert**

Date:  
**4/10/97**

Drawn By:

Date:

Approved By:

Date:

Title / Description:

**3K BUTTON  
LOAD CELL**

Dwg. Size:

**A**

Dwg. Type:

**SPEC**

Page 1 of 1

Part No.

**SS1146**

File Name

**10336SP.FCD**

Doc. No.

**10336**