

THIS IS A C.A.D. GENERATED DRAWING
DO NOT MAKE MANUAL REVISIONS TO MASTER.

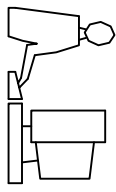

ISSUE NUMBER
ORIGINAL
①

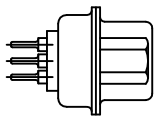
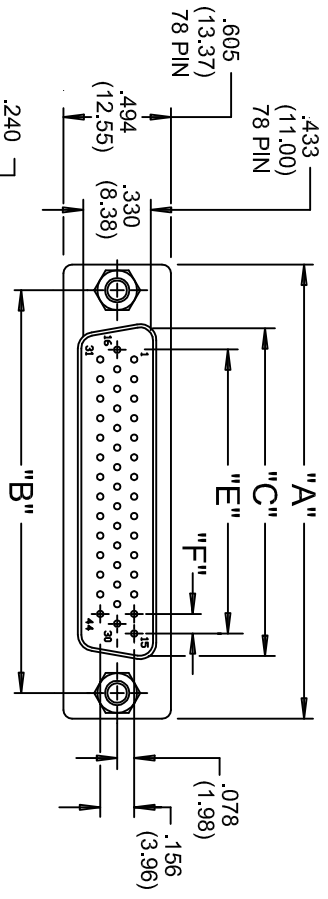

MATERIALS:

INSULATOR: THERMOPLASTIC POLYESTER, UL94V-O
CHEMICAL RESISTANCE, COLOR BLACK

SHEET: STEEL, NICKEL PLATED

CONTACT: BRASS

GOLD FLASH (CONTACT CODE 230)
10 MICRONS GOLD (CONTACT CODE 530)
30 MICRONS GOLD (CONTACT CODE 630)
TIN PLATING ON TAIL ENDS

ELECTRICAL:

CURRENT RATING: 5 AMPERES
DIELECTRIC WITHSTANDING VOLTAGE:
1000VAC rms AT SEA LEVEL
INSULATION RESISTANCE: 5000 MEGOHMS MIN.
CONTACT RESISTANCE: 10 MILLIOHMS MAX.
WORKING TEMPERATURE: -55° TO +125° C

NOTE: ALL CONNECTORS WITH THREADED INSERTS MUST WITHSTAND A MIN. TORQUE OF 3 Kgf-cm

ORDERING CODE

SERIES _____
NUMBER OF CONTACTS _____
CONTACT FINISH CODE _____
CONNECTOR CODE _____
30- LOW PROFILE P.C.B. TAILS
GROUNDING FEATURE _____
4- METAL COVERED
MOUNTING OPTIONAL _____
1- .125(3.18) DIA. THROUGH HOLE
2- 4-40 UNC THREADED INSERT
3- 4-40 UNC THREADED STANDOFFS
6- 4-40 UNC THREADED INSERT WITH BOARDLOCKS
7- 4-40 UNC THREADED STANDOFF WITH BOARDLOCKS
8- 4-40 UNC THREADED FIXED STANDOFF

637-015-230-042

NUMBER OF CONTACTS	"A"	"B"	"C"	"E"	"F"
	Inch (mm)	Inch (mm)	Inch (mm)	Inch (mm)	Inch (mm)
15	1.214 (30.84)	.984 (24.99)	.667 (16.92)	.405 (10.29)	.090 (2.29)
26	1.545 (39.24)	1.312 (33.32)	.994 (25.25)	.765 (19.43)	.090 (2.29)
44	2.088 (53.04)	1.852 (47.04)	1.534 (38.96)	1.305 (33.15)	.090 (2.29)
62	2.730 (69.34)	2.500 (63.50)	2.182 (55.42)	1.948 (49.47)	.095 (2.41)
78	2.635 (66.93)	2.406 (61.11)	2.090 (53.08)	1.805 (45.85)	.095 (2.41)



THIS CONNECTOR FULLY CONFORMS TO THE EUROPEAN UNION DIRECTIVES 2002/95/EC AND 2002/96/EC FOR ROHS COMPLIANCY.

**637 SERIES HIGH DENSITY SUBMINIATURE D CONNECTOR
PLUG(PIN) VERTICAL MOUNT P.C.B
LOW PROFILE METAL BODY**

DRAWN: F. BRIONES DATE: NOV. 26/97
CHECKED: DATE:

PART NUMBER
SEE ORDERING CODE

EDAC INC
TORONTO, ONTARIO
CANADA
YOUR CONNECTION TO QUALITY & SERVICE

THESE DRAWINGS AND SPECIFICATIONS ARE THE PROPERTY OF EDAC INC. AND SHALL NOT BE REPRODUCED OR COPIED OR USED AS THE BASIS FOR THE MANUFACTURE OR SALE OF APPARATUS WITHOUT WRITTEN PERMISSION.

DRAWING NUMBER
637-000-001
ISSUE
5

Mouser Electronics

Authorized Distributor

Click to View Pricing, Inventory, Delivery & Lifecycle Information:

[EDAC:](#)

[637-015-230-046](#) [637-015-230-042](#) [637-015-230-047](#)