

◇ = ASO ONLY (APPLICATION SPECIFIC ORDER)

QTE-XXX-XX-XXX-D-DP-XXX

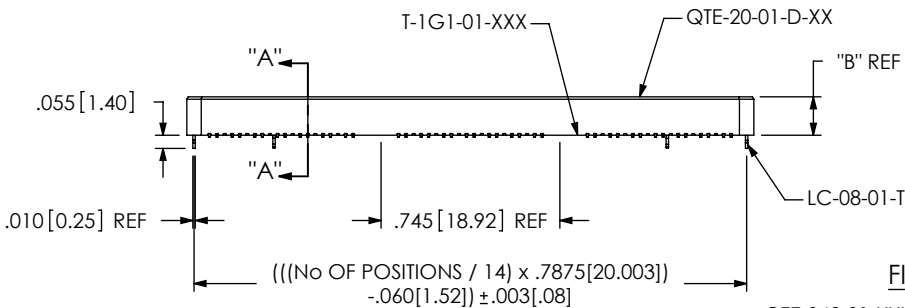
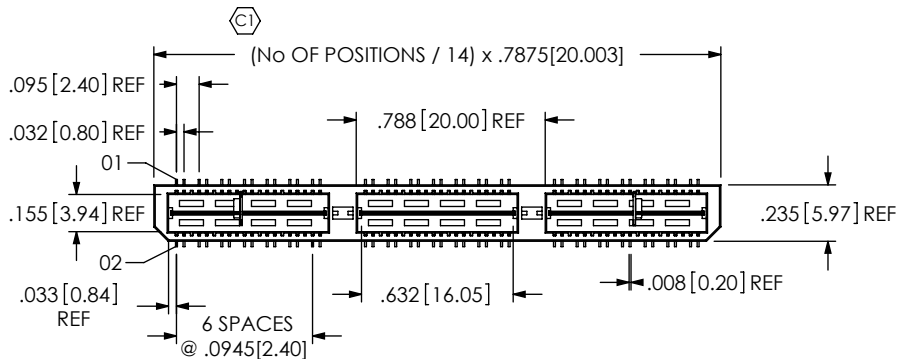

FIG. 1

QTE-042-01-XXX-D-DP-LC SHOWN

-LC: LOCKING CLIP OPTION SHOWN

-A: ALIGNMENT PIN OPTION SHOWN (STYLES -01, -02 & -03)

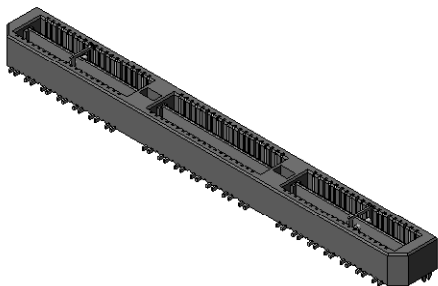
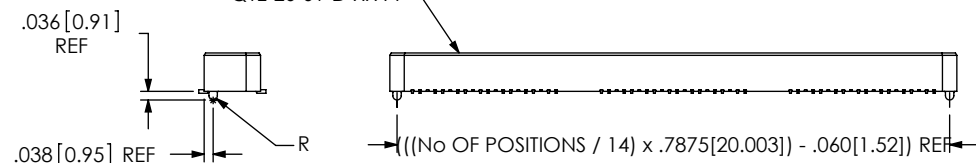

TABLE 2	
No OF POSITIONS	COPLANARITY (INCLUDES GROUND PLANE)
-014 THRU -042	.0040 [.10]
-056 THRU -070	.0060 [.15]

TABLE 1						MATED HEIGHT WITH QSE-DP-01
STYLE	"A"	"B"	BODY	GROUND PLANE	TERMINAL	
-01	.1680 [4.267]	.1600 [4.064]	QTE-20-01-D-XX	T-1G1-01-XXX	T-1S39-01-XXX	.197 [5.00] REF
-02	.2861 [7.267]	.2781 [7.064]	QTE-20-02-D-XX	T-1G1-02-XXX	T-1S59-02-XXX	.315 [8.00] REF
-03	.4042 [10.267]	.3962 [10.063]	QTE-20-03-D-XX	T-1G1-03-XXX	T-1S39-03-XXX	.433 [11.00] REF

No OF POSITIONS
-014, -028, -042,
-056, -070
(PER ROW)
(*SEE NOTE 12)

LEAD STYLE

- 01: .1680 [4.267] (SEE FIG.1)
- 02: .2861 [7.264] (SEE FIG.1)
- 03: .4042 [1.123] (SEE FIG.1)
- ◇ -04: .600 [15.24] (SEE FIG. 4, SHT. 3)
- ◇ -05: .718 [18.237] (SEE FIG. 4, SHT. 3)
- ◇ -06: .835 [21.209] (SEE FIG. 4, SHT. 3)
- ◇ -07: .954 [24.232] (SEE FIG. 4, SHT. 3)
- ◇ -08: 1.151 [29.24] (SEE FIG. 4, SHT. 3)
- ◇ -09: .522 [13.258] (SEE FIG. 4, SHT. 3)
- ◇ -10: .5606 [14.239] (SEE FIG. 4, SHT. 3)

PLATING SPECIFICATION

- F: FLASH SELECTIVE GOLD WITH MATTE TIN TAILS (USE T-1SXX-XX-F, T-1G1-XX-F)
- L: LIGHT SELECTIVE GOLD WITH MATTE TIN TAILS (USE T-1SXX-XX-L, T-1G1-XX-L)
- H: HEAVY GOLD WITH FLASH GOLD TAILS (USE T-1SXX-XX-H, T-1G1-XX-G)
- C: ELECTRO-POLISHED SELECTIVE (USE T-1SXX-XX-C, T-1G1-XX-L)
- STL: HEAVY SELECTIVE GOLD WITH TIN LEAD TAILS (USE T-1SXX-XX-STL, T-1G1-XX-STL)
- FTL: FLASH SELECTIVE GOLD WITH TIN LEAD TAILS (USE T-1SXX-XX-FTL, T-1G1-XX-FTL)

OPTION

- A: ALIGNMENT PINS (USE QTE-20-01-D-XX-X-GP)
- LC: LOCKING CLIPS (SEE NOTE 13) (USE LC-08-TM-01)
- K: POLYIMIDE FILM (USE K-DOT-.276-.375-.005) (SEE FIG. 2, SHT. 2) (N/A ON STYLES -07 & -08)
- GP: GUIDE POSTS (AVAILABLE ON -01 ONLY) (USE QTE-20-01-D-XX-X-GP) (SEE FIG. 3, SHT. 2)
- TR: TAPE & REEL (42 POS. MAX) (NOT AVAILABLE ON -05, -06, -07, -08 LEAD STYLES) (028 POS MAX FOR -GP OPTION)
- RT1: RETENTION OPTION (SEE FIG. 7, SHEET 4) (ONLY AVAILABLE ON -01 LEAD STYLE) (MUST USE -A OPTION) (USE QTE-20-01-D-XX-A-RT1 & T-1R36-01-F) (NOT AVAILABLE WITH -LC, -GP, -SD, OR -FL) (NOT AVAILABLE ON -056 & -070 POS)
- AG -L: LATCHING OPTION (28 POS. MAX.) (SEE FIG. 8, SHEET 5) (MUST USE -A OPTION) (AVAILABLE ON -01 ONLY) (NOT AVAILABLE WITH -LC, -GP, -SD, -FL OR -RT1)

BODY STYLE

-DP: DIFFERENTIAL PAIRS

ROW SPECIFICATION

-D: DOUBLE (USE QTE-20-XX-D-XX & QTEH-20-XX-D-XX)

No OF BANKS

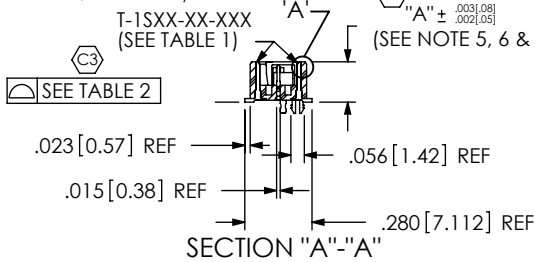

SECTION "A"-"A"

DETAIL 'A' SCALE 6:1

NOTES:

1. Ⓞ REPRESENTS A CRITICAL DIMENSION.
2. MINIMUM TERMINAL RETENTION: 5 OZ.
3. MINIMUM GROUND PLANE RETENTION: 1 LB.
4. PARTS TO BE MOLDED TO POSITION.
5. MAXIMUM VARIANCE OF .002 [.05].
6. DIMENSION APPLIES TO TERMINALS AND GROUND PLANE.
7. DELETED.
8. DELETED.
9. -L PLATING CAN BE SUBSTITUTED FOR -F PLATING.
10. GROUND PLANE PRESS HEIGHT MUST BE .003 [0.08] LESS THAN THE MAX HEIGHT OR .001 [0.03] GREATER THAN THE MINIMUM HEIGHT OF THE TERMINALS.
11. T-1R36 RETENTION TO BODY TO BE 1.0 LBF.
12. FOR NEW APPLICATIONS REQUIRING THESE POSITIONS, PLEASE CONTACT SAMTEC INTERCONNECT PROCESSING GROUP.
13. DUE TO THE HIGH AMOUNT OF INSERTION FORCE NEEDED, THE -LC OPTION IS NOT COMPATIBLE WITH AUTO PLACEMENT. SAMTEC RECOMMENDS MANUAL PLACEMENT FOR ALL ASSEMBLIES WITH THE -LC OPTION.

UNLESS OTHERWISE SPECIFIED, DIMENSIONS ARE IN INCHES.

TOLERANCES ARE:
DECIMALS: .XX: ±.01 [.3]
.XXX: ±.005 [.13]
.XXXX: ±.0020 [.051]

PROPRIETARY NOTE

THIS DOCUMENT CONTAINS INFORMATION CONFIDENTIAL AND PROPRIETARY TO SAMTEC, INC. AND SHALL NOT BE REPRODUCED OR TRANSFERRED TO OTHER DOCUMENTS OR DISCLOSED TO OTHERS OR USED FOR ANY PURPOSE OTHER THAN THAT WHICH IT WAS OBTAINED WITHOUT THE EXPRESSED WRITTEN CONSENT OF SAMTEC, INC.



520 PARK EAST BLVD. NEW ALBANY, IN 47150
PHONE: 812-944-6733 FAX: 812-948-5047
e-Mail: info@SAMTEC.com code: 55322

MATERIAL: DO NOT SCALE DRAWING SHEET SCALE: 1.25:1

INSULATOR: LCP, BLACK
TERMINAL: PHOS BRONZE
GROUND PLANE: PHOS BRONZE

DESCRIPTION: .8mm DIFFERENTIAL PAIRS HS TERMINAL ASSEMBLY

DWG. NO. QTE-XXX-XX-XXX-D-DP-XXX

BY: DEAN P 4/28/2000 SHEET 1 OF 5

FIG. 2
 -K: POLYIMIDE FILM PAD
 [USE K-DOT-.276-.375-.005]

NOTE: "R" = (No OF POSITIONS / 14) x .7875[20.003]
 "S" = (("R" - .276[7.01]) / 2) ±.020[.51]

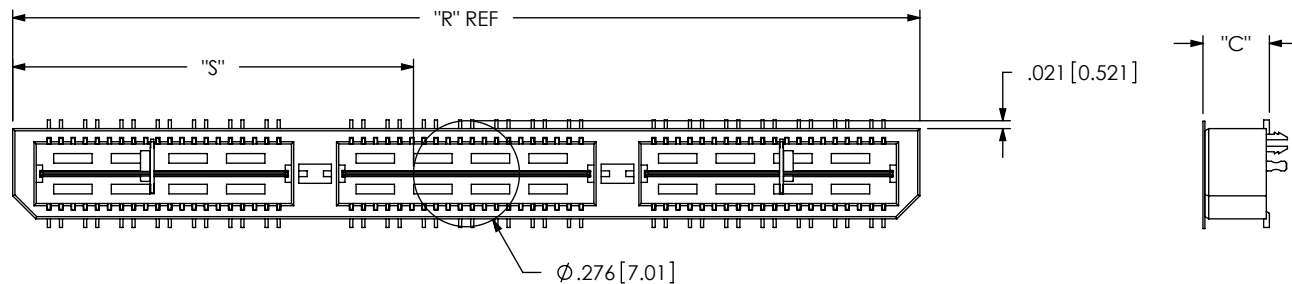

STYLE	"C"
-01	.173[4.39]
-02	.291[7.39]
-03	.409[10.39]
-04	.605[15.37]
-05	.723[18.36]
-06	.841[21.36]
-09	.527[13.39]
-10	.567[14.37]

FIG. 3
 -GP: GUIDE POST OPTION
 (-01 LEAD STYLE ONLY)
 (SAME AS FIG. 1, UNLESS OTHERWISE STATED)

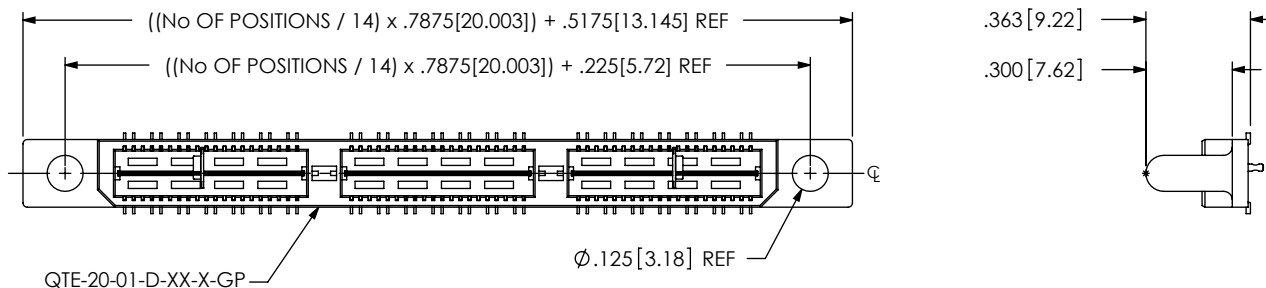

QTEH-20-XX-D-XX-A
 QTE-20-03-D-XX-A
 (-LC BODY MAY BE USED TO SUBSTITUTE)

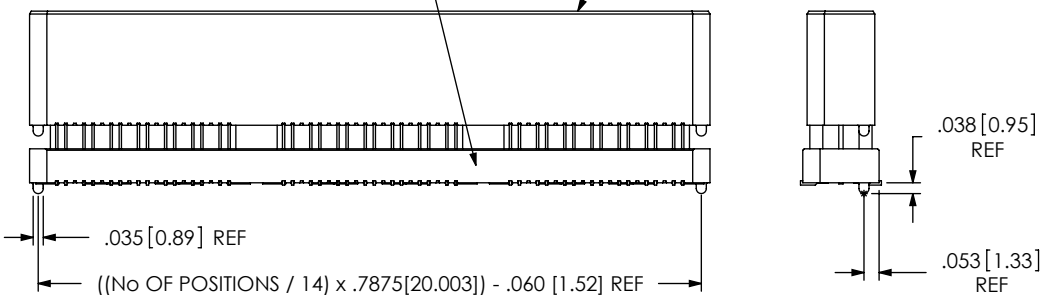

-A: ALIGNMENT PIN OPTION
 (STYLES -04, -05, -06, -07, -08, -09, -10)

PROPRIETARY NOTE
 THIS DOCUMENT CONTAINS INFORMATION
 CONFIDENTIAL AND PROPRIETARY TO
 SAMTEC, INC. AND SHALL NOT BE REPRODUCED
 OR TRANSFERRED TO OTHER DOCUMENTS OR
 DISCLOSED TO OTHERS OR USED FOR ANY
 PURPOSE OTHER THAN THAT WHICH IT WAS
 OBTAINED WITHOUT THE EXPRESSED WRITTEN
 CONSENT OF SAMTEC, INC.

DO NOT SCALE DRAWING

SHEET SCALE: 2:1

samtec

520 PARK EAST BLVD., NEW ALBANY, IN 47150
 PHONE: 812-944-6733 FAX: 812-948-5047
 e-Mail: info@SAMTEC.com code: 55322

DESCRIPTION:
 .8mm DIFFERENTIAL PAIRS HS TERMINAL ASSEMBLY

DWG. NO.
QTE-XXX-XX-XXX-D-DP-XXX

BY: DEAN P 4/28/2000 SHEET 2 OF 5

TABLE 4						MATED HEIGHT WITH QSE-DP-01
STYLE	"D"	GROUND PLANE	TERMINAL	FILLER BODY	SPACER BODY	
-04	.600[15.24]	T-1G1-04-XXX	T-1S41-04-XXX	QTE-20-03-D-XX	QTEH-20-01-D-XX-X	.630 [16.00] REF
-05	.718[18.237]	T-1G1-05-XXX	T-1S41-05-XXX	QTE-20-03-D-XX	QTEH-20-01-D-XX-X	.748 [19.00] REF
-06	.835[21.209]	T-1G1-06-XXX	T-1S41-06-XXX	QTE-20-03-D-XX	QTEH-20-02-D-XX-X	.866 [22.00] REF
-07	.954[24.232]	T-1G17-01-XXX	T-1S61-21-XXX	QTEH-20-04-D-XX-X	QTE-20-02-D-XX-X	.984 [25.00] REF
-08	1.151[29.24]	T-1G17-02-XXX	T-1S61-22-XXX	QTEH-20-04-D-XX-X	QTE-20-02-D-XX-X	1.181 [30.00] REF
-09	.522[13.259]	T-1G1-09-XXX	T-1S60-09-XXX	QTEH-20-01-D-XX-X	QTE-20-02-D-XX-X	.551[14.00] REF
-10	.5606[14.239]	T-1G1-10-XXX	T-1S60-10-XXX	QTEH-20-01-D-XX-X	QTE-20-02-D-XX-X	.591[15.00] REF

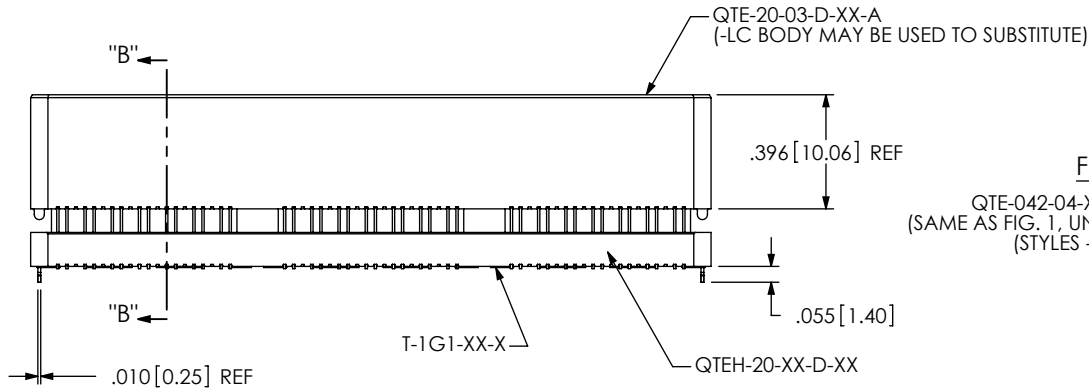
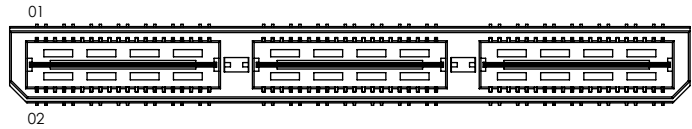
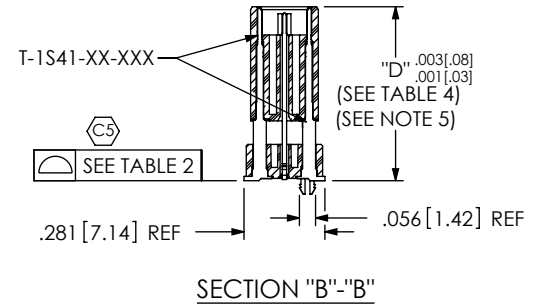

FIG. 4
QTE-042-04-X-D-DP-LC SHOWN
(SAME AS FIG. 1, UNLESS OTHERWISE STATED)
(STYLES -04, -05, & -06)



-LC: LOCKING CLIP OPTION SHOWN

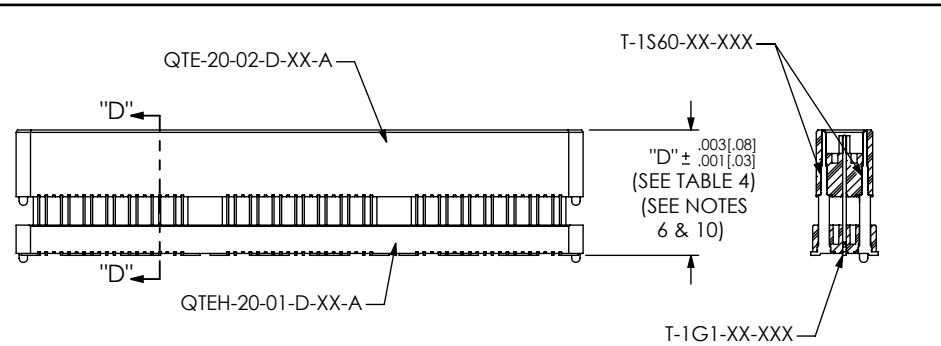
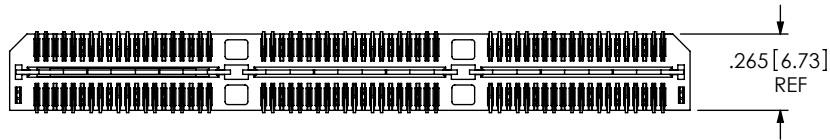

FIG. 6
QTE-042-09-X-D-DP-A SHOWN
[DIFFERENT AS SHOWN, OTHERWISE SAME AS FIG. 4]
(STYLES -09 & -10)

SECTION "D"-"D"
SCALE 1.25 : 1

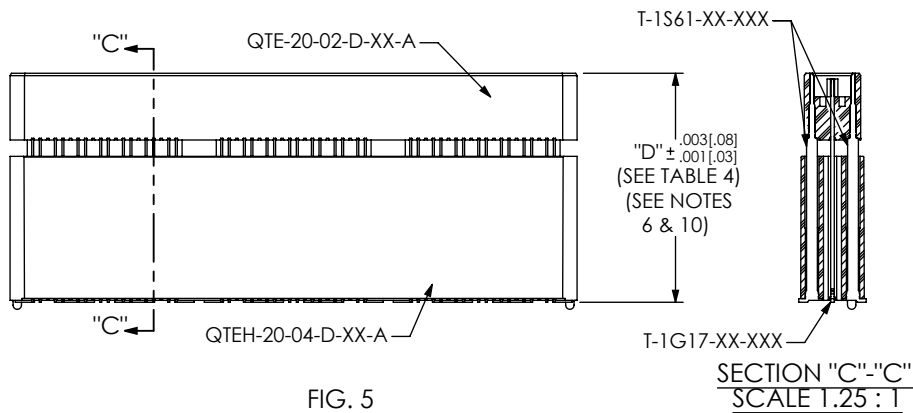

FIG. 5
QTE-042-07-X-D-DP-A SHOWN
[DIFFERENT AS SHOWN, OTHERWISE SAME AS FIG. 4]
(STYLES -07 & -08)

SECTION "C"-"C"
SCALE 1.25 : 1

F:\DWG\MISC\MKTG\QTE-XXX-XX-XXX-D-DP-XXX-MKT.SLDDRW

PROPRIETARY NOTE
THIS DOCUMENT CONTAINS INFORMATION CONFIDENTIAL AND PROPRIETARY TO SAMTEC, INC. AND SHALL NOT BE REPRODUCED OR TRANSFERRED TO OTHER DOCUMENTS OR DISCLOSED TO OTHERS OR USED FOR ANY PURPOSE OTHER THAN THAT WHICH IT WAS OBTAINED WITHOUT THE EXPRESSED WRITTEN CONSENT OF SAMTEC, INC.

DO NOT SCALE DRAWING
SHEET SCALE: 1:0.666667



520 PARK EAST BLVD. NEW ALBANY, IN 47150
PHONE: 812-944-6733 FAX: 812-948-5047
e-Mail: info@SAMTEC.com code: 53322

DESCRIPTION:
.8mm DIFFERENTIAL PAIRS HS TERMINAL ASSEMBLY
DWG. NO.
QTE-XXX-XX-XXX-D-DP-XXX
BY: DEAN P 4/28/2000 SHEET 3 OF 5

FIG. 7
 -RT1: RETENTION OPTION
 (ONLY AVAILABLE ON -01 LEAD STYLE)(MUST USE -A OPTION)
 (NOT AVAILABLE WITH -LC, -GP, -SD, OR -FL OPTIONS)
 (NOT AVAILABLE ON -056 & -070 POSITIONS)
 (SAME AS FIG. 1, UNLESS OTHERWISE STATED)

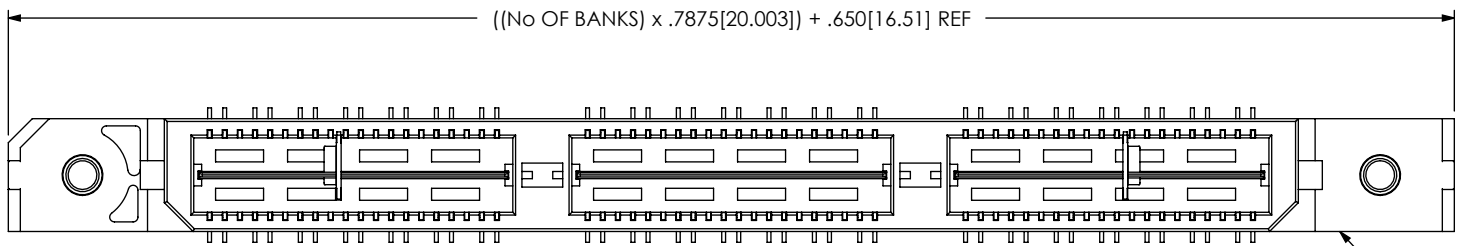

QTE-20-01-D-XX-A-RT1

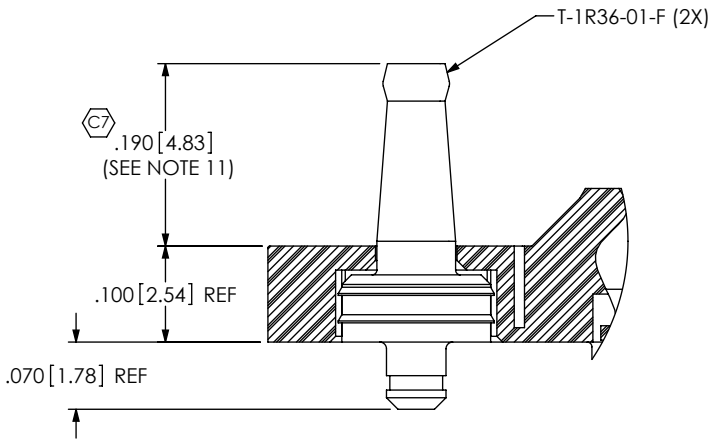
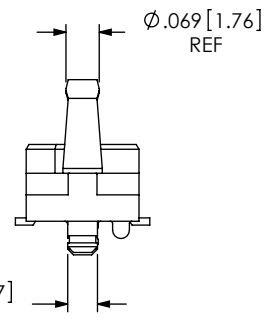
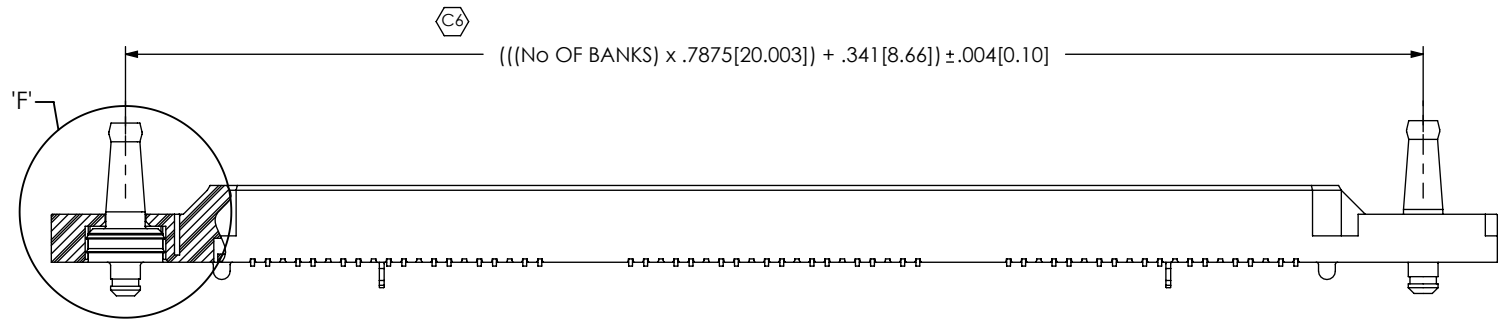

DETAIL 'F'
 SCALE 5:1

PROPRIETARY NOTE
 THIS DOCUMENT CONTAINS INFORMATION
 CONFIDENTIAL AND PROPRIETARY TO
 SAMTEC, INC. AND SHALL NOT BE REPRODUCED
 OR TRANSFERRED TO OTHER DOCUMENTS OR
 DISCLOSED TO OTHERS OR USED FOR ANY
 PURPOSE OTHER THAN THAT WHICH IT WAS
 OBTAINED WITHOUT THE EXPRESSED WRITTEN
 CONSENT OF SAMTEC, INC.

DO NOT SCALE DRAWING
 SHEET SCALE: 1:0.4



520 PARK EAST BLVD, NEW ALBANY, IN 47150
 PHONE: 812-944-6733 FAX: 812-948-5047
 e-Mail: info@SAMTEC.com code: 55322

DESCRIPTION:
 .8mm DIFFERENTIAL PAIRS HS TERMINAL ASSEMBLY

DWG. NO.
QTE-XXX-XX-XXX-D-DP-XXX

BY: DEAN P 4/28/2000 SHEET 4 OF 5

AG

FIG. 8
 -L: LATCHING OPTION
 (28 POS. MAX.)
 (MUST USE -A OPTION)
 (AVAILABLE ON -01 LEAD STYLE ONLY)
 (NOT AVAILABLE WITH -LC, -GP, -SD, -FL, OR -RT1)
 (SAME AS FIG. 1, UNLESS OTHERWISE STATED)

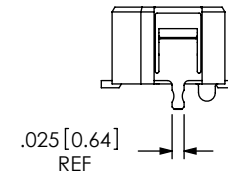
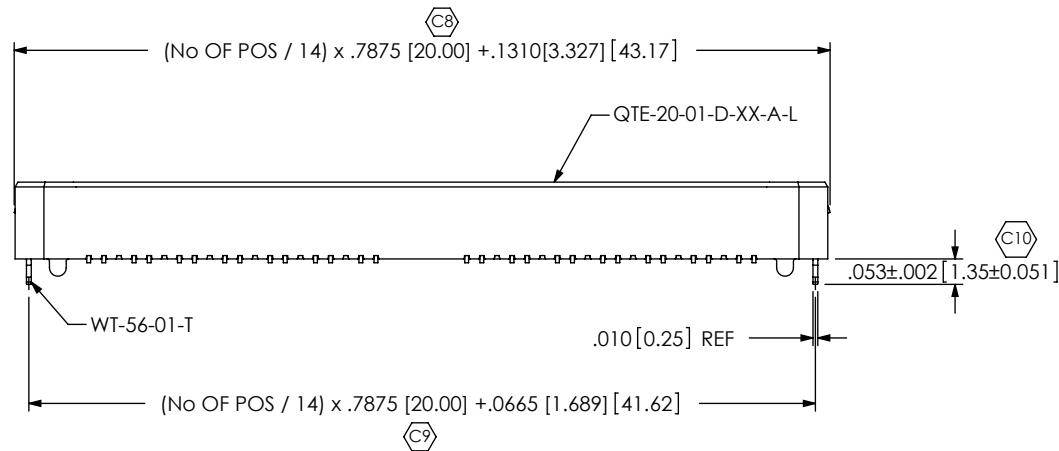
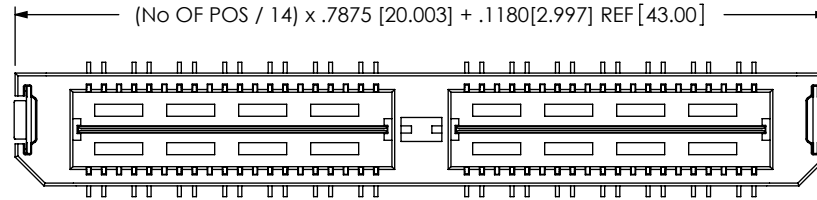

PROPRIETARY NOTE

THIS DOCUMENT CONTAINS INFORMATION CONFIDENTIAL AND PROPRIETARY TO SAMTEC, INC. AND SHALL NOT BE REPRODUCED OR TRANSFERRED TO OTHER DOCUMENTS OR DISCLOSED TO OTHERS OR USED FOR ANY PURPOSE OTHER THAN THAT WHICH IT WAS OBTAINED WITHOUT THE EXPRESSED WRITTEN CONSENT OF SAMTEC, INC.

DO NOT SCALE DRAWING

SHEET SCALE: 1:0.4

samtec

520 PARK EAST BLVD, NEW ALBANY, IN 47150
 PHONE: 812-944-6733 FAX: 812-948-5047
 e-Mail: info@SAMTEC.com code: 55322

DESCRIPTION:
 .8mm DIFFERENTIAL PAIRS HS TERMINAL ASSEMBLY

DWG. NO.
QTE-XXX-XX-XXX-D-DP-XXX

BY: DEAN P 4/28/2000 SHEET 5 OF 5