

# General

Toggles

Rockers

Pushbuttons

Illuminated PB

Programmable

Keylocks

Rotaries

Slides

Tactiles

Tilt

Touch

Indicators

Accessories

Supplement

Logic Level: 0.4VA maximum @ 28V AC/DC maximum  
(Applicable Range 0.1mA ~ 0.1A @ 20mV ~ 28V)  
Note: Find additional explanation of operating range in Supplement section.

Contact Resistance: 80 milliohms maximum  
Insulation Resistance: 500 megohms minimum @ 500V DC  
Dielectric Strength: 500V AC minimum for 1 minute minimum  
Mechanical Life: 50,000 operations minimum  
Electrical Life: 50,000 operations minimum  
Nominal Operating Force: 1.70N  
Travel: Pretravel .035 (0.9mm); Overtravel .008 (0.2mm); Total Travel .043 (1.1mm)

Actuator: Polyacetal  
Case: Glass fiber reinforced polyamide  
Sealing Rings: Nitrile butadiene rubber  
Movable Contacts: Phosphor bronze with gold plating  
Stationary Contacts: Phosphor bronze with gold plating  
Base: Glass fiber reinforced polyamide  
Mounting Bracket: Phosphor bronze with tin plating  
Terminals: Phosphor bronze with gold plating

Operating Temp Range: 30°C through +85°C ( 22°F through +185°F)  
Humidity: 90 ~ 95% humidity for 96 hours @ 40°C (104°F)  
Vibration: 10 ~ 55Hz with peak-to-peak amplitude of 1.5mm traversing the frequency range & returning in 1 minute; 3 right angled directions for 2 hours  
Shock: 50G (490m/s<sup>2</sup>) acceleration (tested in 6 right angled directions, with 5 shocks in each direction)

Cap Installation Force: 39.1N (8.8 lbf) maximum downward force on actuator

Soldering: Wave Soldering Recommended: See Profile A in Supplement section.  
Manual Soldering: See Profile A in Supplement section.  
Cleaning: Automated cleaning. See Cleaning specifications in Supplement section.

The GB Series pushbuttons have not been tested for UL recognition or CSA certification. These switches are designed for use in a low-voltage, low-current, logic-level circuit. When used as intended in a logic-level circuit, the results do not produce hazardous energy.



# Process Sealed Ultra-Miniature Pushbuttons

## TYPICAL SWITCH ORDERING EXAMPLE

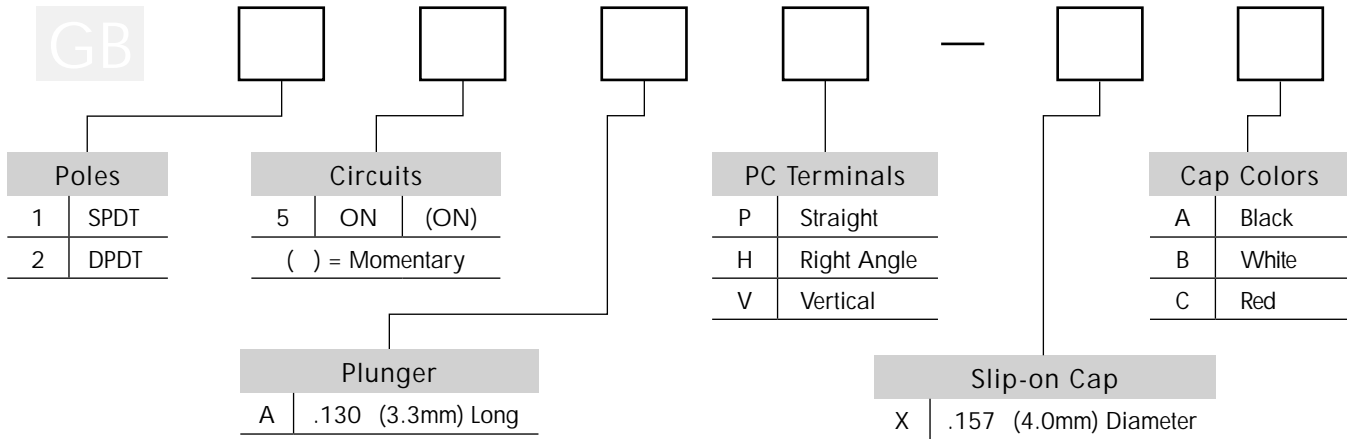

## DESCRIPTION FOR TYPICAL ORDERING EXAMPLE



## POLES & CIRCUITS

Pole	Model	Plunger Position ( ) = Momentary		Connected Terminals		Throw & Schematics
		Normal	Down	Normal	Down	
SP	GB15	ON	(ON)	5-6	5-4	SPDT 
DP	GB25	ON	(ON)	5-6 2-3	5-4 2-1	DPDT 

Note: Terminal numbers are not actually on the switch.

## PLUNGER

.130" (3.3mm) Long Plunger

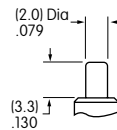

## PC TERMINALS

Straight

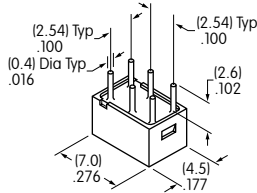

Right Angle

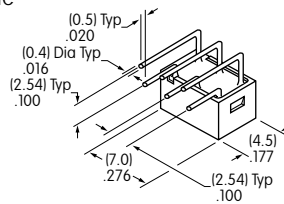

Vertical

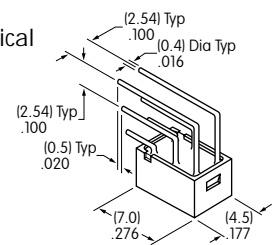

# Process Sealed Ultra-Miniature Pushbuttons

## SLIP-ON CAP & COLORS

 AT4063  
 .157" (4.0mm) Diameter Slip-on Cap

Material: Polyamide

Finish: Glossy



Actual Size

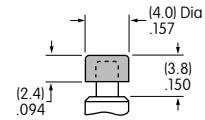

Cap Colors Available:



Black



White



Red

## TYPICAL SWITCH DIMENSIONS

### Single & Double Pole

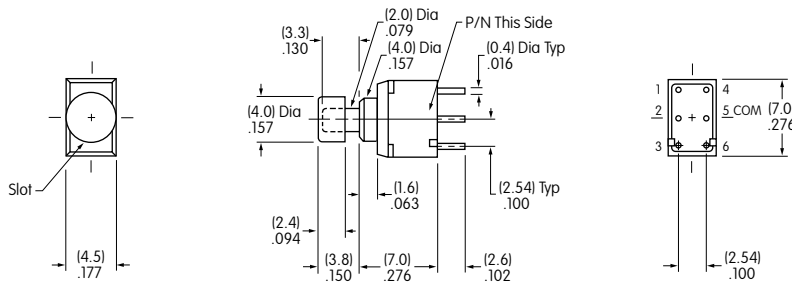

On single pole switches terminals 1 & 3 are support pins.

### Straight PC

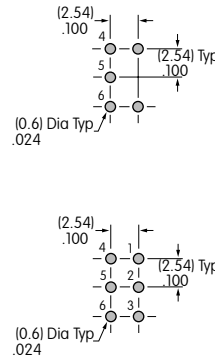

### Single & Double Pole

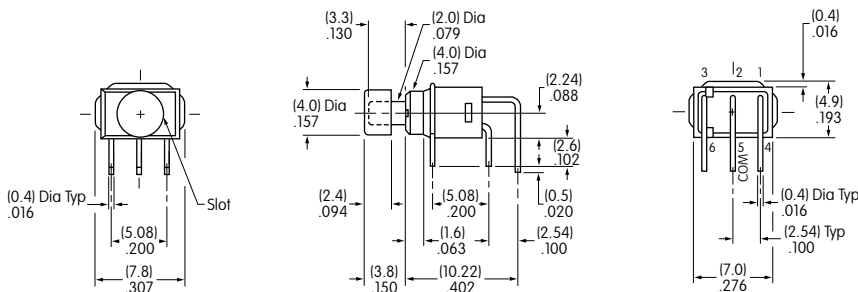

### Right Angle PC

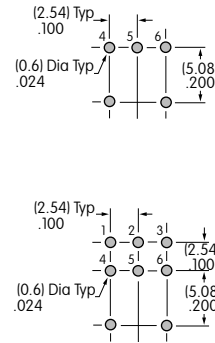

### Single & Double Pole

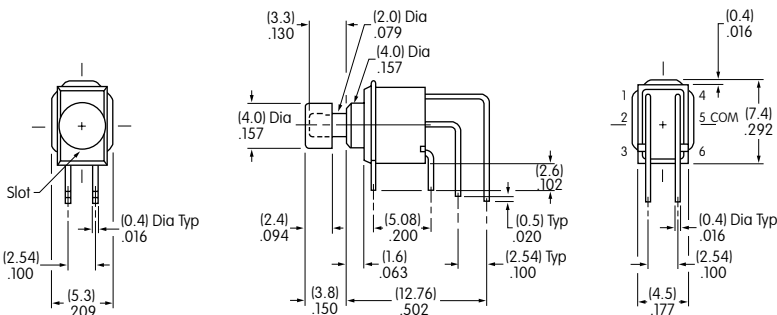

### Vertical PC

