

## TERMINAL BLOCKS

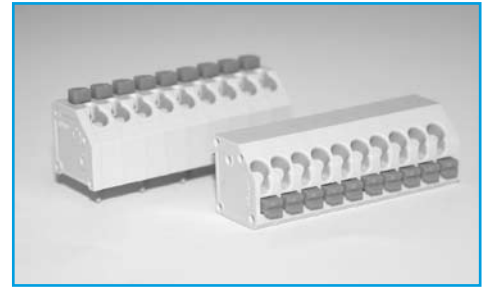

## 3.5mm + 3.81mm PITCH - SCREWLESS

- 3.5mm and 3.81mm pitch
- Interlocking
- 45 degree cable entry
- 1.5mm<sup>2</sup> wire acceptance



### SPECIFICATION

**Rating:** 4A/450V (300V UL) 7  
**Dielectric Strength:** ≥2.5KV/60sec  
**Insulation Resistance:** ≥5MΩ  
**Working temperature:** -20°C to +110°C  
**Moulding:** Grey UL94V-0 flame retardant PA68  
**Pin/terminal:** 5μ tinned, nickel plated brass

**Recommended PCB hole size:** ø1mm

### OUTLINE DRAWING

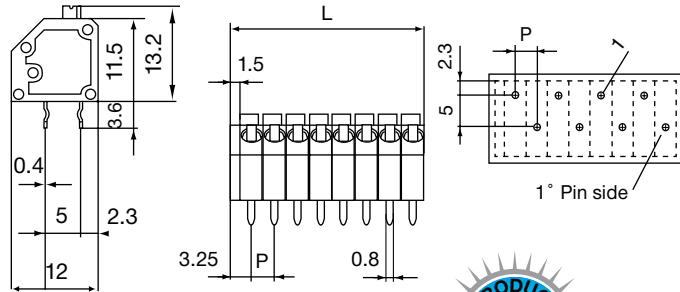

### ORDERING INFORMATION

DBC	TB	70	/2
Dubilier Connectors	Series Terminal Block	Style 70 = 3.5mm 77 = 3.81mm	N° of Ways 2 = 2 ways 3 = 3 ways
* Other Number of ways are available up to 12 Please consult office for further details			

## TERMINAL BLOCKS



- 5.08mm pitch
- UL approved
- 2-7 pole solid block
- Flame retardant material
- 0.3 to 1.5mm<sup>2</sup> wire acceptance

## 5.08mm PITCH - SCREWLESS



### SPECIFICATION

**Rating:** 12A/250V  
**Dielectric Strength:** ≥4KV/60sec  
**Insulation Resistance:** ≥5MΩ  
**Working temperature:** -20°C to 125°C  
**Short Period:** 160°C  
**Moulding:** UL94V-0 flame retardant PA66  
**Pin/terminal:** 5μ tinned, phosphor bronze

**Spring:** Zinc plated steel  
**Recommended PCB hole size:** ø1.1mm

### OUTLINE DRAWING

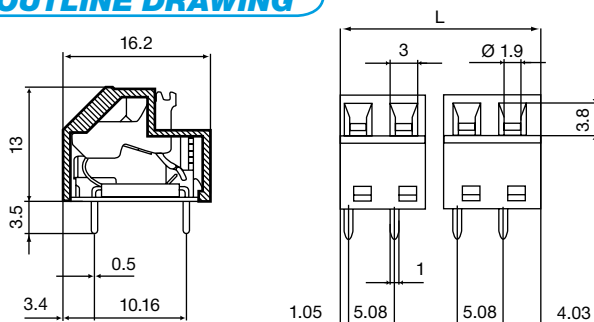

### ORDERING INFORMATION

DBC	TB	41	/2
Dubilier Connectors	Series Terminal Block	Style	N° of Ways 2 = 2 ways 3 = 3 ways



**TERMINAL BLOCKS**

**5, 5.08, 7.5, 7.62, 10 AND 10.16mm SCREWLESS**

- 5, 5.08, 7.5, 7.62, 10 and 10.16mm pitch
- Breakable to desired number of poles
- 1-36 poles on 5 & 5.08mm pitch
- 0.3-1.5mm<sup>2</sup> wire acceptance
- 1-24 poles on 7.5 & 7.62mm pitch
- UL/ VDE/ CE approved
- 1-18 poles on 10 & 10.16mm pitch
- Flame retardant material

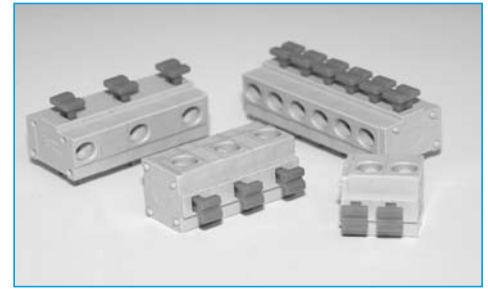

**SPECIFICATION**

	5/5.08	7.5/7.62/10/10.16
<b>Rating:</b>	12/250V	12A/750V
<b>Dielectric Strength:</b>	≥2.5KV/60sec	≥3KV/60sec
<b>Insulation Resistance:</b>	≥5MΩ	
<b>Working temperature:</b>	-20°C to 125°C	
<b>Short Period:</b>	160°	
<b>Moulding:</b>	UL94V-0 flame retardant PA66	
<b>Pin/terminal:</b>	5μ tinned, phosphor bronze	
<b>Spring:</b>	Zinc plated steel	
<b>Recommended PCB hole size:</b>	ø1.1mm	

**OUTLINE DRAWING**

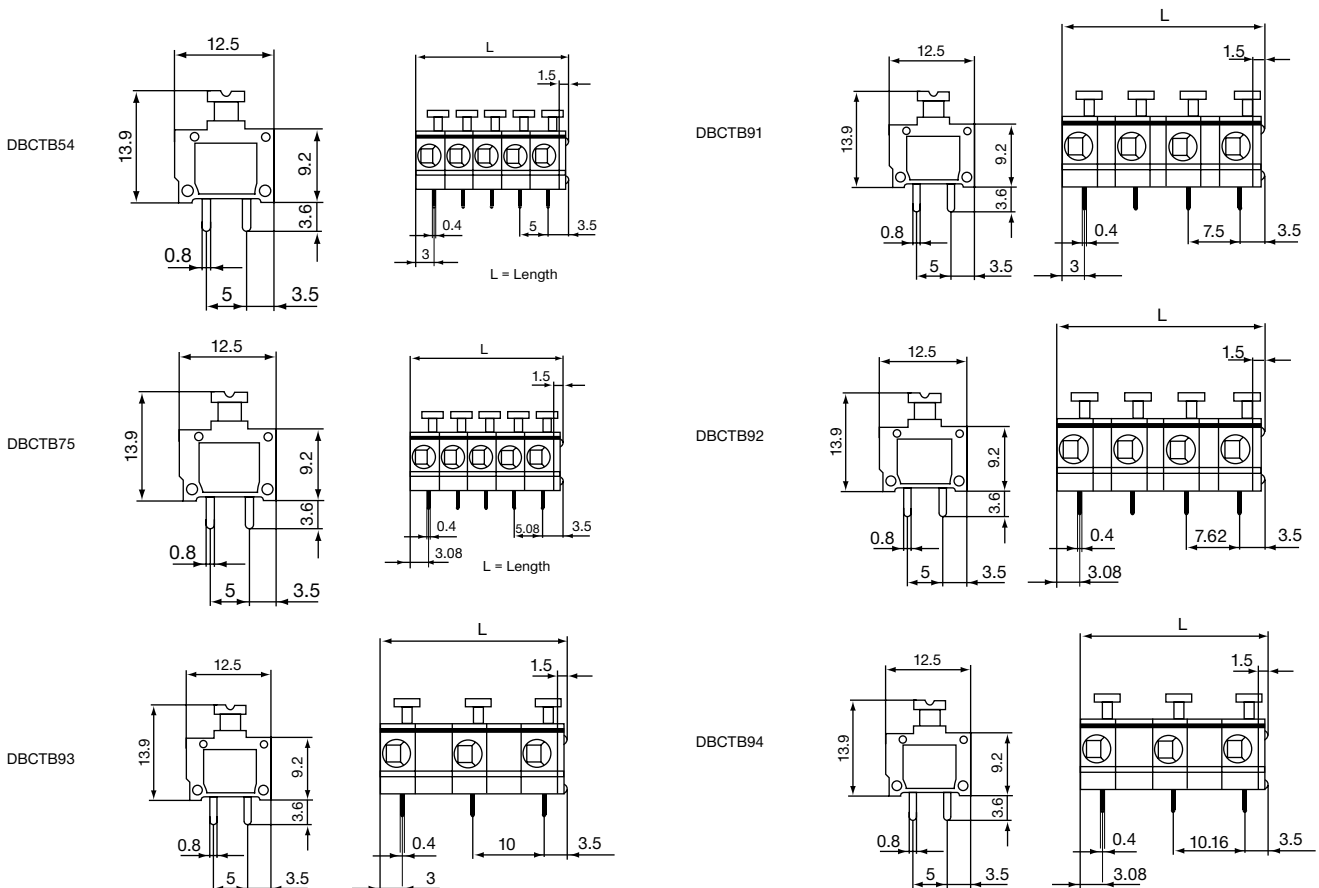

**ORDERING INFORMATION**

DBC	TB	54	/2
Dubilier Connectors	Series Terminal Block	Style 54-5mm 75-5.08mm 91-7.5mm 92-7.62mm 93-10mm 94-10.16mm	N° of Ways 2 = 2 ways 3 = 3 ways
		* Other Number of ways are available up to 12 Please consult office for further details	

**How to calculate lengths**

5mm pitch	No.Poles Multiply by 5mm + 1.5mm
5.08mm pitch	No.Poles Multiply by 5.08mm + 1.5mm
7.5mm pitch	No.Poles Multiply by 7.5mm - 1mm
7.62mm pitch	No.Poles Multiply by 7.62mm - 1.04mm
10mm pitch	No.Poles Multiply by 10mm - 3.5mm
10.16mm pitch	No.Poles Multiply by 10mm - 3.58mm