

NOT RELEASED FOR PRODUCTION

USE FOR QUOTING, PRELIMINARY DESIGN, PROTOTYPING AND INFORMATIONAL PURPOSES ONLY

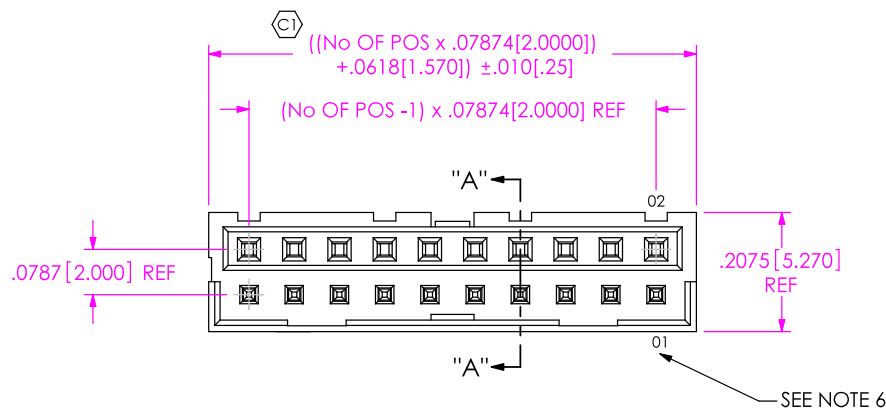

FIG. 1
LS2-110-01-X-D SHOWN

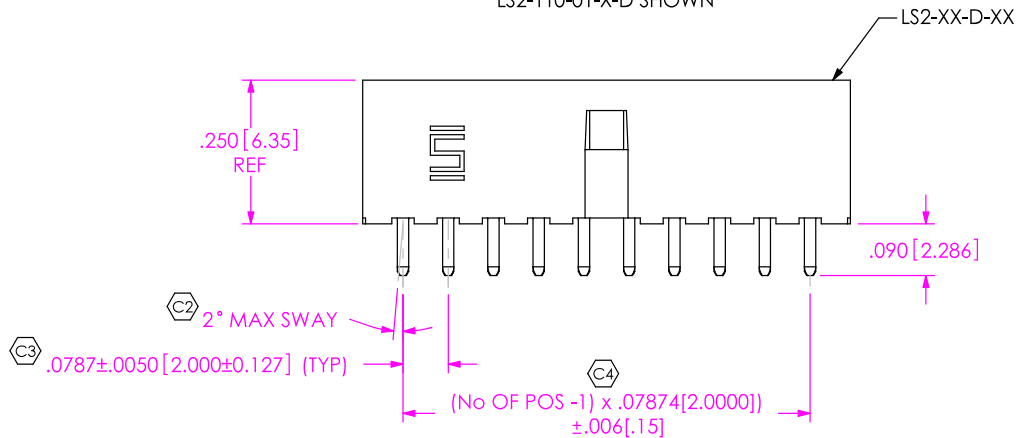

TABLE 2			
STYLE	OPTION	TERMINAL	CONTACT
-01	---	T-1S13-20-XXX-2	C-79-01-XXX
	-RA1	T-1S13-03-XXX-2	C-79-12-XXX
	-RA2	T-1S13-10-XXX-2	C-79-12-XXX
-02	---	T-1S13-13-XXX-2	C-79-12-XXX

NOTES:

1. © REPRESENTS A CRITICAL DIMENSION.
2. BURR ALLOWANCE: .003[.08] MAX.
3. MAXIMUM CUT FLASH: .015[.38].
4. MINIMUM PUSHOUT FORCE; TERMINALS: 2 LBS, CONTACTS: .5 LBS.
5. MAXIMUM ALLOWABLE BOW: .002 INCH/INCH AFTER ASSEMBLY.
6. SEE APPLICATION VIEWS (SHEET 3) FOR POSITION 01 LOCATION.
7. ALL PIN TO PIN DIMENSIONS TO BE MEASURED FROM TIP TO TIP.
8. DIMENSION TO BE MEASURED AT BEND.
9. SHEAR TAILS TO DIMENSION SHOWN.

LS2-1XX-XX-XX-D-XXX-X

No OF POSITIONS

-05, -10, -15, -20,
-25, -30
(PER ROW)

LEAD STYLE

-01: THROUGH HOLE
-02: SURFACE MOUNT
(SEE FIG. 2)

PLATING SPECIFICATION

-F: FLASH SELECTIVE GOLD
(USE T-1S13-XX-F-2 & C-79-XX-F)
-FM: FLASH SELECTIVE GOLD
MATTE TIN REMAINDER
(USE T-1S13-XX-F-2 & C-79-XX-F)
-L: LIGHT SELECTIVE GOLD
(USE T-1S13-XX-L-2 & C-79-XX-L)
-LM: LIGHT SELECTIVE GOLD
MATTE TIN REMAINDER
(USE T-1S13-XX-L-2 & C-79-XX-L)
-S: SELECTIVE GOLD
(USE T-1S13-XX-S-2 & C-79-XX-S)
-SM: SELECTIVE GOLD
MATTE TIN REMAINDER
(USE T-1S13-XX-S-2 & C-79-XX-S)
-G: GOLD
(USE T-1S13-XX-G-2 & C-79-XX-G)
-H: HEAVY GOLD
(USE T-1S13-XX-H-2 & C-79-XX-H)

OPTION

-K: POLYAMIDE FILM PAD
(USE K-500-300, SEE FIG. 5)
[LEAD STYLE -02 ONLY]
* -A: ALIGNMENT PIN
(USE LS2-XX-D-XX-A, SEE FIG. 6)
[LEAD STYLE -02 ONLY]
-TR: TAPE & REEL

TAIL OPTION

-RA1: RIGHT ANGLE-
SHROUD DOWN (SEE FIG. 3)
-RA2: RIGHT ANGLE-
SHROUD UP (SEE FIG. 4)
[AVAILABLE ONLY ON LEAD STYLE -01]

ROW SPECIFICATION

-D: DOUBLE (USE LS2-XX-D-XX)

* = NOT TOOLED

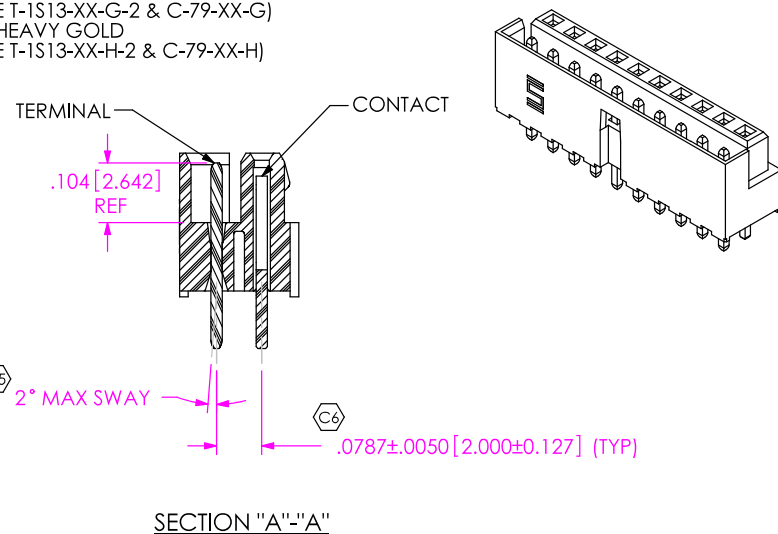

UNLESS OTHERWISE SPECIFIED,
DIMENSIONS ARE IN INCHES.
TOLERANCES ARE:
DECIMALS ANGLES
.XX: ±.01 [.3] 2°
.XXX: ±.005 [.13]
.XXXX: ±.0020 [.051]

PROPRIETARY NOTE

THIS DOCUMENT CONTAINS INFORMATION
CONFIDENTIAL AND PROPRIETARY TO
SAMTEC, INC. AND SHALL NOT BE REPRODUCED
OR TRANSFERRED TO OTHER DOCUMENTS OR
DISCLOSED TO OTHERS OR USED FOR ANY
PURPOSE OTHER THAN THAT WHICH IT WAS
OBTAINED WITHOUT THE EXPRESSED WRITTEN
CONSENT OF SAMTEC, INC.

MATERIAL: DO NOT SCALE DRAWING SHEET SCALE: 3:1
INSULATOR: LCP, COLOR: BLACK
SOCKET: PHOS BRONZE
TERMINAL: PHOS BRONZE



SAMTEC

520 PARK EAST BLVD, NEW ALBANY, IN 47150
* PHONE: 812.944.6733 FAX: 812.948.5047
e-Mail: INFO@SAMTEC.COM CODE: 55322

DESCRIPTION:
2mm TERMINAL/SOCKET COMBO
DWG. NO. LS2-1XX-XX-XX-D-XXX-X

BY: DEAN P 4/24/2002 SHEET 1 OF 4

FIG. 2 J

LS2-110-02-X-D SHOWN
[DIFFERENT AS SHOWN, OTHERWISE SAME AS FIG. 1]

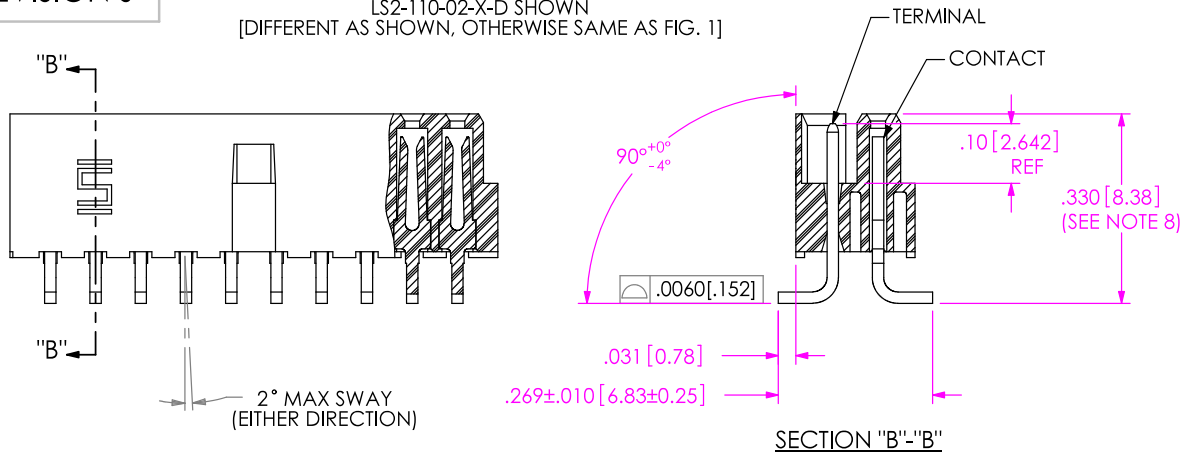

PACKAGING VIEWS

STYLE -01

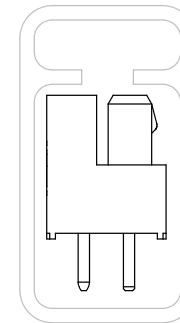

TUBE: PT-1-24-04-09
PLUG: TP-07

STYLE -02 J

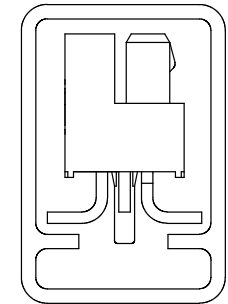

TUBE: PT-1-24-01-123
PLUG: TP-13

STYLE -02-D IN-PROCESS VIEWS

IN-PROCESS 1 J

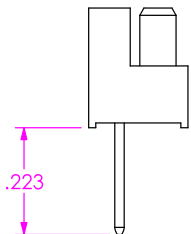

IN-PROCESS 2 J

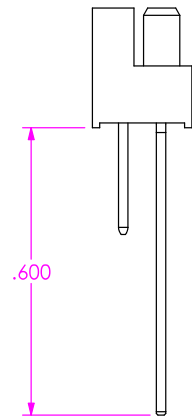

IN-PROCESS 3 J

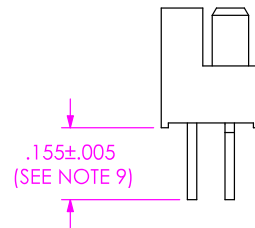
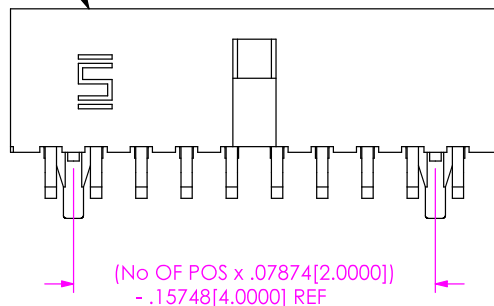

FIG. 6 J

*-A: ALIGNMENT PIN OPTION
LS2-110-02-X-D-A SHOWN
[DIFFERENT AS SHOWN, OTHERWISE SAME AS FIG. 2]

LS2-XX-D-XX-A



*= NOT TOOLED

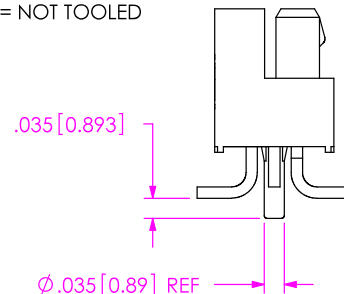

F:\DWG\MISC\MKTG\LS2-1XX-XX-XX-D-XXX-X-MKT.SLDDRW

PROPRIETARY NOTE

THIS DOCUMENT CONTAINS INFORMATION CONFIDENTIAL AND PROPRIETARY TO SAMTEC, INC. AND SHALL NOT BE REPRODUCED OR TRANSFERRED TO OTHER DOCUMENTS OR DISCLOSED TO OTHERS OR USED FOR ANY PURPOSE OTHER THAN THAT WHICH IT WAS OBTAINED WITHOUT THE EXPRESSED WRITTEN CONSENT OF SAMTEC, INC.

DO NOT SCALE DRAWING

SHEET SCALE: 3:1

SAMTEC

520 Park East Blvd. New Albany, IN 47151
Phone (812) 944-6733 Fax (812) 948-5047
e-Mail: INFO@SAMTEC.COM CODE: 55322

DESCRIPTION: 2mm TERMINAL/SOCKET COMBO

DWG. NO. LS2-1XX-XX-XX-D-XXX-X

BY: DEAN P 4/24/2002 SHEET 2 OF 4

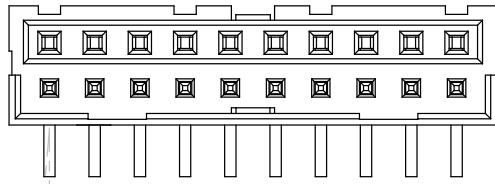

2° MAX SWAY
(EITHER DIRECTION)

FIG. 3

LS2-110-01-X-D-RA1 SHOWN
[DIFFERENT AS SHOWN, OTHERWISE SAME AS FIG. 1]

* AVAILABLE ONLY ON LEAD STYLE -01 *

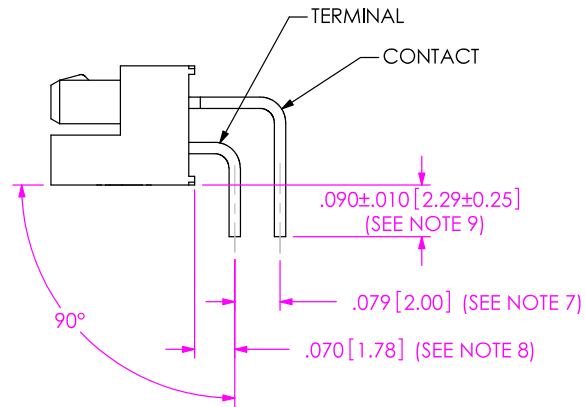

STYLE -01-RA1 IN-PROCESS VIEWS

IN-PROCESS 1

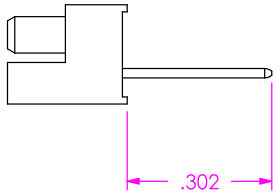

IN-PROCESS 2

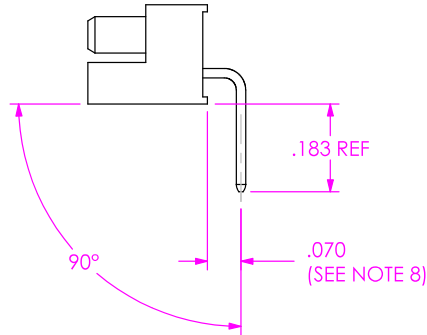

IN-PROCESS 1

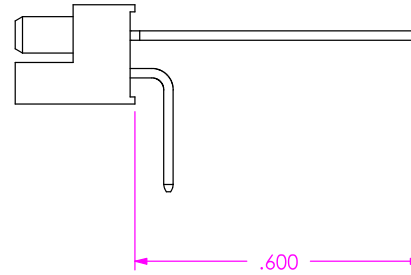

IN-PROCESS 4

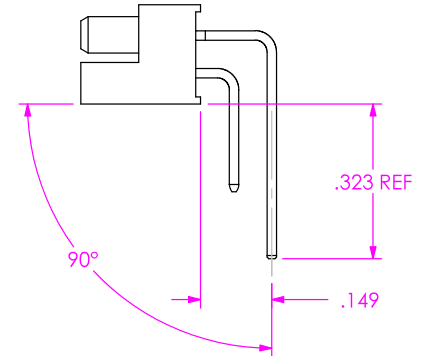

APPLICATION VIEWS

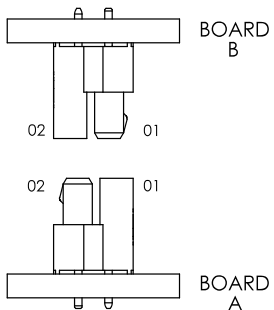

PARALLEL
BOARD-TO-BOARD

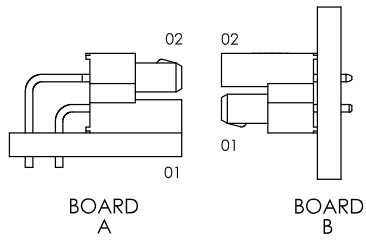

PERPENDICULAR
BOARD-TO-BOARD

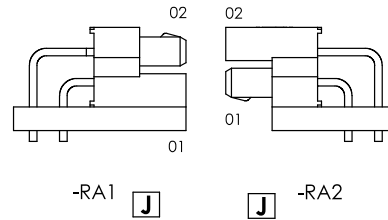

IN-LINE PARALLEL
BOARD-TO-BOARD

PROPRIETARY NOTE

THIS DOCUMENT CONTAINS INFORMATION
CONFIDENTIAL AND PROPRIETARY TO
SAMTEC, INC. AND SHALL NOT BE REPRODUCED
OR TRANSFERRED TO OTHER DOCUMENTS OR
DISCLOSED TO OTHERS OR USED FOR ANY
PURPOSE OTHER THAN THAT WHICH IT WAS
OBTAINED WITHOUT THE EXPRESSED WRITTEN
CONSENT OF SAMTEC, INC.

DO NOT SCALE DRAWING

SHEET SCALE: 3:1

F:\DWG\MISC\MKTG\LS2-1XX-XX-XX-D-XXX-X-MKT.SLDDRW

SAMTEC

520 PARK EAST BLVD, NEW ALBANY, IN 47150
* PHONE: 812.944.6733 FAX: 812.948.5047
e-Mail: INFO@SAMTEC.COM CODE: 55322

DESCRIPTION:
2mm TERMINAL/SOCKET COMBO

DWG. NO.
LS2-1XX-XX-XX-D-XXX-X

BY: DEAN P 4/24/2002 SHEET 3 OF 4

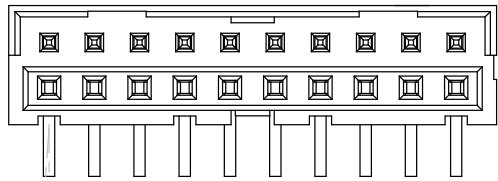

2° MAX SWAY
(EITHER DIRECTION)

FIG. 4 J

LS2-110-01-X-D-RA2 SHOWN
[DIFFERENT AS SHOWN, OTHERWISE SAME AS FIG. 1]

* AVAILABLE ONLY ON LEAD STYLE -01 *

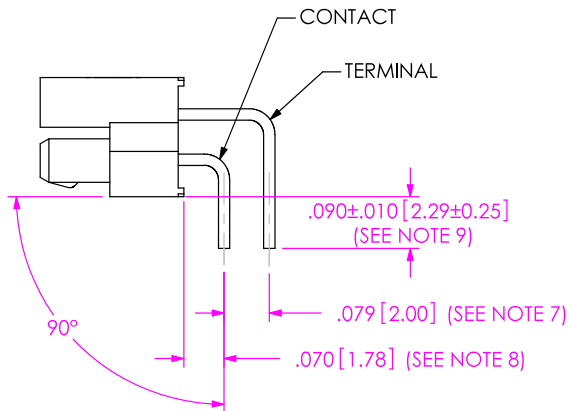

STYLE -01-RA2 IN-PROCESS VIEWS

IN-PROCESS 1 J

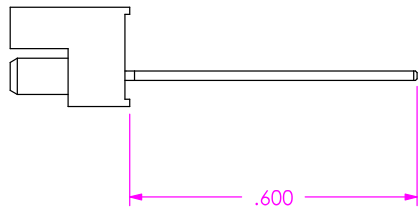

IN-PROCESS 2 J

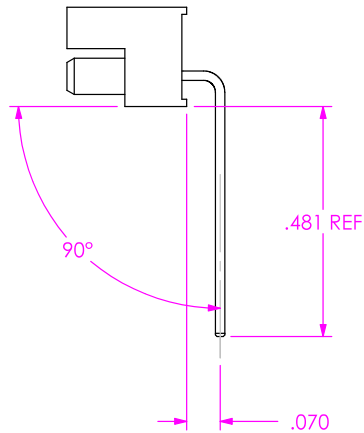

IN-PROCESS 3 J

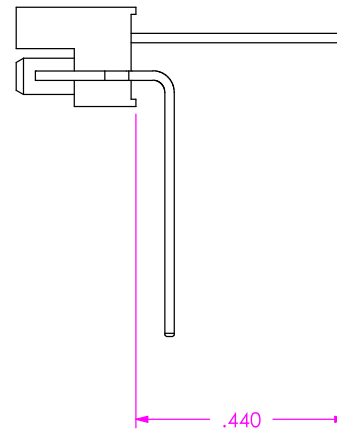

IN-PROCESS 4 J

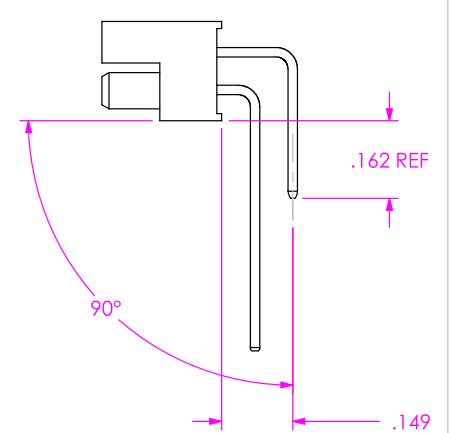
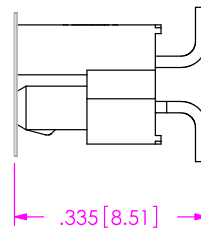
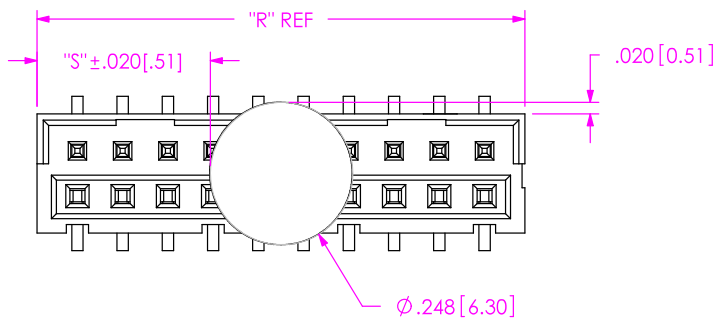

FIG. 5
-K: POLYAMIDE FILM PAD OPTION



NOTE:
"R" = (No OF POS x .07874 [2.0000]) + .06181 [1.570]
"S" = ("R" - .2460 [6.248]) / 2

F:\DWG\MISC\MKTG\LS2-1XX-XX-XX-D-XXX-X-MKT.SLDDRW

PROPRIETARY NOTE

THIS DOCUMENT CONTAINS INFORMATION CONFIDENTIAL AND PROPRIETARY TO SAMTEC, INC. AND SHALL NOT BE REPRODUCED OR TRANSFERRED TO OTHER DOCUMENTS OR DISCLOSED TO OTHERS OR USED FOR ANY PURPOSE OTHER THAN THAT WHICH IT WAS OBTAINED WITHOUT THE EXPRESSED WRITTEN CONSENT OF SAMTEC, INC.

DO NOT SCALE DRAWING

SHEET SCALE: 3:1

SAMTEC

520 PARK EAST BLVD, NEW ALBANY, IN 47150
* PHONE: 812.944.6733 FAX: 812.948.5047
e-Mail: INFO@SAMTEC.COM CODE: 55322

DESCRIPTION:	2mm TERMINAL/SOCKET COMBO
DWG. NO.	LS2-1XX-XX-XX-D-XXX-X
BY: DEAN P	4/24/2002 SHEET 4 OF 4