

T-1 3/4 Super Bright Diffused Lens									
Part Number	Source Color	Wave-length λ_p (nm)	Lens Color	Typical Viewing Angle	Forward Voltage $V_F(V)$ typ max		Luminous Intensity $I_V(mcd)$ min typ		Notes
MV8190		660	Red Diffused	40°	1.7	2.4	63	100	4
MV8191		660	Red Diffused	40°	1.7	2.4	100	200	4

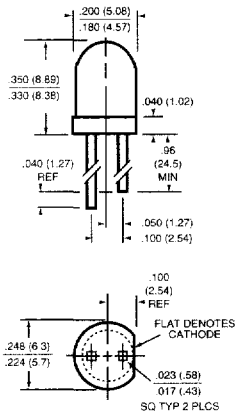

T-1 3/4 Super Bright Tapered Clear Lens									
Part Number	Source Color	Wave-length λ_p (nm)	Lens Color	Typical Viewing Angle	Forward Voltage $V_F(V)$ typ max		Luminous Intensity $I_V(mcd)$ min typ		Notes
MV8713		620	Water Clear	12°	2.1	2.8	630	940	4
MV8714		620	Water Clear	12°	2.1	2.8	1000	1500	4
MV8715		620	Water Clear	12°	2.1	2.8	1600	2400	4
MV8716		620	Water Clear	12°	2.1	2.8	2500	3500	4
MV8111		660	Water Clear	12°	1.7	2.4	250	370	4
MV8112		660	Water Clear	12°	1.7	2.4	630	950	4
MV8113		660	Water Clear	12°	1.7	2.4	1000	1500	4
MV8114		660	Water Clear	12°	1.7	2.4	1600	2400	4
MV8313		590	Water Clear	12°	2.1	2.8	630	940	4
MV8314	Yellow	590	Water Clear	12°	2.1	2.8	1000	1500	4
MV8315		590	Water Clear	12°	2.1	2.8	1600	2400	4
MV8316		590	Water Clear	12°	2.1	2.8	2500	3500	4
MV8410		565	Water Clear	12°	2.1	2.8	160	240	4
MV8411		565	Water Clear	12°	2.1	2.8	250	370	4
MV8412		565	Water Clear	12°	2.1	2.8	400	600	4
MV8813		630	Water Clear	12°	2.1	2.8	630	940	4
MV8814		630	Water Clear	12°	2.1	2.8	1000	1500	4
MV8815		630	Water Clear	12°	2.1	2.8	1600	2400	4
MV8816		630	Water Clear	12°	2.1	2.8	2500	3500	4

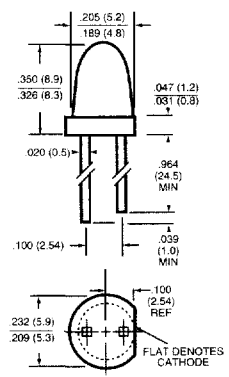

T-1 3/4 Super Bright Clear Lens									
Part Number	Source Color	Wave-length λ_p (nm)	Lens Color	Typical Viewing Angle	Forward Voltage V_F (V)		Luminous Intensity I_V (mcd)		Notes
					typ	max	min	typ	
MV8703	Yellow	620	Water Clear	20°	2.1	2.8	630	940	4
MV8704		620	Water Clear	20°	2.1	2.8	1000	1500	4
MV8705		620	Water Clear	20°	2.1	2.8	1600	2400	4
MV8741		620	Water Clear	45°	2.1	2.8	250	370	4
MV8742		620	Water Clear	45°	2.1	2.8	400	600	4
MV8102		660	Water Clear	20°	1.7	2.4	250	370	4
MV8103		660	Water Clear	20°	1.7	2.4	630	940	4
MV8104		660	Water Clear	20°	1.7	2.4	1000	1500	4
MV8140		660	Water Clear	40°	1.7	2.4	120	220	4
MV8141		660	Water Clear	40°	1.7	2.4	250	370	4
MV8303	Yellow	590	Water Clear	20°	2.1	2.8	630	940	4
MV8304		590	Water Clear	20°	2.1	2.8	1000	1500	4
MV8305		590	Water Clear	20°	2.1	2.8	1600	2400	4
MV8331		590	Water Clear	30°	2.1	2.8	400	600	4
MV8332		590	Water Clear	30°	2.1	2.8	630	940	4
MV8341		590	Water Clear	45°	2.1	2.8	160	220	4
MV8342		590	Water Clear	45°	2.1	2.8	250	370	4
MV8803		Yellow	630	Water Clear	20°	2.1	2.8	630	940
MV8804	630		Water Clear	20°	2.1	2.8	1000	1500	4
MV8805	630		Water Clear	20°	2.1	2.8	1600	2400	4
MV8831	630		Water Clear	30°	2.1	2.8	400	600	4
MV8732	630		Water Clear	30°	2.1	2.8	630	940	4

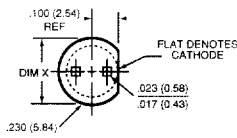
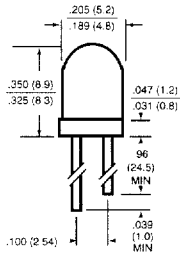

Part Numbers	DIM X	
	MAX	MIN
MV8331/2	.232 (5.9)	.209 (5.3)
MV8303/4/5	.244 (6.2)	.220 (5.6)
MV810X	.248 (6.3)	.224 (5.7)
MV814X/MV834X		
MV870X/MV874X		

T-1 3/4 Super Bright Blue LED									
Part Number	Source Color	Wave-length λ_p (nm)	Lens Color	Typical Viewing Angle	Forward Voltage V_F (V)		Luminous Intensity I_V (mcd)		Notes
					typ	max	min	typ	
MV8B01	Blue	430	Water Clear	24°	4.9	5.5	400	1000	4
MV8B11					12°	4.9	5.5	630	1500

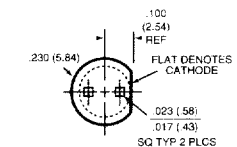
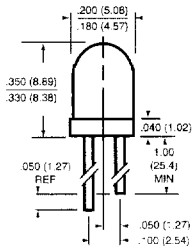

Notes

4. V_F & I_V @ $I_F = 20$ mA
 HER = High Efficiency Red