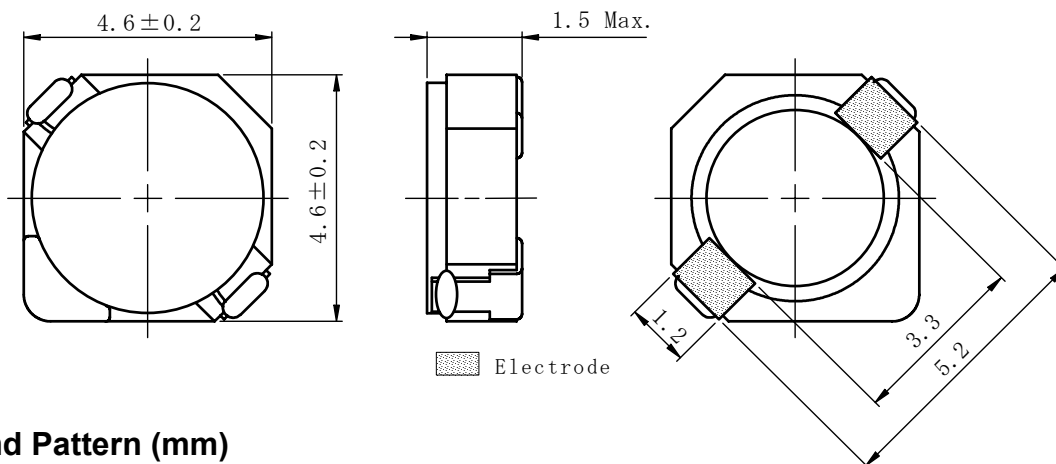
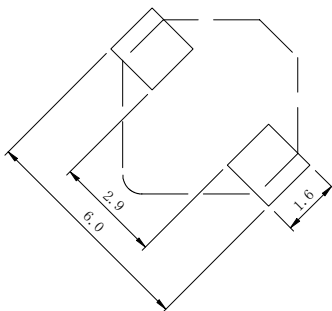

**Type: CDRH4D14, CDRH4D14/HP, CDRH4D14/LD**
**◆ Product Description**

- 4.8×4.8mm Max.(L×W),1.5mm Max.Height.
- Standard type CDRH4D14 High Power typeCDRH4D14/HP and Low DCR type CDRH4D14/LD are available.
- Inductance Range: 1.2~68  $\mu$  H ( Standard type), 1.8~33  $\mu$  H (High Power type). 2.2~220  $\mu$  H(Low DCR type),
- Rated current range: 0.28~1.9A (Standard type), 0.39~2.25A (High Power type); 0.11~1.05A(Low DCR type).
- In addition to the standards versions shown here, custom inductors are also available to meet your exact requirements.

**◆ Feature**

- Magnetically shielded construction.
- Ideally used in Mobilephone,PDA,MP3,DSC/DVC,etc as DC-DC Converter inductors.
- RoHS Compliance.

**◆ Dimensions (mm)**

**◆ Land Pattern (mm)**

**Type: CDRH4D14, CDRH4D14/HP, CDRH4D14/LD**
**◆ Specification(CDRH4D14)**

Part Name ※	Stamp	Inductance ( $\mu$ H) [Within] 100kHz/1V	D.C.R.(m $\Omega$ ) Max.(Typ.) (at 20°C)	Saturation Current (mA) ※1		Temperature Rise current (mA) ※2
				(at 20°C)	(at100°C)	
CDRH4D14NP-1R2N□	1R2	1.2±30%	33(27)	1900	1200	2600
CDRH4D14NP-2R2N□	2R2	2.2±30%	48(39)	1600	1100	2350
CDRH4D14NP-3R0N□	3R0	3.0±30%	63(51)	1400	1000	2150
CDRH4D14NP-4R7N□	4R7	4.7±30%	90(72)	1100	800	1550
CDRH4D14NP-6R8N□	6R8	6.8±30%	125(100)	900	690	1200
CDRH4D14NP-8R2N□	8R2	8.2±30%	175(138)	750	600	990
CDRH4D14NP-100M□	100	10±20%	185(150)	730	570	900
CDRH4D14NP-120M□	120	12±20%	245(193)	640	480	800
CDRH4D14NP-150M□	150	15±20%	270(220)	590	440	740
CDRH4D14NP-220M□	220	22±20%	400(320)	500	350	630
CDRH4D14NP-330M□	330	33±20%	560(450)	410	290	500
CDRH4D14NP-470M□	470	47±20%	780(630)	350	240	420
CDRH4D14NP-560M□	560	56±20%	1085(867)	300	220	360
CDRH4D14NP-680M□	680	68±20%	1200(960)	280	200	330

**◆ Specification(CDRH4D14/HP)**

Part No. ※	Stamp	Inductance ( $\mu$ H) [Within] 100kHz/1V	D.C.R.(m $\Omega$ ) Max.(Typ.) (at 20°C)	Saturation Current(mA) ※1	Temperature rise current (mA) ※2
CDRH4D14HPNP-1R8N□	1R8	1.8±30%	50(40)	2250	2300
CDRH4D14HPNP-2R4N□	2R4	2.4±30%	70(56)	2000	1800
CDRH4D14HPNP-3R0N□	3R0	3.0±30%	91(73)	1800	1600
CDRH4D14HPNP-4R7N□	4R7	4.7±30%	140(115)	1400	1100
CDRH4D14HPNP-6R8N□	6R8	6.8±30%	190(155)	1150	920
CDRH4D14HPNP-100M□	100	10±20%	280(230)	950	750
CDRH4D14HPNP-150M□	150	15±20%	410(330)	750	620
CDRH4D14HPNP-220M□	220	22±20%	620(500)	620	520
CDRH4D14HPNP-330M□	330	33±20%	930(750)	510	390

**Type: CDRH4D14, CDRH4D14/HP, CDRH4D14/LD**
**◆ Specification(CDRH4D14/LD)**

Part No. ※	Stamp	Inductance [Within] 1 00kHz/1V	D.C.R.(Ω) Max.(Typ.) (at 20°C)	Saturation Current (A) ※1	Temperature rise current (A) ※2
CDRH4D14LDNP-2R2N□	2R2	2.2 μ H±30%	40m(32m)	1.05	2.60
CDRH4D14LDNP-3R0N□	3R0	3.0 μ H±30%	50m(40m)	0.98	2.30
CDRH4D14LDNP-4R7N□	4R7	4.7 μ H±30%	66m(53m)	0.78	1.90
CDRH4D14LDNP-6R8N□	6R8	6.8 μ H±30%	96m(77m)	0.64	1.55
CDRH4D14LDNP-100M□	100	10 μ H±20%	135m(110m)	0.52	1.08
CDRH4D14LDNP-150M□	150	15 μ H±20%	210m(170m)	0.42	0.88
CDRH4D14LDNP-220M□	220	22 μ H±20%	300m(240m)	0.35	0.73
CDRH4D14LDNP-330M□	330	33 μ H±20%	420m(340m)	0.28	0.56
CDRH4D14LDNP-470M□	470	47 μ H±20%	570m(460m)	0.24	0.48
CDRH4D14LDNP-680M□	680	68 μ H±20%	870m(700m)	0.21	0.41
CDRH4D14LDNP-101M□	101	100 μ H±20%	1.35(1.10)	0.16	0.32
CDRH4D14LDNP-151M□	151	150 μ H±20%	2.05(1.65)	0.14	0.23
CDRH4D14LDNP-221M□	221	220 μ H±20%	2.65(2.15)	0.11	0.20

**※ Description of part name.**

CDRH4D14LDNP-2R2N□

- B Box
- C Carrier Tape

※1.Saturation Current: The DC current at which the inductance decreases to 65% of it's nominal value

※2 Temperature rise current: The DC current at which the temperature rise is  $\Delta t=40^{\circ}\text{C}$ .( $T_a=20^{\circ}\text{C}$ )