

IC SOCKETS

Solder Tail

- Four leaf beryllium copper contact for high reliability.
- Low mounting profile of 4.3mm.
- End and side stackable on 2.54 centres.
- Open frame allows mounting of components under IC's.

All contacts have nickel undercoat.
 Accepts IC leads $\varnothing 0.41$ to $\varnothing 0.53$. Pin length 2.4 to 3.0mm

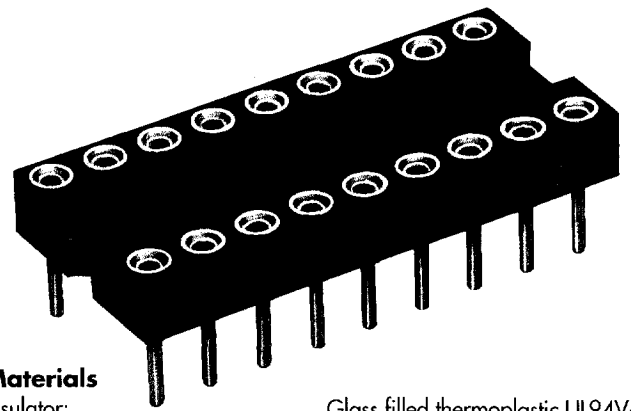

Materials

Insulator:	Glass filled thermoplastic UL94V-0
Outer shell:	Brass
Inner contact:	Beryllium copper
Plating finish:	01-Tin/lead shell, gold plated 21-Tin/lead shell, gold flash

DIMENSIONS

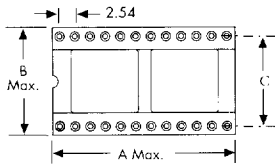

D27, D28, D29XX-XX

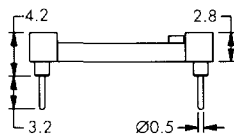

D73064-XX

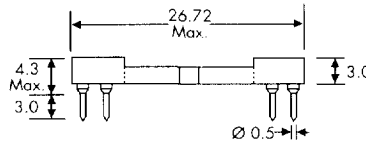

D8864-01

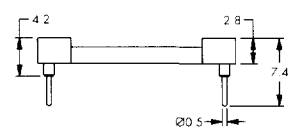

No. of Contacts	Outline	A	B	C	Order Code	No. of Contacts	Outline	A	B	C	Order Code
6		7.62	10.16	7.62	D2806-01	24		30.48	10.16	7.62	D2924-01
6		7.62	10.16	7.62	D2806-21	24		30.48	10.16	7.62	D2924-21
8		10.16	10.16	7.62	D2808-01	24		30.48	12.70	10.16	D2724-01
8		10.16	10.16	7.62	D2808-21	24		30.48	12.70	10.16	D2724-21
14		17.78	10.16	7.62	D2814-01	28		35.62	17.78	15.24	D2828-21
14		17.78	10.16	7.62	D2814-21	28		35.62	17.78	15.24	D2828-01
16		20.32	10.16	7.62	D2816-01	32		40.64	17.78	15.24	D2832-01
16		20.32	10.16	7.62	D2816-21	32		40.64	17.78	15.24	D2832-21
18		22.86	10.16	7.62	D2818-01	40		50.80	17.78	15.24	D2840-01
18		22.86	10.16	7.62	D2818-21	40		50.80	17.78	15.24	D2840-21
20		25.40	10.16	7.62	D2820-01	48		61.00	17.78	15.24	D2948-01
20		25.40	10.16	7.62	D2820-21	48		61.00	17.78	15.24	D2948-21
22		27.94	12.70	10.16	D2822-01	64		81.28	25.28	22.86	D2864-01
22		27.94	12.70	10.16	D2822-21	64		81.28	25.28	22.86	D2864-21
22		27.94	10.16	7.62	D2922-01	64	Quad in line	42.1	26.72	19.05	D73064-01
22		27.94	10.16	7.62	D2922-21	64	Quad in line	42.1	26.72	19.05	D73064-21
24		30.48	17.78	15.24	D2824-01	64	Shrink Dip	57.76	21.7	19.05	D8864-01
24		30.48	17.78	15.24	D2824-21						

ORDER CODE

For sizes and finishes not shown please use the following order code:

Example:

D2828-T6 Tin 28 way Solder Tail Socket.

D2	XX-	XX
Style	No of Ways	Finish
		01-Tin/Gold
		T6 - Tin/tin
		05 - Gold/Gold