

Flange Mount Connectors

**Flange Mount Jack, Non-Captive Contact**

Part Number	Cable Number
<b>Narrow Flange</b>	
050-E04-9702210	RG405/U

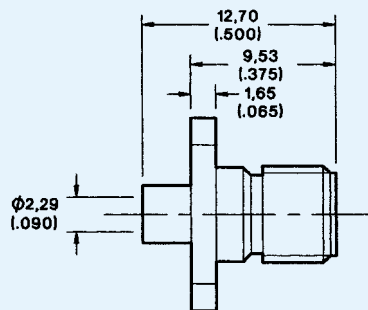

Assembly Instruction AI-770 (Page 128)

**Flange Mount Jack Receptacle**

Part Number  
Narrow Flange  
050-E45-0000210

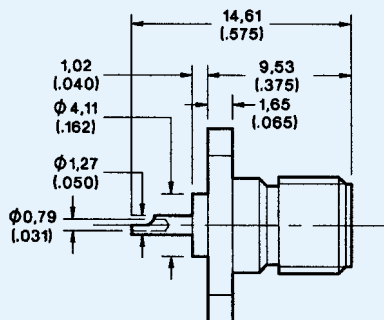

Flange mounting details are shown on page 13.

SMA