

NOTES:

1. MATERIAL:

A. CDA 260 BRASS, .008/(0.20) THICK.

B. CDA 510 PHOS. BRONZE .008/(0.20) THICK.

2. PLATING:

.000100/(.00254) MIN. TIN OVER .000050/(.00127) MIN. NICKEL (POST-PLATE).

3. PART DESIGNED IN METRIC.

4 THE NUMBER OF SERRATIONS TO BE ONE FOR WIRE RANGE 22-28.

5 MEASURING POINT FOR PLATING THICKNESS.

6. TERMINAL IS FOR USE WITH MOLEX PLUG HOUSINGS 5559, 30068, AND 42475.

7. PRODUCT SPECIFICATION: PS-5556-001, PS-5556-002, PS-5556-003

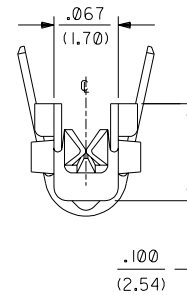
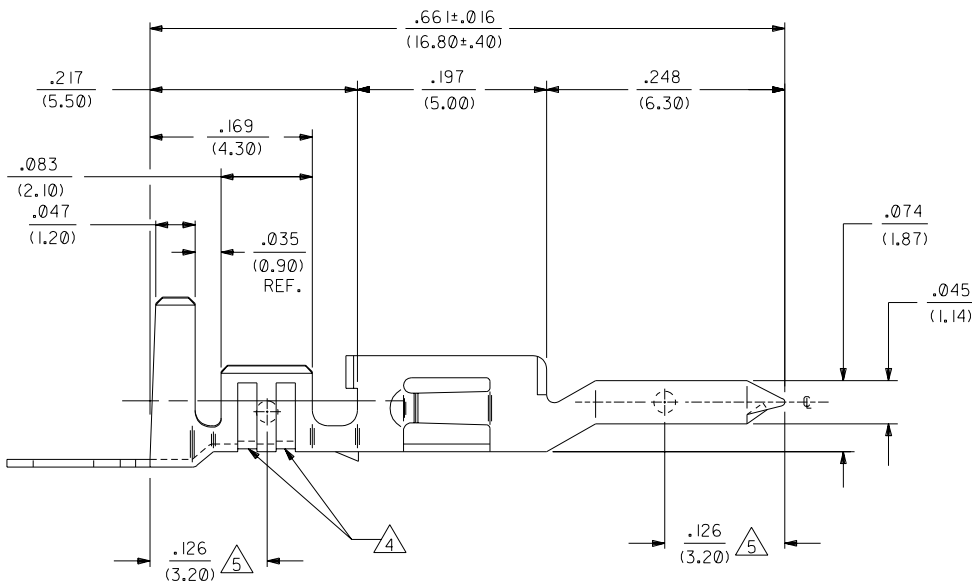
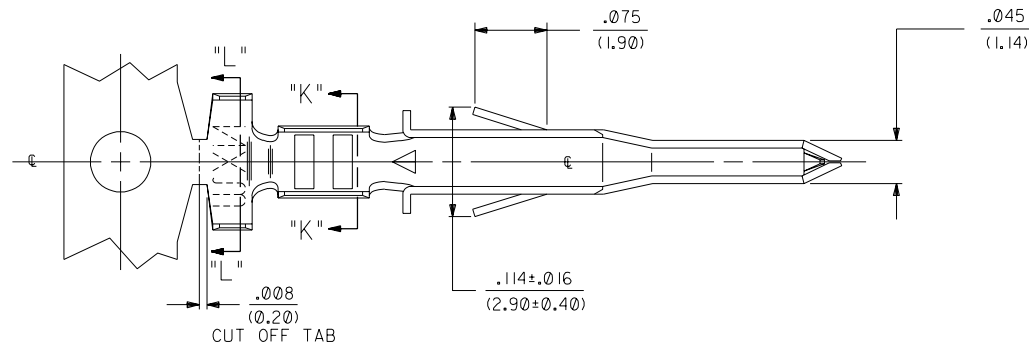
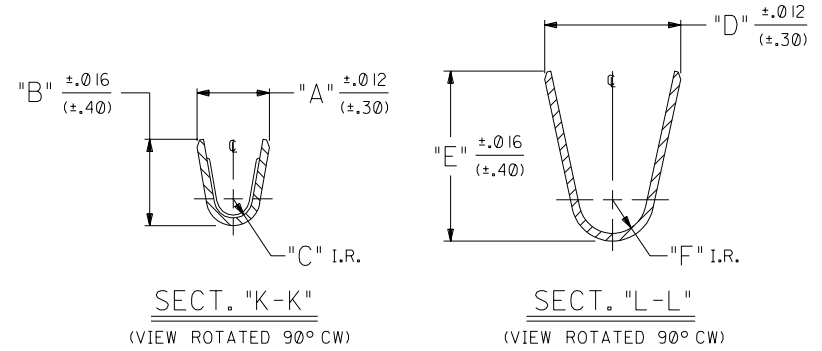

C	ADD. PS NOTE UCP2003-0385 8/30/2002 SAMIEC
B	REV 28-30 GA. DIM ECN #140405 94-04-06 A.GUJZIK
A2	ADDED EDP'S PER ECN U21527 GEP 10-15-92 RJF
A1	REVISED 28-30 AWG ECN U21318 9-3-92 RJF
A	FINAL RELEASE PER ECN U20768 6-12-92 RJF

DIMENSIONS SHOWN (METRIC) INCH		▽ = 0		▼ = 0		REVISE ONLY ON CAD SYSTEM	
UNLESS OTHERWISE SPECIFIED TOLERANCES: ANGULAR ± 1/2°							
3 PLACE ± .010		---		INCH		METRIC	
2 PLACE ± .015		± .25		---		---	
1 PLACE ---		± .38		---		---	
DRAFT WHERE APPLICABLE MUST REMAIN WITHIN DIMENSIONS							
DRWG. BY: RJF		CHK'D. BY: GEP		FILE NAME: 55555SX1		SHEET NO. DATE	
APP'D. BY: RAS		SCALE: 10:1		MOLEX INCORPORATED		1 OF 2 5/12/92	
				LITSE,ILL. 60532		U.S.A.	
PART NO. SEE SHT. 2				DRWG. NO. SD-5558-S*			
THIS DRAWING CONTAINS INFORMATION THAT IS PROPRIETARY TO MOLEX INC. AND SHOULD NOT BE USED WITHOUT WRITTEN PERMISSION.							

5558

CP C

		13	12	11	10	9	8	7	6	5558		4	3	2	1		
J		PART NO.	ENG. NO.	FORM	MAT'L.	WIRE GAGE	RANGE OF INSULATION DIA.	QUANTITY PER REEL (FORMED)	DIM. "A"	DIM. "B"	DIM. "C"	DIM. "D"	DIM. "E"	DIM. "F"	J		
J		39-00-0120	5558-S	CHAIN	A	18-24 GA.	.051-.122	4,000	.075	.091	.020	.142	.177	.035	J		
		39-00-0121	5558-SL	LOOSE			(1.30-3.10)	(1.90)	(2.30)	(1.50)	(3.60)	(4.50)	(.90)	J			
		39-00-0122	5558-S2	CHAIN			22-28 GA.	.035-.071	6,000	.071	.065	.016	.091			.024	J
	39-00-0123	5558-S2L	LOOSE	(.90-1.80)		(1.80)		(1.65)	(.40)	(2.30)	(2.30)	(.60)	I				
	39-00-0124	5558-S3	CHAIN	B		16 GA.		.122	4,000	.091	.106	.024		.142	.177	.035	
	39-00-0125	5558-S3L	LOOSE				(3.10) MAX.	(2.30)	(2.70)	(.60)	(3.60)	(4.50)		(.90)	I		
	NOT TOOLED	5558-S4	CHAIN		14 GA.		.122	4,000	.091	.114	.024	.142	.177	.035		H	
	NOT TOOLED	5558-S4L	LOOSE			(3.10) MAX.	(2.30)	(2.90)	(.60)	(3.60)	(4.50)	(.90)	H				
	39-00-0259	5558-S5	CHAIN			B	28-30 GA.	.020-.035	6,000	.050	.044	.010		.091	.024		H
	39-00-0260	5558-S5L	LOOSE		(.50-.90)			(1.27)	(1.12)	(.25)	(2.30)	(2.30)		(.60)	H		
	39-00-0126	5558-PBS	CHAIN	B	18-24 GA.			.051-.122	4,000	.075	.091	.020	.142	.177		.035	
	39-00-0127	5558-PBSL	LOOSE				(1.30-3.10)	(1.90)	(2.30)	(1.50)	(3.60)	(4.50)	(.90)	H			
	39-00-0128	5558-PBS2	CHAIN				22-28 GA.	.035-.071	6,000	.071	.065	.016	.091		.024	H	
	39-00-0129	5558-PBS2L	LOOSE		(.90-1.80)			(1.80)	(1.65)	(.40)	(2.30)	(2.30)	(.60)		G		
	39-00-0130	5558-PBS3	CHAIN		B	16 GA.		.122	4,000	.091	.106	.024	.142	.177			.035
	39-00-0131	5558-PBS3L	LOOSE				(3.10) MAX.	(2.30)	(2.70)	(.60)	(3.60)	(4.50)	(.90)	G			
	NOT TOOLED	5558-PBS4	CHAIN	14 GA.			.122	4,000	.091	.114	.024	.142	.177		.035	G	
	NOT TOOLED	5558-PBS4L	LOOSE			(3.10) MAX.	(2.30)	(2.90)	(.60)	(3.60)	(4.50)	(.90)	G				
	39-00-0263	5558-PBS5	CHAIN			B	28-30 GA.	.020-.035	6,000	.050	.044	.010		.091	.024		G
	39-00-0264	5558-PBS5L	LOOSE	(.50-.90)				(1.27)	(1.12)	(.25)	(2.30)	(2.30)		(.60)	G		
F																	
E																	
D																	
C																	
B																	
A																	

LEGEND:

5558-**S**

- BASE NO. _____
- MATERIAL _____
- BLANK= BRASS
- PB= PHOS. BRONZE
- S= TIN OVER NICKEL
- CRIMP SIZE _____
- BLANK = 18-24 AWG
- 2 = 22-28 AWG
- 3 = 16 AWG
- 4 = 14 AWG
- 5 = 28-30 AWG
- CHAIN OR LOOSE _____
- BLANK= CHAIN
- L= LOOSE

5558

B	SEE SHEET L
A2	SEE SHEET L
A1	SEE SHEET L
A	SEE SHEET L

DIMENSIONS SHOWN (METRIC) INCH		▽ = 0		▽ = 0		REVISE ONLY ON CAD SYSTEM	
UNLESS OTHERWISE SPECIFIED TOLERANCES ANGULAR ± 1/2°							
INCH		METRIC		TITLE			
3 PLACE	± .001	---	---	MALE CRIMP TERMINAL WITH TIN OVER NICKEL POSTPLATE (MINI-FIT JR. SERIES)			
2 PLACE	± .005	±	---	MOLEX INCORPORATED			
1 PLACE	± .010	±	---	LITTLE, J.L.L.			
DRAFT WHERE APPLICABLE MUST REMAIN WITHIN DIMENSIONS				SHEET NO. 2		DATE 5/12/92	
DRWG. BY: RJF		CHK'D BY: GEP		PART NO. SD-5558-S*		DRWG. NO.	
APP'D BY: RAS		SCALE: --		FILE NAME: 55558SX2		DIN. SIZE: CP C	
THIS DRAWING CONTAINS INFORMATION THAT IS PROPRIETARY TO MOLEX INC. AND SHOULD NOT BE USED WITHOUT WRITTEN PERMISSION.							