

DASH NO.	M CODE	MADE FROM
----------	--------	-----------

GSD

125-104-5

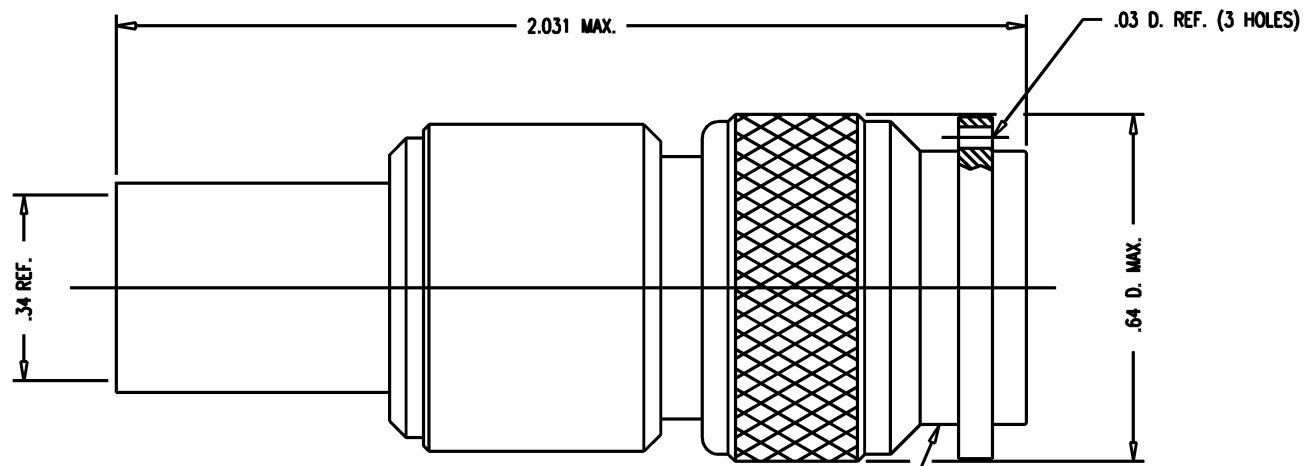

STAMP: KINGS 125-104-5

- NOTES:**
- FOR USE WITH DOUGLAS D2348-1 CABLE.
 - FOR CABLING INSTRUCTIONS SEE CP-5402.
 - FOR CRIMPING USE DIE KTH-2012.
 - INTERFACE PER MIL-STD-348, FIG. 313-1.
 - CENTER CONTACT (1-761-21M9D) SUPPLIED UNASSEMBLED.
 - MARK PACKAGE: 91836
KINGS 125-104-5
YRWK (DATE CODE)
DOUGLAS 500490-2
 - MATERIALS:**
INSULATOR: TEFLON, ASTM-D-4894
K-GRIP SLEEVE: COM. BRONZE, ASTM-B-135
OUTER CONTACT: BER. COPPER, ASTM-B-196
GASKET: SILICONE RUBBER, ZZ-R-765
C-RING: PHOSPHOR BRONZE, ASTM-B-103
ALL OTHER METAL PARTS: BRASS, ASTM-B16
 - FINISHES:**
CENTER CONTACT: GOLD PLATE, PER MIL-G-45204
ALL OTHER METAL PARTS: SILVER PLATE PER QQ-S-365
 - ELECTRICAL CHARACTERISTICS:**
NOMINAL IMPEDANCE: 50 OHMS
WORKING VOLTAGE: 500 VRMS
FREQUENCY RANGE: DC TO 11 GHz

REVISIONS	
ISSUE	CHANGES
0	ER 36809 KH 02/08/96
1	CN 36850 A CCT 02/28/96
2	CN 36927 C MJB 04/15/96
3	CN 38462 E JPK 11/27/01
4	CN 38941 E DCT 10/2/3
5	CN 39126 E JLA 08/04/04

125-104-5SD

SCALE	4:1		
APPROX SURFACE AREA			
WAS:	E-19111		
USED ON			
REF:	Mc D. D. AIRCRAFT / 500490-2 REV. E		
PLUG, TNC			
DRAWN	KH	DATE	02/08/96
DESIGN	CT	DATE	02/09/96
APPR.		DATE	



ROCK HILL, SOUTH CAROLINA 29730

GSD

125-104-5

- UNLESS OTHERWISE SPECIFIED**
- | | | |
|--|---|--|
| 1. TOLERANCES: FRACTIONS & 2 PLACE DECIMALS ± .010
3 PLACE DECIMALS ± .004 ANGLES ± 1°
CONCENTRICITY OF ANY 2 DIAMETERS MAY NOT EXCEED HALF THE SUM OF THEIR TOLERANCES. | 2. REMOVE ALL BURRS, BREAK SHARP EDGES .005 MAX.
3. NO FILLETS PERMITTED.
4. SURFACE ROUGHNESS 63 MICRONS RMS MAX.
5. ALL DIMENSIONS PRIOR TO PLATING.
6. ALL PLATING IN ACCORDANCE WITH KER 10004. | 7. ALL LEAD THREADS TO BE CHAMFERED 45° TO ROOT DIAMETER.
* CRITICAL DIMENSIONS |
|--|---|--|