

6

5

4

3

2

1

MATERIAL AND FINISH:

Insulator: Polycarbonate, UL-94V-0 rated
Contacts: Brass, Nickel plated

ELECTRICAL SPECIFICATIONS:

Current rating: 10 A
Voltage rating: 250 VAC
Insulation resistance: 100 Mohm min. at 500 VDC
Dielectric withstanding voltage: 2000 VAC for one minute

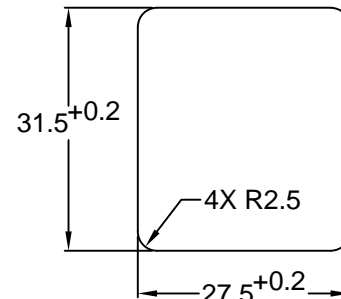
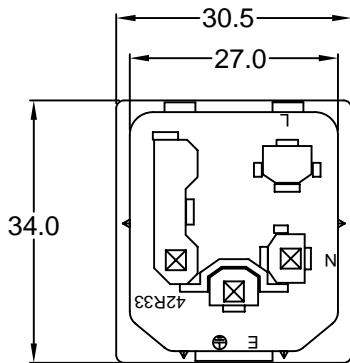

RECOMMENDED PANEL CUTOUT



ORDERING CODE:

42R33-3 2 -
 1 2 3

1) COLOR

- 1 = BLACK
- 2 = GRAY

2) ELECTRICAL CIRCUIT CONFIGURATION

- 1 = 10A 250V 70°C 2+GROUND 
- 2 = 10A 250V 120°C 2+GROUND 
- 4 = 10A 250V 70°C 2 POLE 

3) PANEL THICKNESS

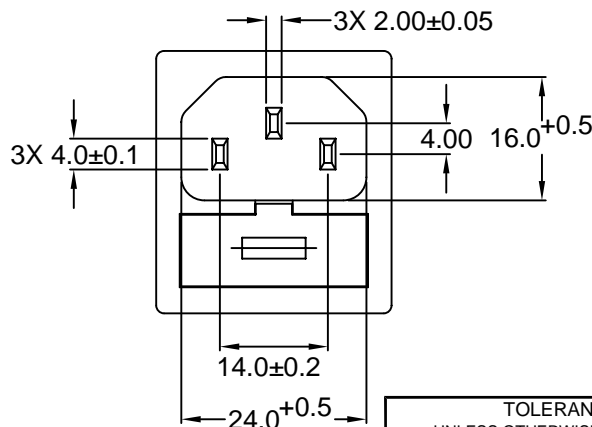
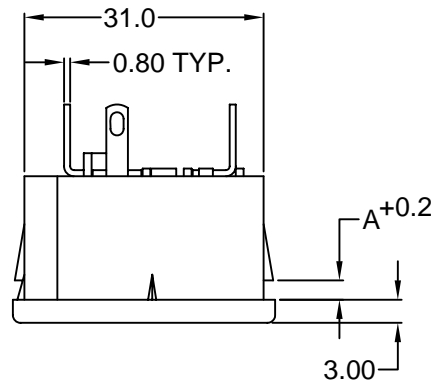
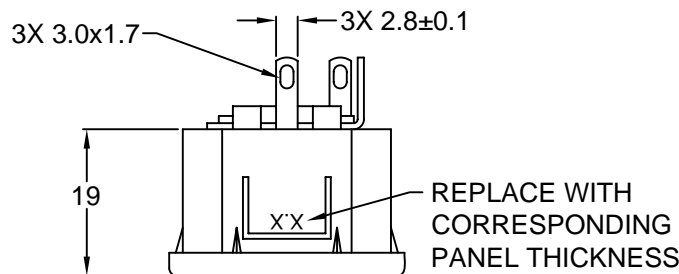

P/N	A	MAX. PANEL THICKNESS
42R33-3X2X-150	1.5	1.5
42R33-3X2X-200	2.0	2.0
42R33-3X2X-250	2.5	2.5

ADDITIONAL PANEL THICKNESS AVAILABLE ON REQUEST

Power Dynamics, Inc.

Phone: 973 560-0019 Whippany, New Jersey Fax: 973 560-0076

PART: IEC 60320 SINGLE FUSE HOLDER APPL.
INLET; SOLDER TERMINALS; SNAP-IN

42R33-3X2X-XXX SHEET 1 of 1

SCALE: NTS ALL DIMENSIONS FOR REFERENCE ONLY
DIMENSIONS ARE IN MILLIMETERS

TOLERANCE UNLESS OTHERWISE SPECIFIED	
X	± 1
X.X	± 0.4
X.XX	± 0.20
DRAWN BY	GQ
CHECK BY	TD
DATE:	09/12/01
DATE:	09/12/01
DATE:	09/12/01

RoHS COMPLIANT

REVISIONS	CHANGE	CHK	CHK	APPR
REV	DATE			

6

5

4

3

2

1