

SENSITRON **SEMICONDUCTOR**

TECHNICAL DATA DATA SHEET 561, REV. -

704-15K36
704-15K36T

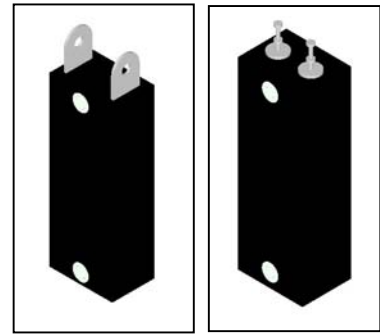

Transient Voltage Suppressor, Unidirectional

704-15K36

704-15K36T

FEATURES:

- ◆ Equivalent Industry Standard Part Numbers – 704-15K36 & 704-15K36T
- ◆ Designed For MIL-STD-704
- ◆ 28 Volt Power Supply Protection
- ◆ Can be supplied with JAN/JANTX parts

This series is primarily for use in avionics equipment. It meets all applicable environmental requirements of MIL-S-19500. These 15kW assemblies are designed typically to operate with a minimum source impedance of .25 Ohms for transients.

MAXIMUM RATINGS

Rating	Condition	Minimum	Maximum	Units
Peak Pulse Power Dissipation	@ 25°, 1ms	-	15,000	Watts
Steady State Power Dissipation	-	-	10	Watts
$t_{clamping}$	0 Volts to $V_{(BR)}$	-	$< 1 \times 10^{-12}$	Seconds
Operating & Storage Temp.	-	-65	+ 150	°C
Forward Surge Current	1/120 sec. @ 25°C	-	300	Amps
Duty Cycle	-	-	0.01	%

ELECTRICAL CHARACTERISTICS @ 25° (Test Both Polarities)

Part Number	Reverse Stand-Off Voltage (Note 1) V_{WM} Volts	Maximum Reverse Leakage @ V_{wm} I_D μA	Minimum Breakdown Voltage @ 10 mA $V_{(BR)}$ Volts	Maximum Clamping Voltage @ I_{PP} V_c Volts	Maximum Peak Pulse Current (Fig. 2) I_{PP} Amps	Maximum Forward Voltage V_F @ 8.3 msec. 100A Volts DC
704-15K36	31.5	100	36	51	300	3.0
704-15K36T	31.5	100	36	51	300	3.0

Note 1: A device is normally selected according to the reverse "Stand Off Voltage" (V_{WM}) which should be equal to or greater than the DC or continuous peak operating voltage level. Special Voltages available from the factory.

TECHNICAL DATA
DATA SHEET 561, REV. -

MECHANICAL CHARACTERISTICS

CASE: Molded Case
 TERMINAL: Silver Plated Brass
 POLARITY: Cathode terminal marked with a dot
 WEIGHT: 38 grams
 MOUNTING POSITION: Any

MECHANICAL DIMENSIONS: In Inches / mm

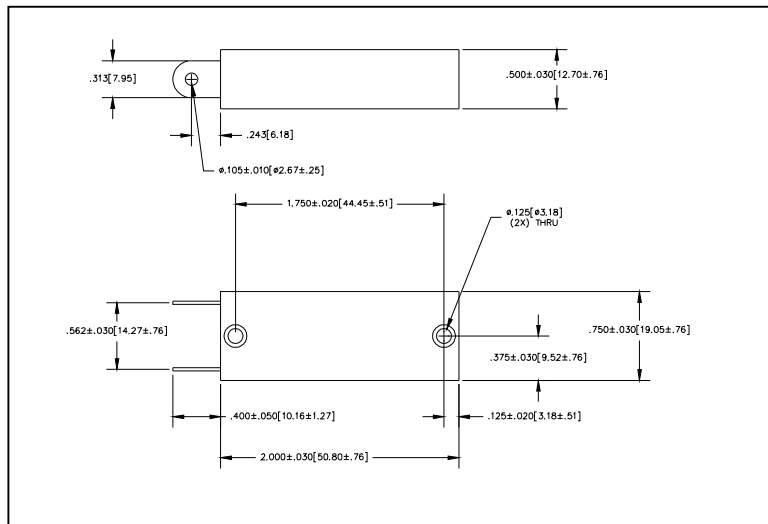

Flat Leads

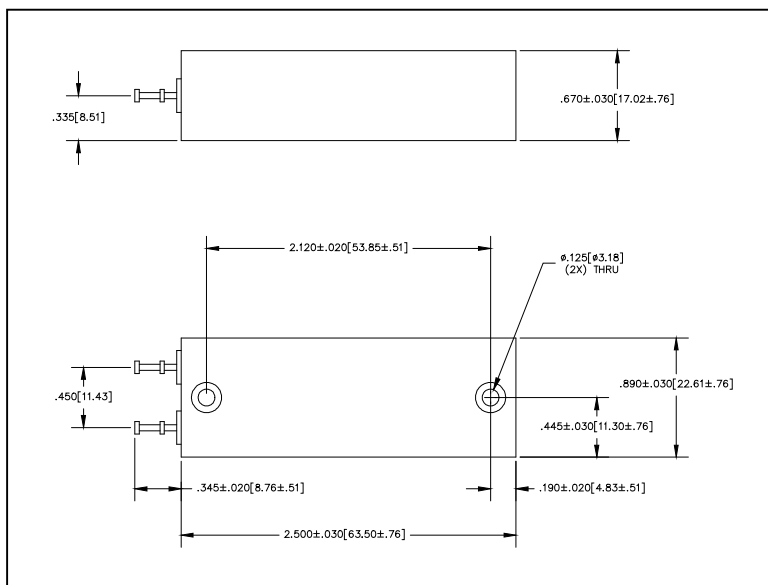

Turret Leads

**SUBMODULE SCREENING TEST PLAN
For Modules H1, H2, and H3**

Test	Condition	MIL-STD-750 Test Method
Storage	TA = +175C for 24 hours	1032
Temp Cycle	-65C to +175C, 20 cycles, 15 minutes each extreme	1051
Acceleration	20KG, Y1 axis, no hold time	2006
Electrical	Reverse Current (IR) @ rated VR Breakdown voltage (BV) @ IZ	4016 4022
Pulse	20 pulses @ rated Ipp tp = 10µS X 1000µS	
Electrical	Reverse Current (IR) @ rated VR	4016
Burn - In	TA = +125C @ rated VR for 96 hours	1038
Electrical	Reverse Current (IR) @ rated VR D-IR = 50% or 1µA, whichever is > Breakdown voltage (BV) @ IZ D-BV = +-2% from initial reading	4016 4022
Fine Leak	5 X 10-8 atmcc/sec	1071G/H
Gross Leak	T = +125C for 1 min, no bubbles	1071C/D
Group A	Reverse Current (IR) @ rated VR Breakdown voltage (BV) @ IZ Clamping voltage (VC) @ Ipp tp = 10µS X 1000µS Forward voltage (VF) @ IF tp = 8.3 msec	4016 4022 4011

NOTE: For bidirectional devices test both polarities-split hours on Burn-in test and surge pulses to 50% each polarity.

Attributes Data Supplied
Module - H1, H2, H3

**MODULE SCREENING TEST PLAN
For Module H1**

<u>Test</u>	<u>MIL-STD-750 Test Method</u>
Group A Electricals	4016, 4022
Attributes Data Supplied Module - H1	

**MODULE SCREENING TEST PLAN
For Module H2**

<u>Test</u>	<u>Condition</u>	<u>MIL-STD-750 Test Method</u>
Storage	TA = +150C for 24 hours	1032
Temp Cycle	-65C to +150C, 10 cycles, 30 minutes each extreme	1051
Electrical	Reverse Current (IR) @ rated VR Breakdown voltage (BV) @ IZ	4016 4022
Pulse	20 pulses @ rated Ipp tp = rated	
Electrical	Reverse Current (IR) @ rated VR	4016
Burn - In	TA = +125C @ rated VR for 96 hours	1038
Electrical	Reverse Current (IR) @ rated VR D-IR = 50% or 1 μ A, whichever is > Breakdown voltage (BV) @ IZ D-BV = +-2% from initial reading	4016 4022
Group A	Reverse Current (IR) @ rated VR Breakdown voltage (BV) @ IZ Clamping voltage (VC) @ Ipp tp = rated Forward voltage (VF) @ IF tp = 8.3 msec	4016 4022 4011

NOTE: For bidirectional devices test both polarities-split hours on Burn-in test and surge pulses to 50% each polarity.

Attributes Data Supplied
Module - H2

**MODULE GROUP B TESTING
For Module H3**

<u>Test</u>	<u>Condition</u>	<u>MIL-STD-750 Test Method</u>
<u>SUBGROUP 1:</u>		
Solderability		2026
Resistance to solvents		1022
<u>SUBGROUP 2:</u>		
Temp Cycling	-65C/+150C, 10 cycles, 30 minutes each extreme	1051
Electrical	Reverse Current (IR) @ rated VR	4016
	Breakdown voltage (BV) @ IZ	4022
<u>SUBGROUP 3:</u>		
Electrical	Reverse Current (IR) @ rated VR	4016
	Breakdown voltage (BV) @ IZ	4022
Operating Life	@ rated VR, TA = +125C for 340 hours	1026
Electrical	Reverse Current (IR) @ rated VR	4016
	D-IR = 50% or 1 μ A, whichever is >	
	Breakdown voltage (BV) @ IZ	4022
	D-BV = +-5% from initial	

NOTE: For bidirectional devices test both polarities-split hours on Operating Life to 50% each polarity.

Attributes Data Supplied
Sampling per MIL-S-19500
Module - H3 (Group B)

**MODULE GROUP C TESTING
For Module H3**

<u>Test</u>	<u>Condition</u>	<u>MIL-STD-750 Test Method</u>
<u>SUBGROUP 1:</u>		
Physical dimensions		2066
<u>SUBGROUP 2:</u>		
Terminal strength (tension)	Test condition A, W = 10lbs., t = 15 seconds	2036
Moisture resistance	Omit initial conditioning	1021
Electrical	Reverse Current (IR) @ rated VR Breakdown voltage (BV) @ IZ	4016 4022
<u>SUBGROUP 3:</u>		
Shock	1500G's, 0.5ms, 5 blows in each orientation X1, Y1, Z1	2016
Vibration, var. freq.		2056
Electrical	Reverse Current (IR) @ rated VR Breakdown voltage (BV) @ IZ	4016 4022
<u>SUBGROUP 4:</u>		
Salt atmosphere		1041
<u>SUBGROUP 5:</u>		
Operating Life	@ rated VR, TA = +125C for 1000 hours	1026
Electrical	Reverse Current (IR) @ rated VR D-IR = 50% or 1 μ A, whichever is > Breakdown voltage (BV) @ IZ D-BV = +-5% from initial	4016 4022

NOTE: For bidirectional devices test both polarities-split hours on Operating Life to 50% each polarity.

Attributes Data Supplied
Sampling per MIL-S-19500
Module - H3 (Group C)

TECHNICAL DATA

DISCLAIMER:

- 1- The information given herein, including the specifications and dimensions, is subject to change without prior notice to improve product characteristics. Before ordering, purchasers are advised to contact the Sensitron Semiconductor sales department for the latest version of the datasheet(s).
- 2- In cases where extremely high reliability is required (such as use in nuclear power control, aerospace and aviation, traffic equipment, medical equipment, and safety equipment), safety should be ensured by using semiconductor devices that feature assured safety or by means of users' fail-safe precautions or other arrangement.
- 3- In no event shall Sensitron Semiconductor be liable for any damages that may result from an accident or any other cause during operation of the user's units according to the datasheet(s). Sensitron Semiconductor assumes no responsibility for any intellectual property claims or any other problems that may result from applications of information, products or circuits described in the datasheets.
- 4- In no event shall Sensitron Semiconductor be liable for any failure in a semiconductor device or any secondary damage resulting from use at a value exceeding the absolute maximum rating.
- 5- No license is granted by the datasheet(s) under any patents or other rights of any third party or Sensitron Semiconductor.
- 6- The datasheet(s) may not be reproduced or duplicated, in any form, in whole or part, without the expressed written permission of Sensitron Semiconductor.
- 7- The products (technologies) described in the datasheet(s) are not to be provided to any party whose purpose in their application will hinder maintenance of international peace and safety nor are they to be applied to that purpose by their direct purchasers or any third party. When exporting these products (technologies), the necessary procedures are to be taken in accordance with related laws and regulations.