



TAI-SAW TECHNOLOGY CO., LTD.

No. 3, Industrial 2nd Rd., Ping-Chen Industrial District,
Taoyuan, 324, Taiwan, R.O.C.

TEL: 886-3-4690038 FAX: 886-3-4697532

E-mail: tstsales@mail.taisaw.com Web: www.taisaw.com

Approval Sheet For Product Specification

Issued Date:

Product Name: SAW Filter 996.34MHz SMD 3.0x3.0mm

TST Parts No.:TA0820A

Customer Parts No.:_____

Company: _____
Division: _____
Approved by : _____
Date: _____

Checked by: _____ Andy Yu

Approval by: _____ Francis Chen

Date: _____ 2008/01/18



TAI-SAW TECHNOLOGY CO., LTD.

No. 3, Industrial 2nd Rd., Ping-Chen Industrial District,
Taoyuan, 324, Taiwan, R.O.C.

TEL: 886-3-4690038 FAX: 886-3-4697532

E-mail: tstsales@mail.taisaw.com Web: www.taisaw.com

SAW Filter 996.34 MHz

MODEL NO.: TA0820A

REV. NO.:1

A. MAXIMUM RATING:

1. Input Power Level: 10 dB_m
2. DC voltage: 5 V
3. Operating Temperature: -40°C to +85°C
4. Storage Temperature: -40°C to +85°C

RoHS Compliant
Lead free
Lead-free soldering

B. ELECTRICAL CHARACTERISTICS: _

Item	Unit	Min.	Type.	Max.	
Center frequency	Fo	MHz	-	966.34	-
Insertion loss at Fc	IL	dB	-	1.9	-
1 dB bandwidth		MHz	30	38	-
3 dB bandwidth		MHz	-	48	-
Insertion loss at 981.34~1011.34MHz		dB	-	2.6	4.8
Ripple (981.34~1011.34 MHz)		dB	-	0.85	1.6
VSWR (981.34~1011.34 MHz)			-	1.6	2.5
Group Delay ripple at 981.34~1011.34 MHz		nsec		15	80
Attenuation (Reference level from IL)					
10 ~ 956	MHz	dB	40	50	-
1046 ~ 1097	MHz	dB	28	35	-
1097 ~ 1146	MHz	dB	40	60	-

C. Frequency Characteristics :

(1) wide band Response:(span 300MHz)

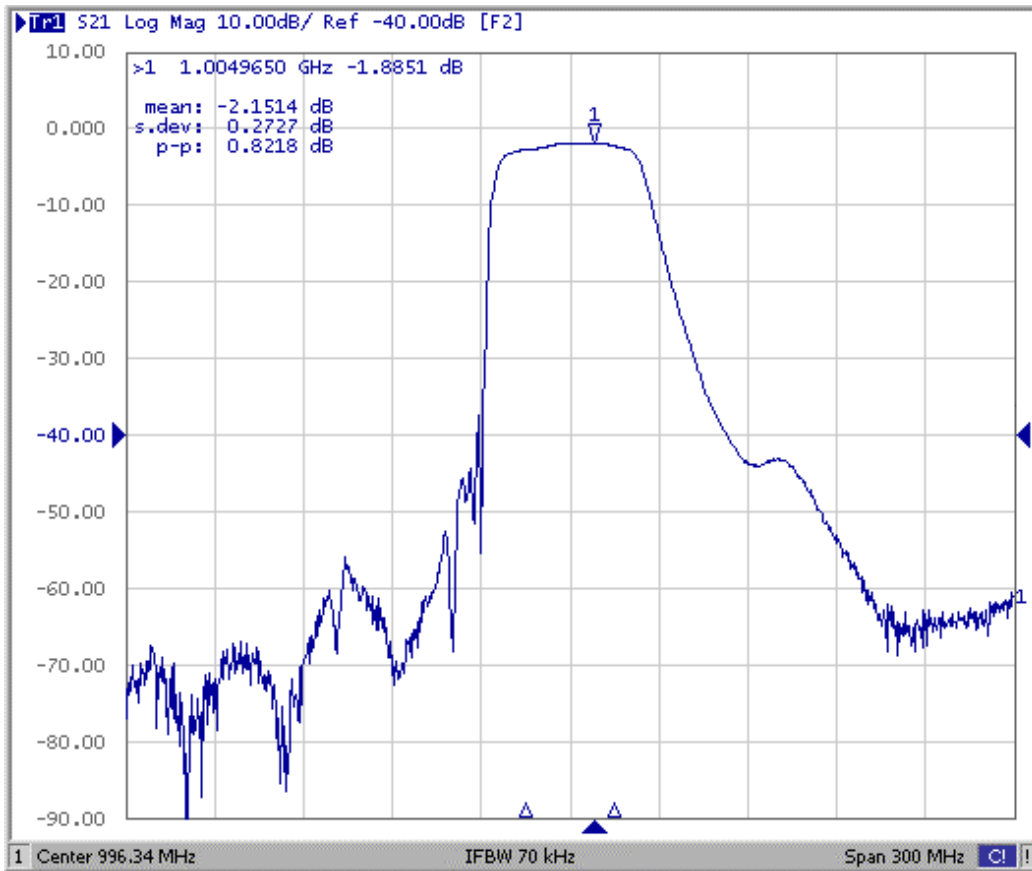

(2) Pass band Response:(span 80MHz)

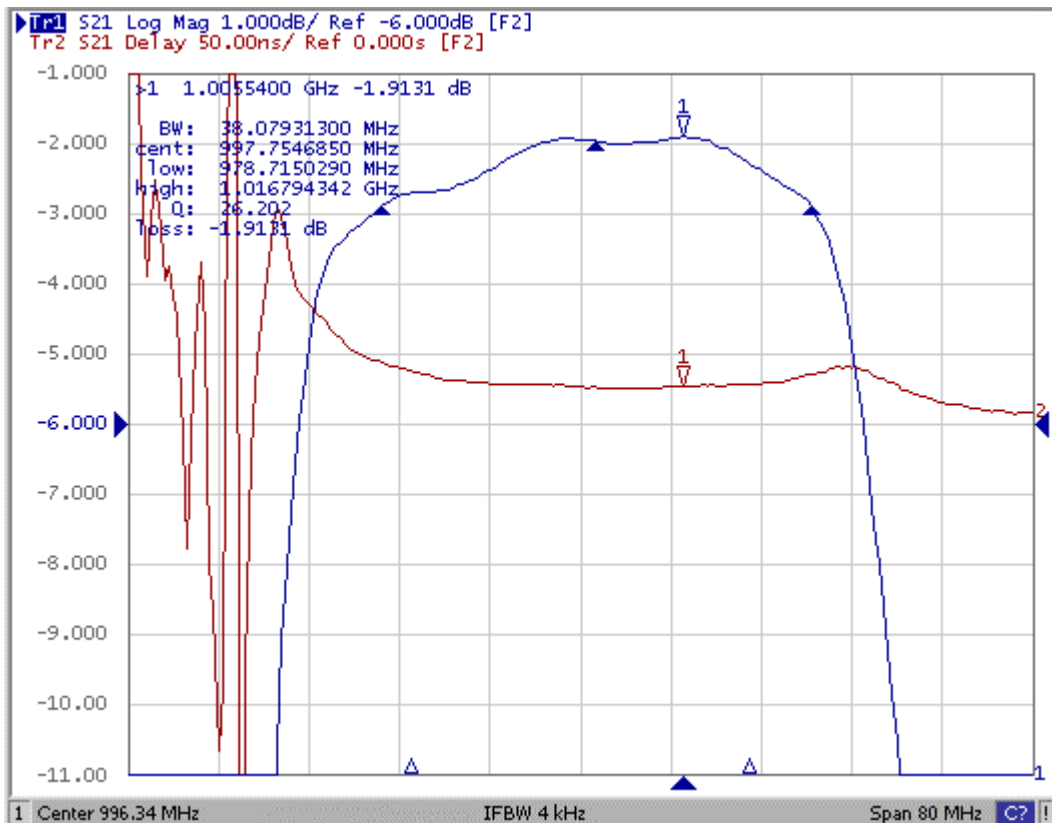

(3) S11 VSWR Variation: (span 200MHz)

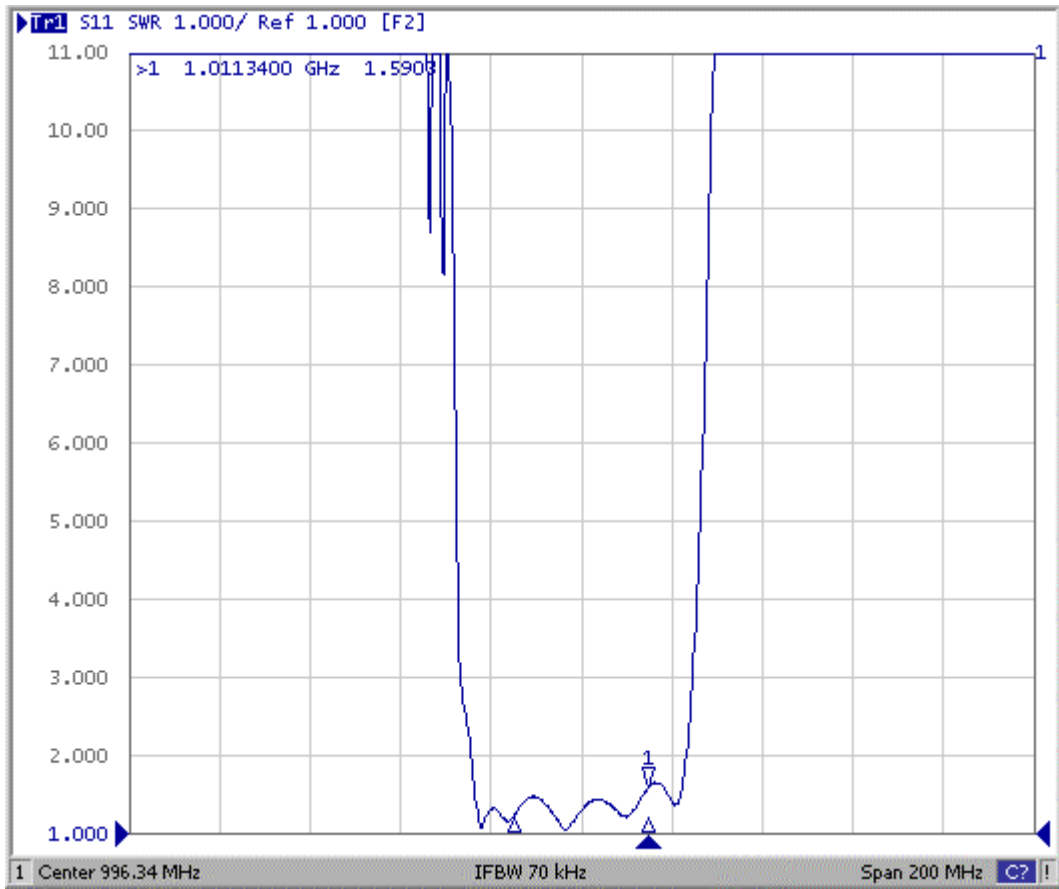

(4) S22 VSWR Variation: (span200MHz)

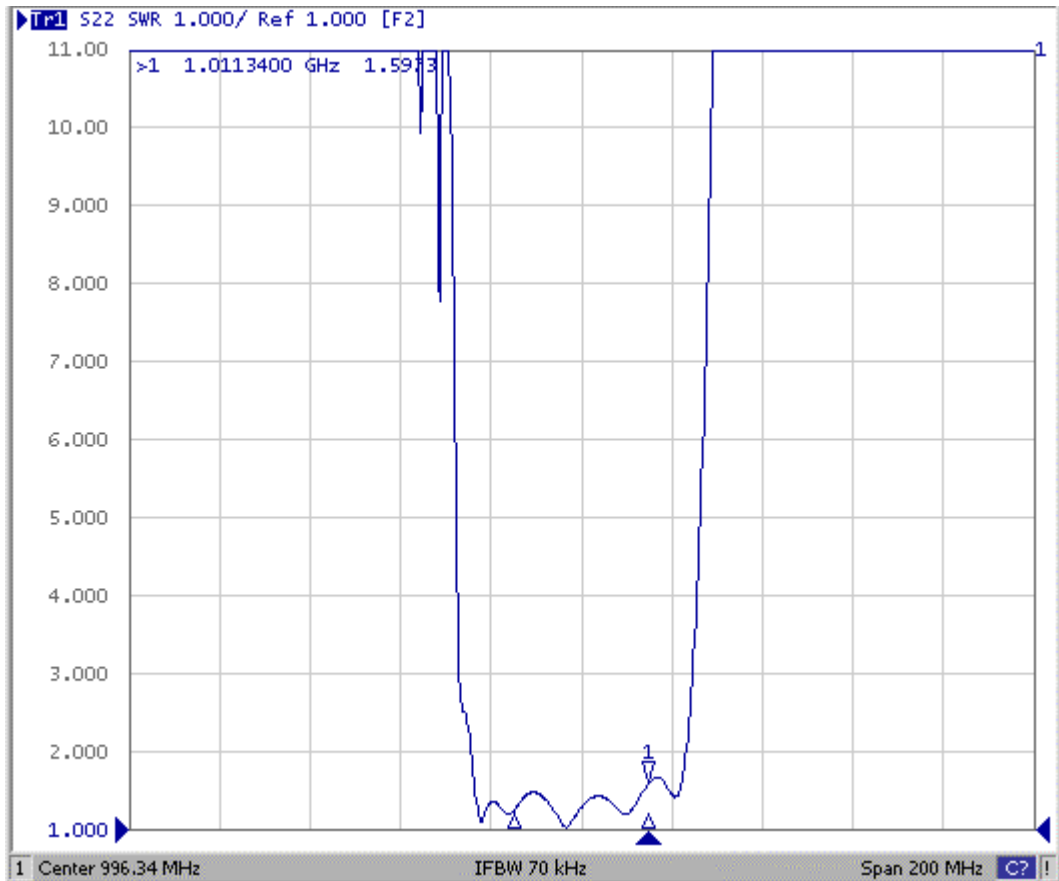

(5) S11 Smith-Chart: (span 300MHz)

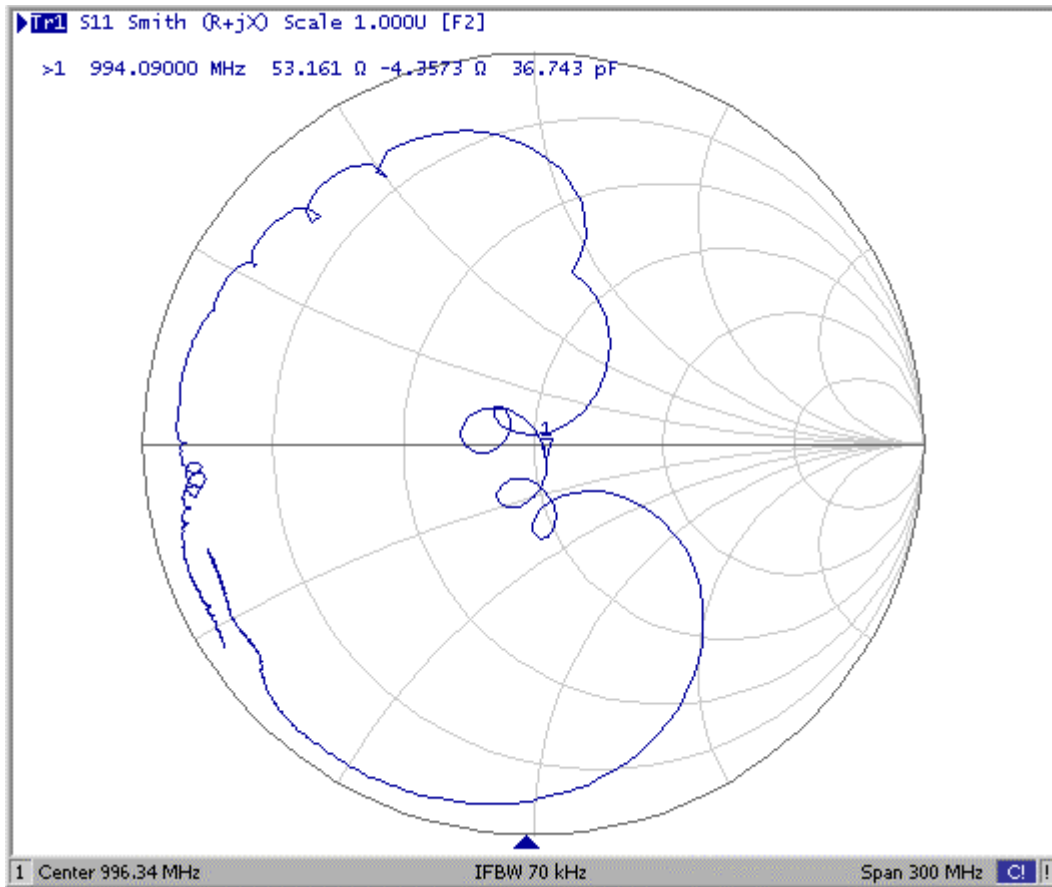

(6) S22 Smith-Chart: (span 300MHz)

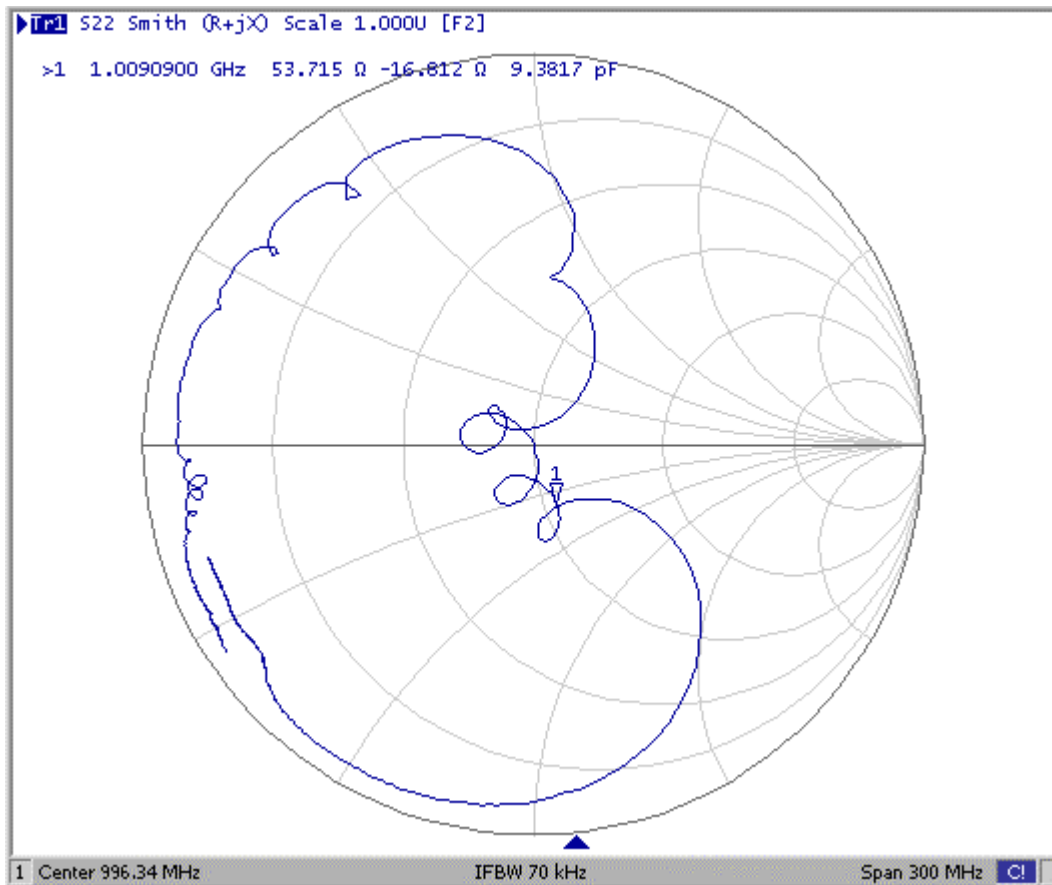

D. MEASUREMENT CIRCUIT:

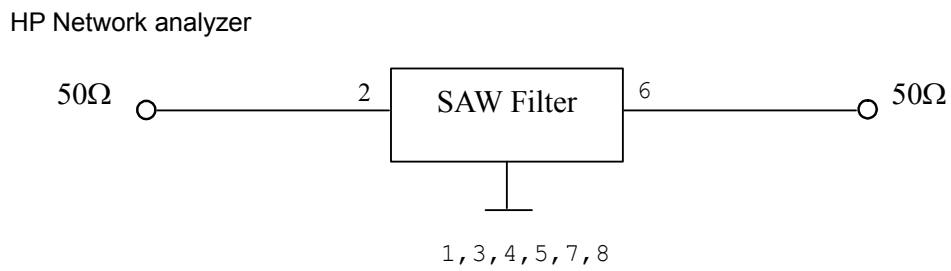

E. OUTLINE DRAWING:

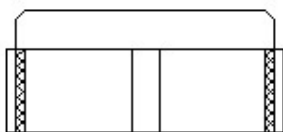
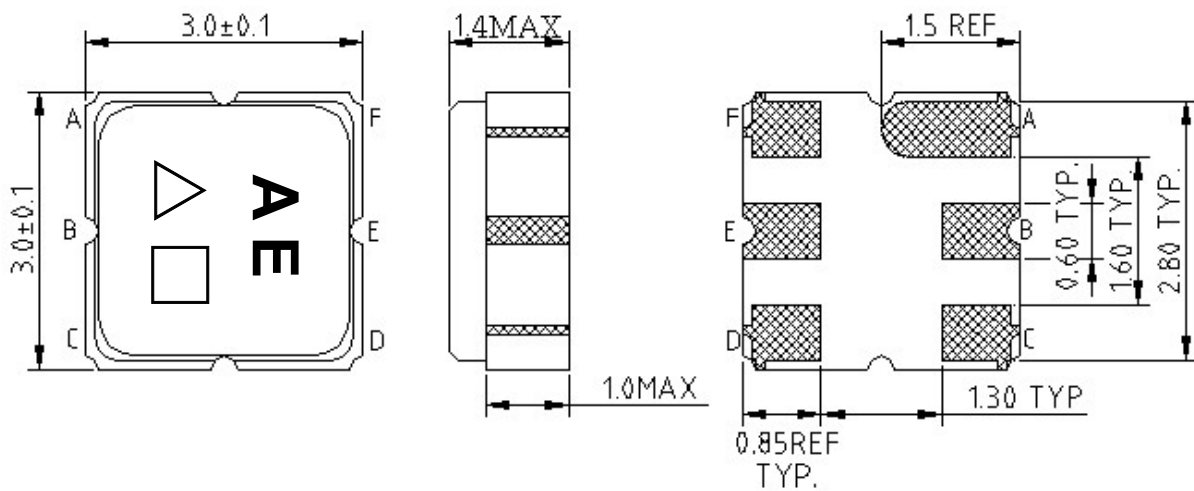

- #B: Input
- #E: Output
- #1,3,4,5,7,8: Ground
- △:Year code (ex 2008→8)
- : Date code
- Unit: mm

F. PACKING:

1. REEL DIMENSION

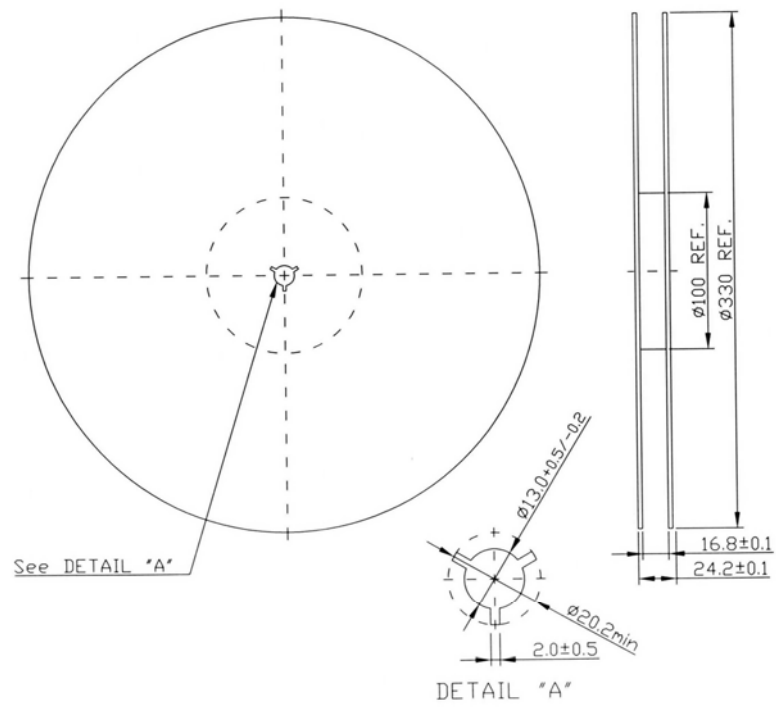

2. TAPE DIMENSION

