

REV.	DESCRIPTION	DATE	APPD.
B	Revised per ERI925	2/21/07	APPD

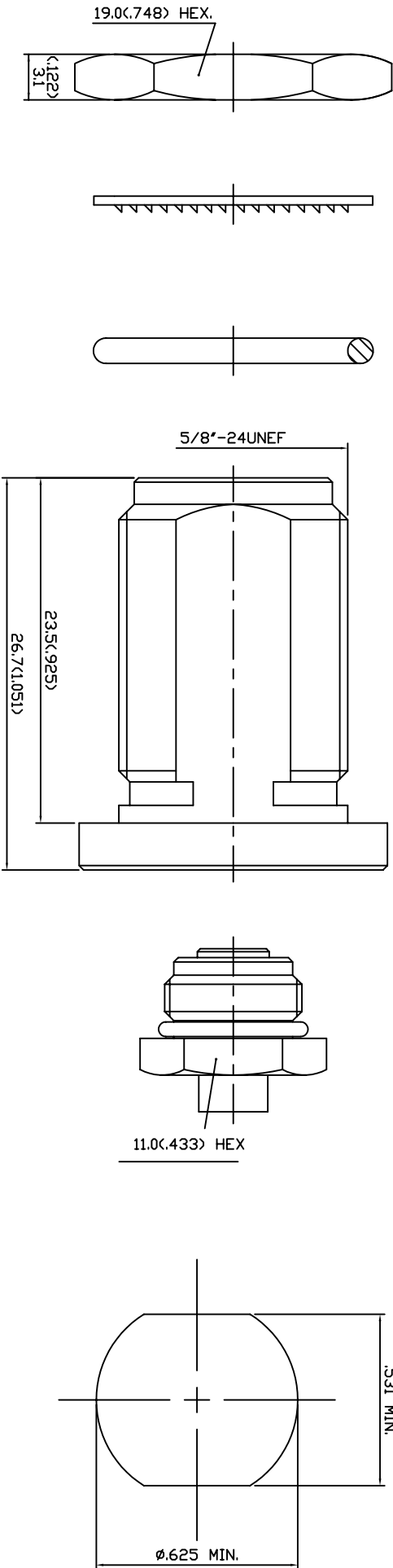

1.0 ELECTRICAL

- 1.1 FREQUENCY RANGE: DC-11 GHz
- 1.2 NOMINAL IMPEDANCE: 50 OHM
- 1.3 WORKING VOLTAGE: 1000 VOLTS MAX.
- 1.4 PROOF VOLTAGE: 2500 VOLTS
- 1.5 VSWR: 1.3

2.0 MATERIALS

- 2.1 BODIES: BRASS PER JIS-C3604
- 2.2 CENTER CONTACT: BERYLLIUM COPPER PER ASTM B196 UNS C17300
- 2.3 CENTER CONTACT PLATING: .000030 MIN. GOLD OVER NICKEL
- 2.4 INSULATION: TEFLON PER ASTM D1457 AND ASTM D1710

3.0 FINISHES AND OTHERS

- 3.1 CENTER CONTACT NUT: 0.000030 MIN. GOLD PLATE OVER NICKEL.
- 3.2 ALL OTHER METAL PARTS: 0.000100 MIN. NICKEL PLATE.

4.0 MECHANICAL

- 4.1 INTERFACE IN ACCORDANCE WITH: MIL-STD-348A
 - 4.2 FOR USE WITH RG402 OR SIMILAR STYLE CABLE
 - 4.3 CABLE ATTACHMENT: OUTER SOLDER, INNER SOLDER
- 5.0 ENVIRONMENTAL**
- 5.1 OPERATING TEMPERATURE RANGE: -65° C TO +165° C

<p>PER ASME Y14.5M-1994 UNLESS OTHERWISE SPECIFIED: DIMENSIONS ARE IN INCHES (MM)</p> <p>TOLERANCES: DECIMALS .XX ± 0.01 / 0.25 XXX ± 0.005 / 0.127</p> <p>ANGLES ± Z° SCALE:</p>				<p>Winchester Electronics Winchester Electronics Corporation 62 Barnes Industrial Road North Wallingford, Connecticut 06492</p>			
<p>CUSTOMER DRAWING</p>		<p>TYPE N BULKHEAD JACK</p>		<p>TITLE</p>			
<p>DATE CHECKED</p>	<p>DATE</p>	<p>DATE APPROVED</p>	<p>DATE</p>	<p>DATE</p>	<p>DATE</p>		
<p>10/26/00</p>	<p>2/21/07</p>	<p>2/21/07</p>	<p>2/21/07</p>	<p>2/21/07</p>	<p>2/21/07</p>		
<p>JMH</p>	<p>RM</p>	<p>RM</p>	<p>RM</p>	<p>RM</p>	<p>RM</p>		
<p>SD601-526-1410Y</p>	<p>1</p>	<p>1</p>	<p>1</p>	<p>1</p>	<p>1</p>		
<p>SD601-526-1410Y</p>	<p>1</p>	<p>1</p>	<p>1</p>	<p>1</p>	<p>1</p>		