

REVISIONS	
LTR	
A	INITIAL RELEASE

SPECIFICATIONS:

NOMINAL FREQUENCY:	32.768 kHz
FREQUENCY TOLERANCE AT 25°C:	±20 PPM M
OPERATING TEMPERATURE RANGE:	-40°C TO +
STORAGE TEMPERATURE RANGE:	-55°C TO +
AGING:	±5 PPM PE
LOAD CAPACITANCE:	12.5 pF
DRIVE LEVEL:	1.0 μW MA
SHUNT CAPACITANCE:	1 pF MIN
EQUIVALENT SERIES RESISTANCE:	50 KOHMS
TURNOVER TEMPERATURE:	25°C ±5°C
TEMPERATURE COEFFICIENT:	-0.035 ±0.0

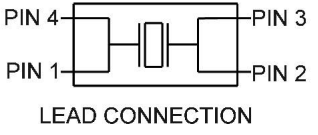
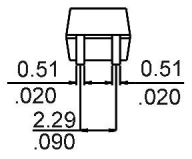
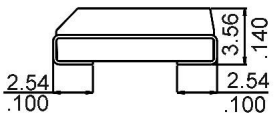
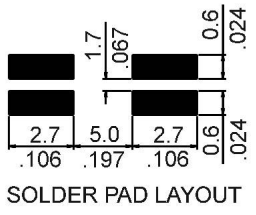
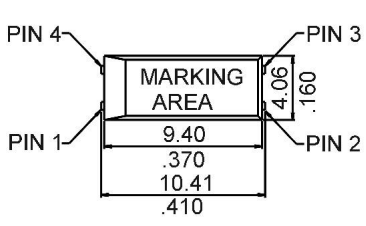

RALTRON
 10651 NW 19TH STREET
 MIAMI, FL 33172

ALL DIMENSIONS ARE IN mm/inch
 UNLESS OTHERWISE SPECIFIED

DRAWN BY: Part Generator
 CHECKED BY:
 APPROVED BY:
 SCALE: SHEET 1 OF DATE:

DRAWING TITLE:
SURFACE MOUNT
CR

DRAWING NUMBER:
RSE-32.70

CAGE CODE:
Ø VUE Ø