

ICP Emulation Adapters

ICP SERIES

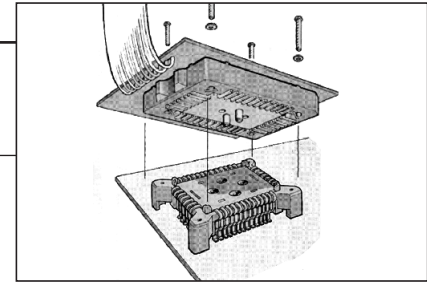

ORDERING INFORMATION

ICP-***-**-*

Adapter Series

No. of Contacts

Design Number

Contact Plating:
Blank: Au over Ni
S: SnPb over Ni (see below)

The ICP Series Emulation adapters are designed to be used with the IC149 Series prototype sockets

Characteristics

Insulation Resistance: 500M | Minimum at 150 VDC
Withstanding Voltage: 700 VAC for 1 minute
Contact Resistance: 30m | Max. at 10mA/20mV
Operating Temperature: -25°C ~ +85°C

Material and Finish

Insulator: High Temp Thermoplastic-UL94V-0
Contact: Copper Alloy
Plating: Mating Face: Au over Ni
Terminals: Au over Ni or Sn Pb over Ni (see below)
Maximum Allowable Torque: One time screw connection: Max. 0.147Nm
Repetitive screw connection: Min. 0.078Nm
Max. 0.098Nm

Attention should be taken **NOT** to exceed maximum torque otherwise performance could be affected.

Features

Socket and probe subassembly are used for emulation testing to check socket and signal integrity and continuity

ADAPTER OUTLINE DIMENSIONS (reference only)

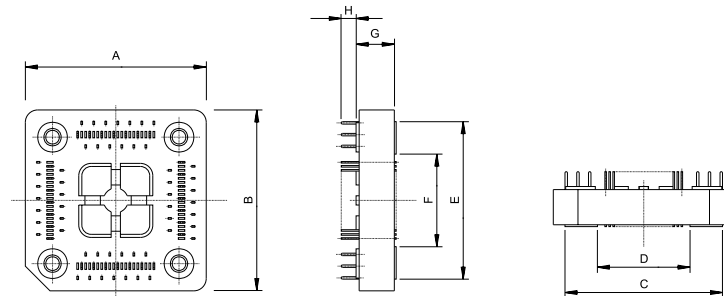

ADAPTER DIMENSIONS (reference only) (mm)

Part Number	A	B	C	D	E	F	G	H
ICP-044-2	29.00	29.00	17.40	—	17.40	—	8.08	2.4
ICP-064-2	28.00	28.00	25.53	15.00	25.53	15.00	6.20	2.4
ICP-064-6	25.00	25.00	12.40	—	12.40	—	8.08	2.4
ICP-080-3-1	36.62	30.62	32.42	21.90	26.42	15.90	6.20	2.4
ICP-080-4	29.32	29.32	25.53	15.00	25.53	15.00	6.20	2.4
ICP-080-5	36.62	30.62	32.42	21.90	26.42	15.90	6.20	2.4
ICP-080-6 [⊠]	27.00	27.00	14.50	—	14.50	—	8.08	2.4
ICP-080-7	28.00	28.00	16.50	—	16.50	—	8.08	2.4
ICP-100-4-†	36.62	30.62	32.41	21.90	26.42	15.90	5.50	3.0
ICP-100-4-4	36.62	30.62	32.41	21.90	26.42	15.90	5.50	3.0
ICP-100-5 [⊠]	29.00	29.00	16.50	—	16.50	—	8.08	2.4
ICP-100-6	34.50	34.50	31.81	21.28	31.81	21.28	5.50	3.1
ICP-112-2	35.00	35.00	31.53	21.00	31.53	21.00	6.20	2.4
ICP-120-2	28.00	28.00	16.50	—	16.50	—	8.08	2.4
ICP-144-1	35.00	35.00	22.50	—	22.50	—	8.08	2.4
ICP-160-1	44.20	44.20	40.41	29.88	40.41	29.88	5.50	3.1

†: Replace with:

- 1 for board thickness range of 1.20 ~ 2.60mm
- 2 for board thickness range of 0.00 ~ 1.40mm
- 3 for board thickness range of 4.00 ~ 5.40mm

⊠: Designate with S to order with SnPb over Ni otherwise the adapter will be supplied with Au over Ni.