

L032 Series Surface Mount Power Inductors



Features

- Will Handle up to 2.20A
- Economical Design
- Suitable for Pick and Place Applications
- Withstands Solder Reflow

Applications

- Handheld and PDA Applications
- DC/DC Converters
- SMPS Applications
- Battery Powered or Low Voltage Applications

Packaging

- Reel Diameter: 7"
- Reel Width: 8mm
- Pieces Per Reel: 2000



Mechanical

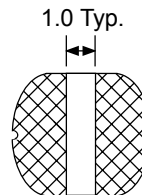
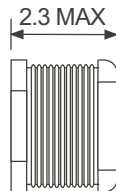
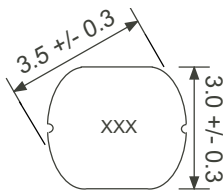

Recommend PCB Layout

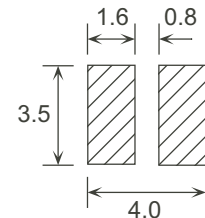

unit:mm

Electrical Specifications

Part Number	Inductance ¹ ($\mu\text{H} \pm 20\%$)	DCR max (Ω)	I_{dc} max ² (A)
L032-1R0-RM	1.0	0.045	2.20
L032-1R2-RM	1.2	0.050	2.10
L032-1R5-RM	1.5	0.055	1.70
L032-1R8-RM	1.8	0.070	1.65
L032-2R2-RM	2.2	0.085	1.60
L032-2R7-RM	2.7	0.100	1.40
L032-3R3-RM	3.3	0.120	1.05
L032-3R9-RM	3.9	0.125	1.00
L032-4R7-RM	4.7	0.135	1.00
L032-5R6-RM	5.6	0.145	0.95
L032-6R8-RM	6.8	0.200	0.95
L032-8R2-RM	8.2	0.250	0.92
L032-100-RM	10	0.320	0.90
L032-120-RM	12	0.350	0.85
L032-150-RM	15	0.460	0.75
L032-180-RM	18	0.520	0.70
L032-220-RM	22	0.650	0.60
L032-270-RM	27	0.750	0.55
L032-330-RM	33	0.920	0.50
L032-390-RM	39	1.00	0.48
L032-470-RM	47	1.15	0.45
L032-560-RM	56	1.50	0.30
L032-680-RM	68	2.00	0.26
L032-820-RM	82	2.15	0.23
L032-101-RM	100	2.50	0.20
L032-121-RM	120	3.40	0.18
L032-151-RM	150	4.20	0.16
L032-181-RM	180	4.50	0.15
L032-221-RM	220	5.10	0.14
L032-271-RM	270	8.50	0.10
L032-331-RM	330	9.50	0.09

1. Tested @ 100kHz, 0.1Vrms.
2. Inductance drops 10% at rated I_{dc} .
3. Electrical specifications at 25°C.
4. Operating temperature range: -40°C to +85°C.
5. Meets UL 94V-0.