

FWA-6280-C

2U Rackmount Intel Xeon® Processor-based Platform with Modular PCIe LAN I/O Cards

NEW



Features

- Intel® Xeon® EM64T (Nocona), up to 3.6 GHz
- Dual-channel DDR2 400 MHz ECC registered, up to 12 GB
- Eight PCIe 10/100/1000 Mbps LAN ports
- Supports mini-GBIC, up to four interfaces
- PCI-X 64/133 slots 3.3 V, up to two slots
- Supports two removable 3.5" SATA HDDs
- One 10/100 Mbps LAN port for management

Introduction

Conceived as a powerful 2U rackmount network security platform, the FWA-6280-C was specifically designed for enterprise-level high performance IDS/IPS, firewall, antivirus gateway and Unified Threat Management (UTM) applications. Designed with the Intel Xeon processor, it provides high computing power and meets the requirements of high speed packet processing. In addition, the FWA-6280-C can support up to 12 GB DDR2 of memory. One additional PCI Express x8 connector doubles the I/O bandwidth compared to FWA-6280A, and extends the total system bandwidth up to 64 Gb/s. Four Intel PCIe 82571 LAN controllers offers eight 10/100/100 Mbps LAN ports with supreme network performance in the front panel. The system supports two optional 3.5" hot-swappable SATA HDDs and CompactFlash for OS and network security applications. The HDDs can be easily inserted/removed from the front panel. The front panel also has an RJ-45 type serial port, a 10/100 management LAN port, two USB ports and an LCD module for local system management, maintenance, and diagnostics. It is FCC, UL, CE, CCC and RoHS compliant.

Specifications

Processor System	CPU	Intel Xeon EM64T with hyperthreading, single or dual processor	
	Max. Speed	3.6 GHz	
	Chipset	Intel E7520 (Lindenhurst) + 6300ESB (Hance Rapids)	
	Front Side Bus	800 MHz	
	BIOS	Award™ 4 Mbit Flash	
Memory	Technology	Dual-channel DDR2 400 MHz ECC registered	
	Capacity	Up to 12 GB with 6 slots, installed in pairs	
Bus	PCIe	2 PCIe x8 connector for LAN expansion board	
	Riser Card	2 PCI-X 64/133 slots Supports full-height cards and external access, such as LAN and SCSI	
Ethernet	Managed LAN	One 10/100 Mbps Intel 82551 Fast Ethernet port for management	
	Gigabit Ethernet	Eight 10/100/1000 Mbps PCIe Intel 82571 GbE ports, supports up to 4 mini-GBIC interface	
	LAN Bypass	Four segment in pairs on GbE ports	
Storage	SATA	Two 3.5" SATA HDD, hot-swappable	
	CompactFlash Socket	1 CF socket on IDE 1 (Secondary/Master)	
Peripheral	USB	2 (USB 2.0)	
	Serial	1 (RJ-45)	
	LCD Module	1	
Power	Watt	500 W (1+1 redundant, 500 W each)	
	Input	AC 100 ~ 240 V @ 50 ~ 60 Hz, full range	
Environment		Operating	Non-Operating
	Temperature	0 ~ 40° C (32 ~ 104° F)	-20 ~ 75° C (-4 ~ 167° F)
	Humidity	5 ~ 85 % @ 40° C (104° F)	5 ~ 95 %
Physical Characteristics	Dimensions (W x H x D)	430 x 88 x 515 mm (16.9" x 3.46" x 20.3")	
	Weight	18 kg (40 lb)	

Dimensions

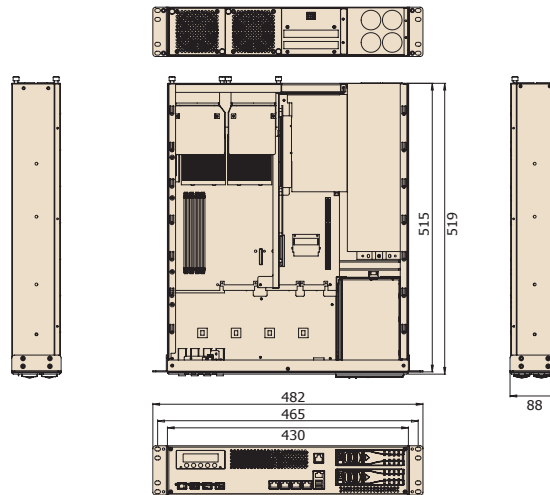

Unit: mm (inch)

Ordering Information

Part Number	LAN	HDD Bay	Power
FWA-6280-CRE	8 x 10/100/1000Base-TX	Hot-swappable SATA	Redundant 500 W
FWA-6280-CFE	4 x 10/100/1000Base-TX 4 x mini-GBIC	Hot-swappable SATA	Redundant 500 W
FWA-6240-CRE	4 x 10/100/1000Base-TX	Hot-swappable SATA	Redundant 500 W
FWA-6240-CFE	4 x mini-GBIC	Hot-swappable SATA	Redundant 500 W

Accessories

Part Number	Description
1703080160	PS/2 Y cable mini-DIN 16 cm
1702002600	3P 180 cm, USA
1702002605	3P 180 cm, Europe
1702031801	3P 180 cm, UK
1700000237	3P 180 cm, JP

