

Ordering Information pg. 9

**MTJ-662BX1-FS**

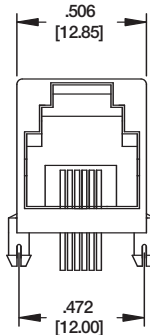

**6 POS  
2B SHIELDED**

**MTJ-882BX1-FS**

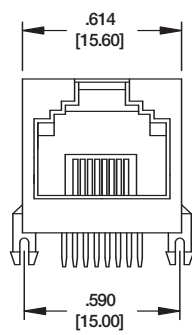

**8 POS  
2B SHIELDED**

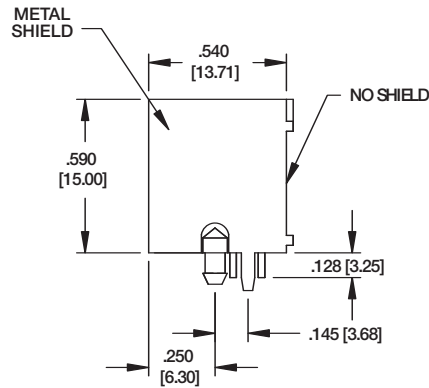

**TYPE 2B  
SHIELDED**  
6P6C  
6P4C  
8P8C



**MTJ-662BX1-FS**



**MTJ-882BX1-FS**

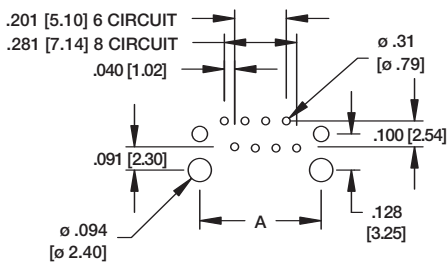

**Recommended PCB Layout**

DIM. "A"	
TYPE2B 6P6C	.472 [12.00]
TYPE2B 8P8C	.590 [15.00]

**TYPE Q  
COMPACT JACK  
4P4C**

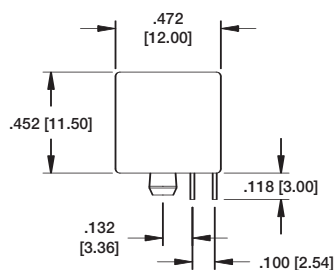
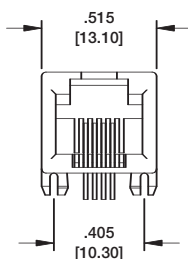

**MTJ-44QX1**

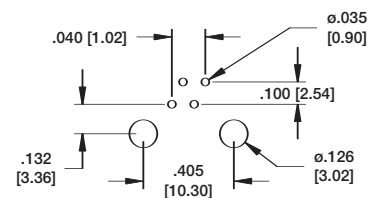
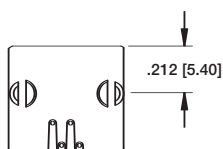

**Recommended PCB Layout**