



High Performance Isolation Amplifier, 12.54 dB Gain 20 - 400 MHz

Features

- 35 dB Typical Reverse Isolation
- +42 dBm Typical Third Order Intercept
- +24 dBm Typical 1 dB Compression
- 1.2:1 Typical VSWR

Description

M/A-COM's AM-157 is a high performance isolation amplifier with high intercept and compression points. The use of coupler feedback minimizes current in a high intercept amplifier. This amplifier has been optimized for low VSWR to improve system performance. This amplifier is packaged in a TO-8-1 package, and is also available with SMA connectors. The ground plane on the PC board should be configured to remove heat from under the package. AM-157 is ideally suited for use where a high isolation, high intercept amplifier is required

TO-8-1

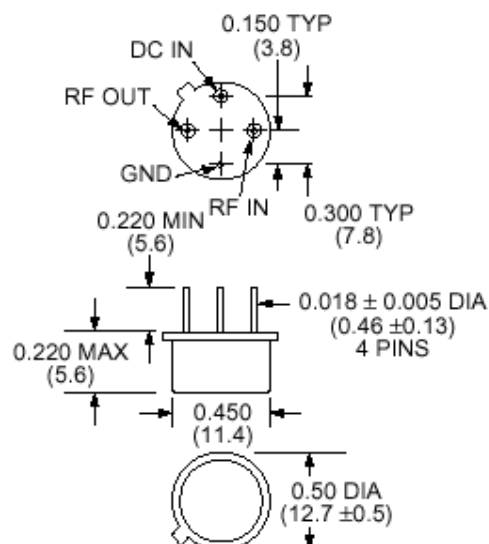

Dimensions in () are in mm.

Unless Otherwise Noted: .xxx = ±0.010 (.xx = ±0.25)

.xx = ±0.02 (.x = ±0.5)

WEIGHT (APPROX.): 0.10 OUNCES 2.8 GRAMS

Ordering Information

Part Number	Package
AM-157 PIN ¹	TO-8-1 package
AMC-157 SMA	Connectorized

1. Mounting kit part number AU00071 required for PCB applications.

Absolute Maximum Ratings ²

Parameter	Absolute Maximum
Max. Input Power	+13 dBm
V _{bias}	+17.0 V
Operating Temperature	-55°C to +85°C
Storage Temperature	-65°C to +125°C

2. Operation of this device above any one of these parameters may cause permanent damage.

C-32

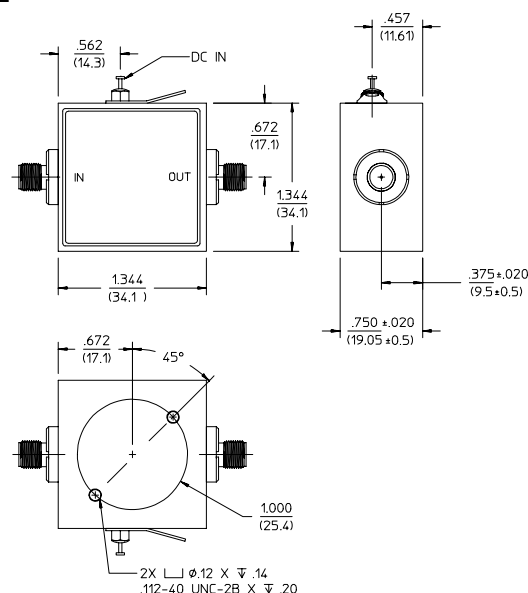

DIMENSIONS IN () ARE IN MM
UNLESS OTHERWISE NOTED: XXX = ±0.010 (XX = ±0.25)
XX = ±0.02 (X = ±0.5)

WEIGHT (APPROX.): 1.62 OUNCES 46 GRAMS

Specifications subject to change without notice.

■ **North America:** Tel. (800) 366-2266, Fax (800) 618-8883
 ■ **Asia/Pacific:** Tel. +81-44-844-8296, Fax +81-44-844-8298
 ■ **Europe:** Tel. +44 (1344) 869 595, Fax +44 (1344) 300 020

Visit www.macom.com for additional data sheets and product information.

tyco / Electronics



Electrical Specifications^{4,5} $T_A = -55^{\circ}\text{C}$ to $+85^{\circ}\text{C}$ Case Temperature

Parameter	Test Conditions	Frequency	Units	Min	Typical	Max
Gain	50 MHz @ $+25^{\circ}\text{C}$	50 MHz	dB	11.7	12.5	13.3
Frequency Response	—	20 - 400 MHz	dB	—	—	± 0.5
Gain Variation with Temperature	—	20 - 400 MHz	dB	—	—	± 1.0
1 dB Compression	Output Power	20 - 400 MHz	dBm	+21	—	—
Noise Figure	—	20 - 400 MHz	dB	—	—	7.5
Reverse Transmission	—	20 - 400 MHz	dB	—	-27	-20
VSWR	—	20 - 100 MHz 100 - 400 MHz	Ratio Ratio	— —	— —	1.5:1 2.0:1
Output IP_2	Two-tone inputs up to +10 dBm	20 - 400 MHz	dBm	+40	—	—
Output IP_3	Two-tone inputs up to +10 dBm	20 - 400 MHz	dBm	+30	—	—
Vbias	@ 90 mA max	—	V	—	—	15.00
Ibias	1.2W Typical	—	mA	—	80	—

4. All specifications apply when operated at +15 VDC, with 50 ohms source and load impedance.

5. Heat Sinking: Operation at case temperature above 95°C is not recommended. Heat sinking adequate to dissipate 2.7W must be provided in use. The flange should be screwed down to the heat sink, which should be RF ground.

Typical Performance

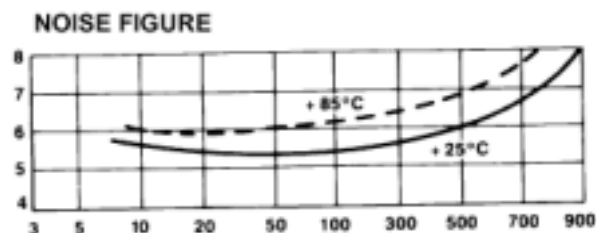
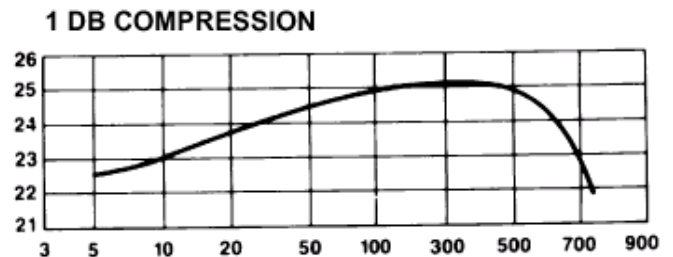
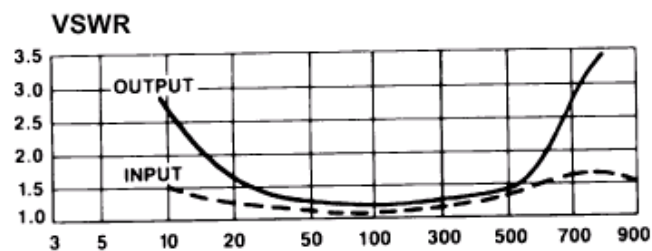
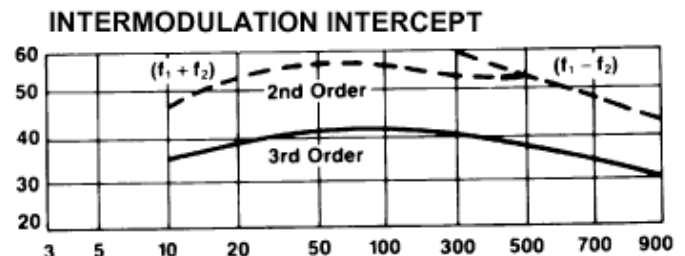
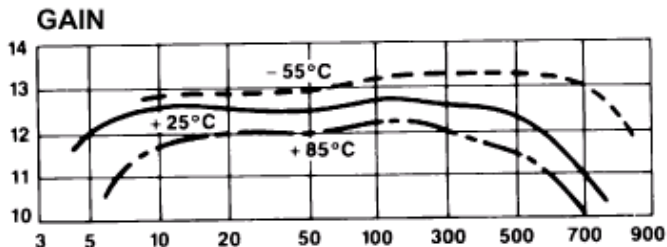

Specifications subject to change without notice.

V 3.0

■ North America: Tel. (800) 366-2266, Fax (800) 618-8883
 ■ Asia/Pacific: Tel. +81-44-844-8296, Fax +81-44-844-8298
 ■ Europe: Tel. +44 (1344) 869 595, Fax +44 (1344) 300 020

Visit www.macom.com for additional data sheets and product information.

tyco / Electronics

MACOM