

**KSG 200**  
EMI/RFI- and ESD-Protection  
Complete kit incl. knurled screws

## Cable Connector Housings

for D-Subminiature connectors

TMC series

Housing versions KSG 200



### Advantages

- **Reliable Electro Static Discharge (ESD) protection**
- **Electromagnetic Compatibility (EMC) as a result of EMI/RFI shielding**
- **Reliable strain relief**
- **Snap Latches allow easy assembly**
- **Simple disassembly allows easy service**
- **Four housing sizes 9, 15, 25, and 37 pins**
- **Complete kit incl. knurled screws**

### General

The new KSG 200 cable connector housing is intended for use with the TMC series, D-SUB connectors acc. to DIN 41 652, MIL-C-24308 and IEC 807-3.

It was designed to fulfill the high ESD requirements and to provide shielding against EMI/RFI in accordance with the new EMC laws. The ESD protection is essential for high performance data transfer at high frequencies.

To ensure optimum ESD protection, the new cable connector housing and the knurled screw head are made of high performance plastics. The KSG 200 thus satisfies the requirements of IEC 801-2.

To improve EMI/RFI shielding, two shielding plates are riveted into the two half-shells of the housing.

The shielding plates have a special design conceived after extensive testing. This allows a very high level of shield attenuation which at 100 MHz amounts to more than -66 dB. The lamellar indents of the shielding plates at the contact points to the TMC connector and to the strain relief makes a major contribution to this very high level of shielding.

The strain relief also connects the braided shield of the cable to the shielding plates. Cables with a diameter of up to 11.0 mm can be connected.

A further major advantage of the new cable connector housing is the fast and easy assembly by means of snap latches on the two half-shells. The two fixing screws prevent the two half-shells from falling apart (e.g. if the housing is dropped on the floor).

For servicing, the two half-shells can be easily disassembled by removing the screws by hand or using a screwdriver.

## Cable Connector Housing

## KSG 200 series

fully insulated housing with integrated shielding plates

The illustration below shows a 37pin housing

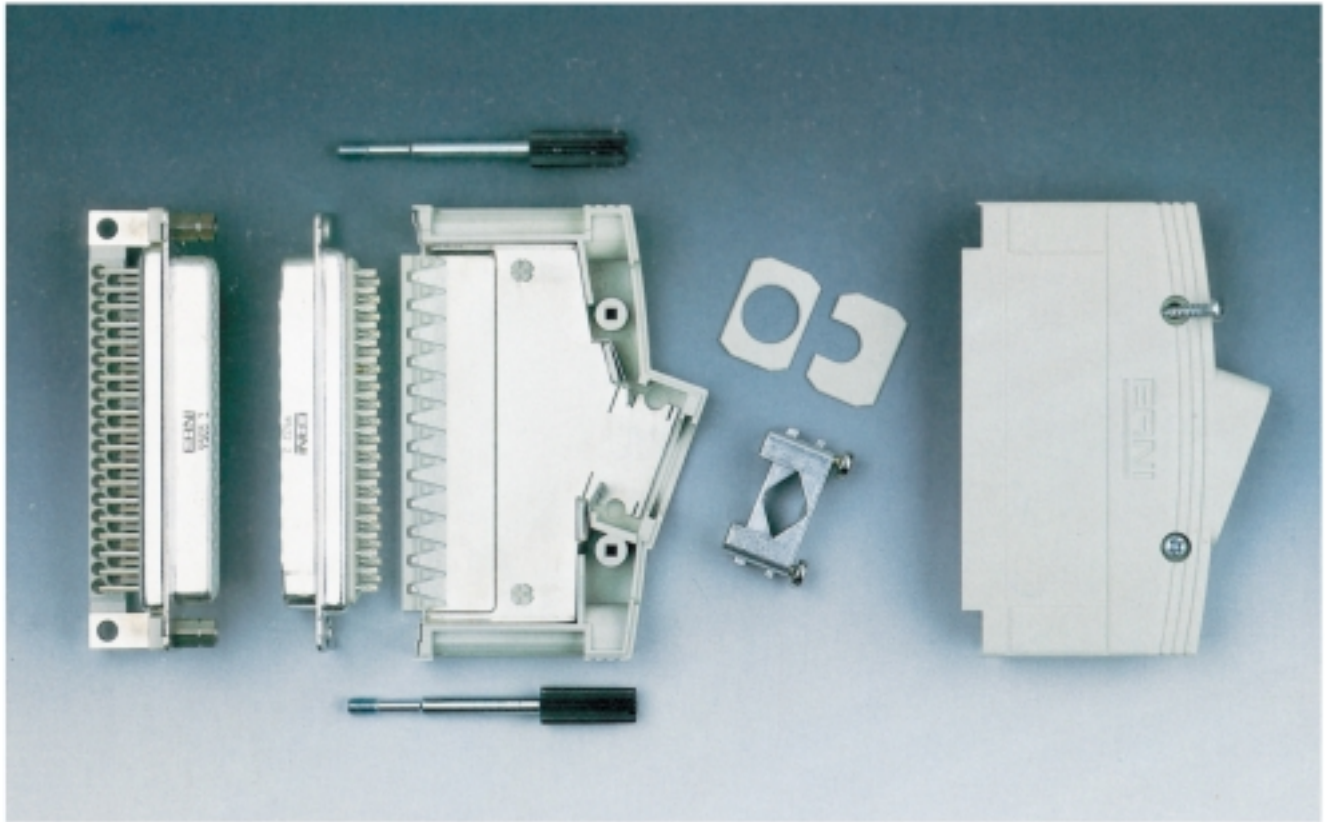

### Dimensions of KSG 200 cable connector housing

The illustration below shows a 37pin housing

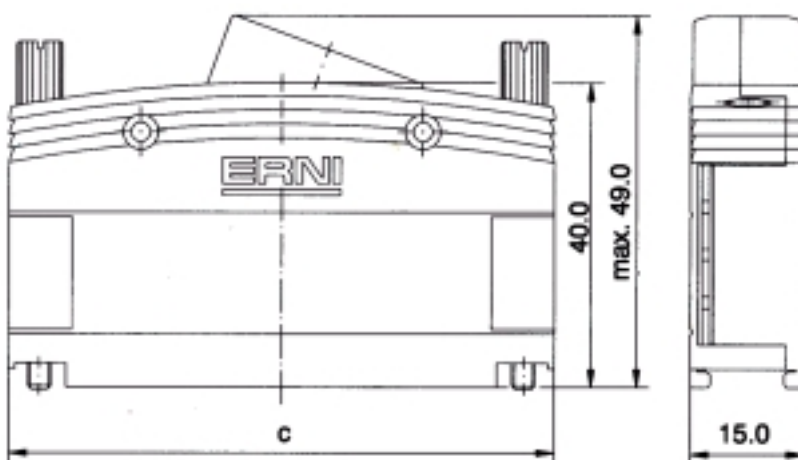

Number of pins	c	Cable diameter
9	33.0	4-9
15	41.3	4-9
25	55.0	4-11
37	71.5	4-11
50	-	-



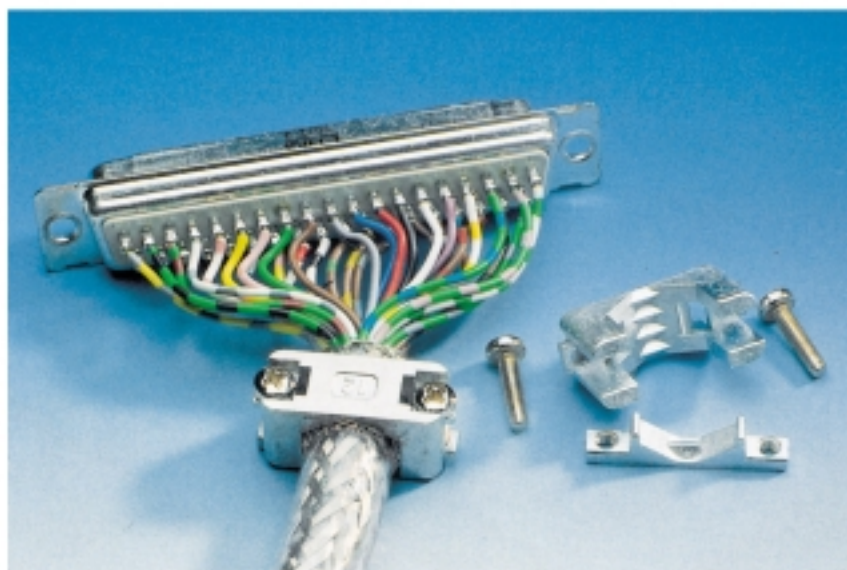

### **Design of strain relief elements**

The strain relief elements comprise two die-cast zinc components. Contact with the braided shield is accomplished by the clamps, as the screws are tightened.

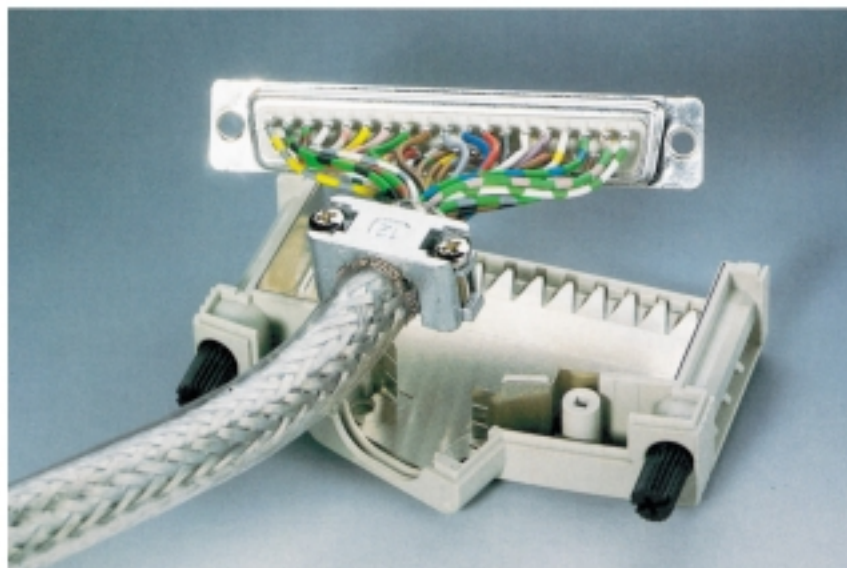

### **Design of interface between shielding and TMC**

The lamellar indents of the shielding plates will guide the ground connections from the cable shield via the strain relief to the TMC connector. These lamellar indents make contact along the entire length of connector.

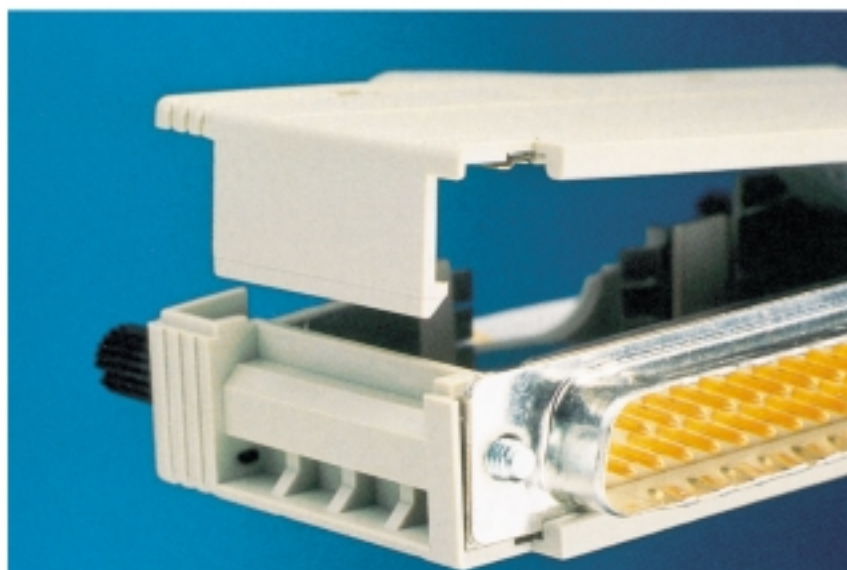

### **Easy assembly**

The KSG 200 comprises two half-shells which simply latch together. These latches can be opened again if the device needs to be serviced. The two half-shells can also be screwed together.

## Parts used in KSG 200 cable connector housing

### Housing with internal shielding plates

The illustration below shows a 37pin housing

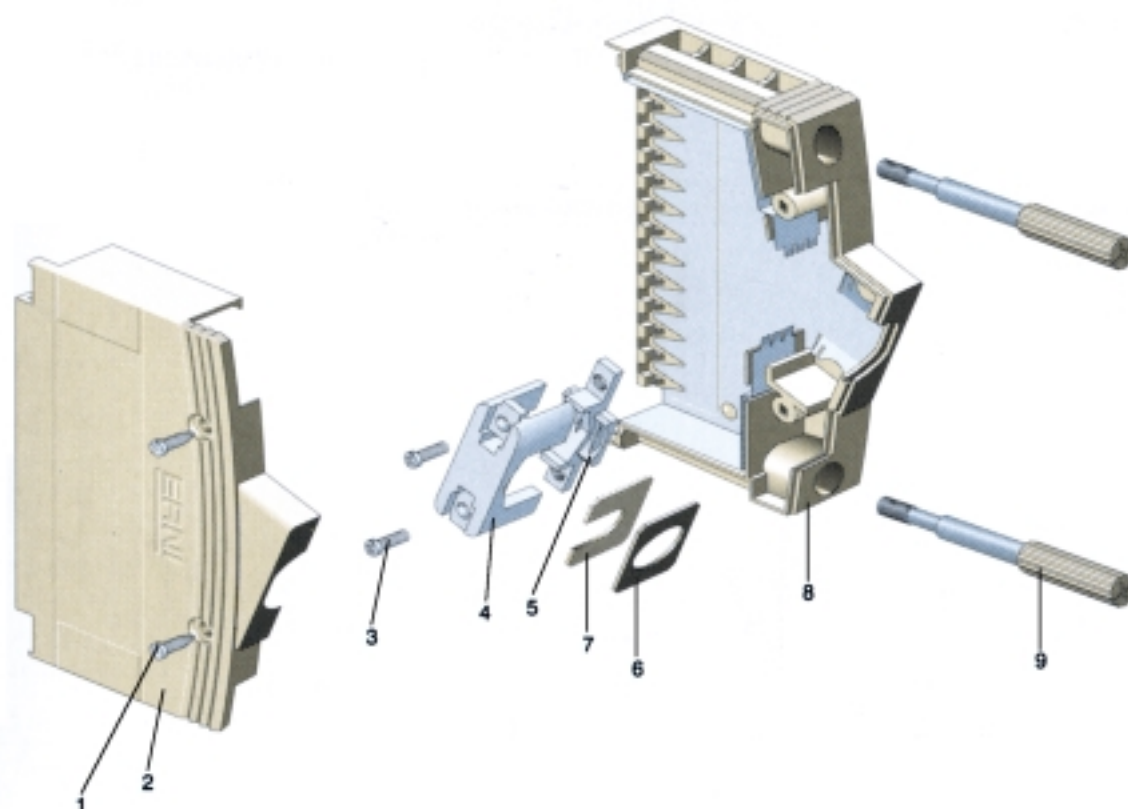

#### Individual components

Item	Description	Material
1	Roundhead tapping screws B 2.2 x 9.5 DIN 7981	Galvanized steel
2	Connector housing upper part with riveted shielding plate	PC / German silver
3	Flathead screws M 2.5 x 10.0 DIN 7985	Galvanized steel
4	Strain relief (upper part)	Die-cast zinc
5	Terminal (lower part)	Die-cast zinc
6	Cover plate $\varnothing$ 6.0 mm	PC
7	Cover plate $\varnothing$ 9.0 mm (only 25 and 37 pin)	PC
8	Connector housing lower part with riveted shielding plate	PC / German silver
9	Knurled screws M3 or #4/40	Galvanized steel / PC

## Ordering information

### Kits of cable connector housing Series KSG 200

Cable connector housings of the series KSG 200 are supplied as kits or as spare parts.  
The internal shielding plates are permanently attached by rivets.

**Standard packaging unit contains 1 pcs as kits.**

**Larger packaging units are also available on request (e.g. a complete package contains 250 pcs).**

	with riveted shielding plates incl. knurled screws M3		
Housing size			Packaged as kits Part-No.
9			063 385
15			063 384
25			063 383
37			063 380
50			—

	with riveted shielding plates incl. knurled screws #4/40		
Housing size			Packaged as kits Part-No.
9			063 389
15			063 388
25			063 387
37			063 386
50			-



## Structure of KSG 200 with construction details for shielding and ESD protection

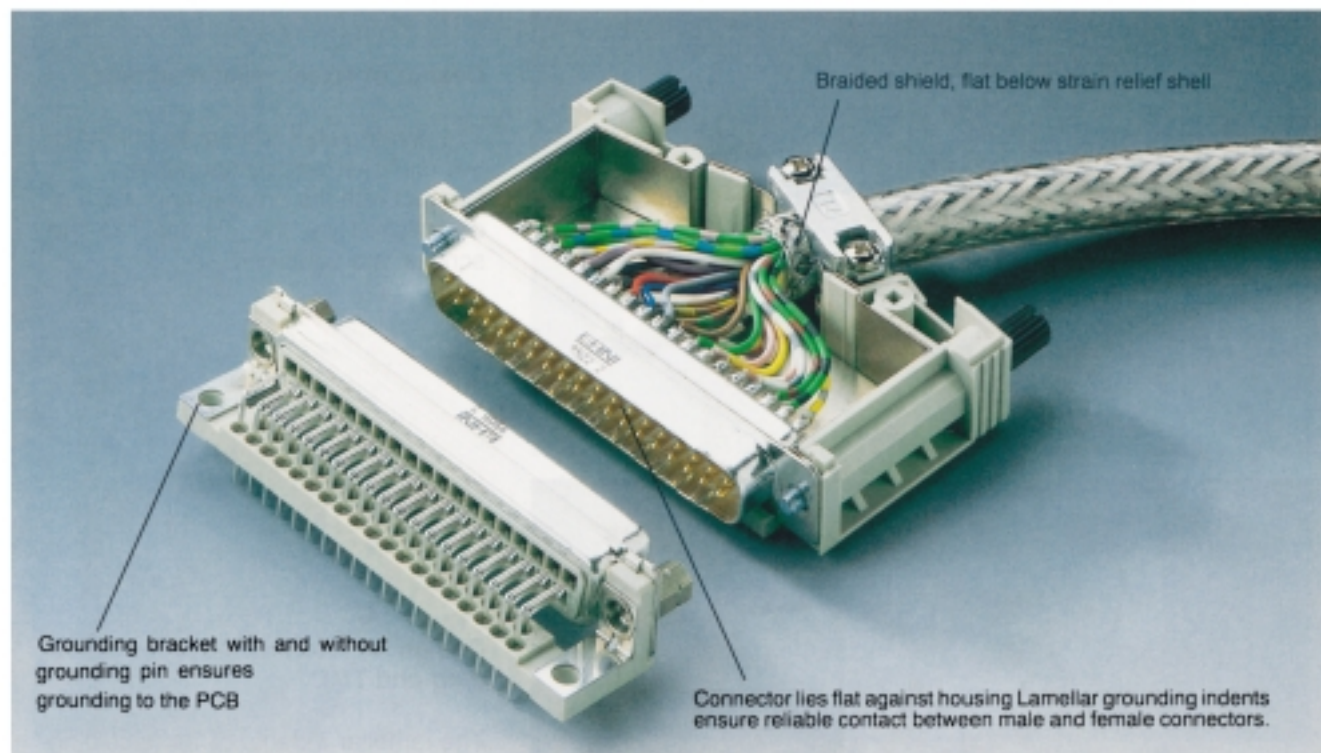

## Shield attenuation diagram, measured using wire injection method

