

PLEASE CHECK WWW.MOLEX.COM FOR LATEST PART INFORMATION

Part Number: [0671712001](#)
Status: **Obsolete**
Overview: [usb](#)
Description: Universal Serial Bus, Shielded I/O, Type B Receptacle, Vertical, 4 Circuits, 0.76µm (30µ") Gold (Au), Color Black, Lead Free

Documents:
[Drawing \(PDF\)](#)

General

Product Family	I/O Connectors
Series	67171
Application	Wire-to-Board
Comments	Single
Component Type	Receptacle
Overview	usb
Product Name	USB
Type	B

Physical

Boot Color	N/A
Circuits (Loaded)	4
Circuits (maximum)	4
Gender	Female
Lock to Mating Part	Yes
Material - Plating Mating	Gold
Material - Plating Termination	Tin
Number of Rows	2
Orientation	Vertical
PC Tail Length (in)	0.110 In
PC Tail Length (mm)	2.80 mm
PCB Locator	Yes
PCB Retention	Yes
PCB Thickness Recommended (in)	0.063 In
PCB Thickness Recommended (mm)	1.60 mm
Packaging Type	Tray
Panel Mount	No
Pitch - Mating Interface (in)	0.098 In
Pitch - Mating Interface (mm)	2.50 mm
Pitch - Term. Interface (in)	0.098 In
Pitch - Term. Interface (mm)	2.50 mm
Plating min: Mating (µin)	30
Plating min: Mating (µm)	0.76
Plating min: Termination (µin)	50
Plating min: Termination (µm)	1.30
Polarized to Mating Part	Yes
Polarized to PCB	Yes
Ports	1
Surface Mount Compatible (SMC)	Yes
Temperature Range - Operating	0°C to +50°C
Termination Interface: Style	Through Hole
Waterproof / Dustproof	No
Wire Size AWG	N/A

Electrical

Current - Maximum per Contact	1.5A
-------------------------------	------



image - Reference only

Series

EU RoHS

**ELV and RoHS
Compliant**
REACH SVHC
 Not Reviewed
**Halogen-Free
Status**

China RoHS



**Need more information on product
environmental compliance?**

Email productcompliance@molex.com
 For a multiple part number RoHS Certificate of Compliance, [click here](#)

Please visit the [Contact Us](#) section for any non-product compliance questions.

Search Parts in this Series

[67171Series](#)

Mates With

USB Type B Plug, [88732](#) Cable Assembly

Shield Type	Full Shield
Shielded	Yes
Voltage - Maximum	30V (RMS)

Solder Process Data

Duration at Max. Process Temperature (seconds)	5
Lead-free Process Capability	Reflow Capable (SMT only)
Max. Cycles at Max. Process Temperature	1
Process Temperature max. C	260

Material Info**Reference - Drawing Numbers**

Packaging Specification	PK-67488-001
Product Specification	PS-67998-0000
Sales Drawing	SD-67171-001

This document was generated on 06/07/2010

PLEASE CHECK WWW.MOLEX.COM FOR LATEST PART INFORMATION

NOT FOR IR REFLOW PROCESS

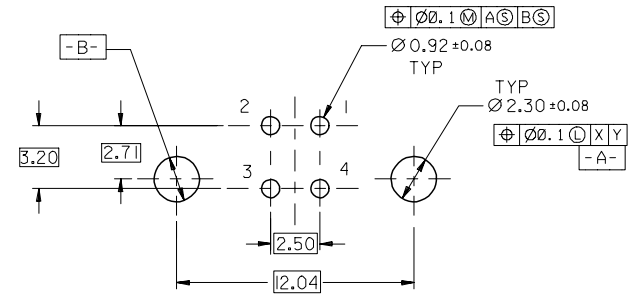
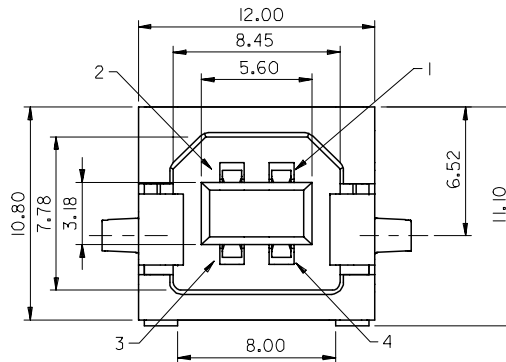
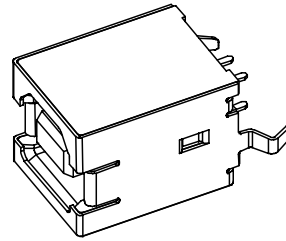
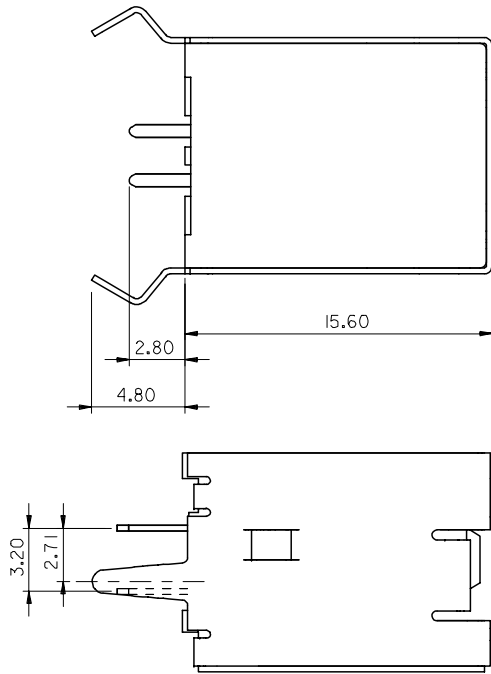

RECOMMENDED PCB LAYOUT

NOTES :

1. MATERIAL :
 - HOUSING : HIGH TEMP. NYLON , GLASS FIBRE FILLED, UL94-V0 , COLOR:BLACK
 - POLYESTER , GLASS FIBRE FILLED, UL94-V0 , COLOR: WHITE
 - TERMINAL : PHOSPHOR BRONZE
 - METAL SHELL : COPPER ALLOY
2. PLATING :
 - TERMINAL :
 - CONTACT AREA : (a) GOLD FLASH.
 - (b) GOLD (Au), THICKNESS = 30 MICROINCH MINIMUM.
 - /0.76 MICROMETER MINIMUM.
 - SOLDER TAIL : (a) TIN-LEAD(Sn-Pb)ALLOY,
 - THICKNESS= 150 MICROINCH MINIMUM .
 - /3.8 MICROMETER MINIMUM.
 - (b) PURE TIN PLATING
 - THICKNESS= 50 MICROINCH MINIMUM
 - /1.27 MICROMETER MINIMUM.
 - UNDER PLATE : NICKEL (Ni), THICKNESS= 50 MICROINCH MINIMUM.
 - /1.27 MICROMETER MINIMUM.
 - METAL SHELL :
 - (a) TIN-LEAD (Sn-Pb) ALLOY, THICKNESS= 100 MICROINCH MINIMUM.
 - /2.54 MICROMETER MINIMUM.
 - (b) PURE TIN PLATING, THICKNESS= 50 MICROINCH MINIMUM
 - /1.27 MICROMETER.
 - UNDER PLATE : NICKEL (Ni), THICKNESS= 50 MICROINCH MINIMUM.
 - /1.27 MICROMETER MINIMUM.
- 3 RECOMMENDED PCB THICKNESS : 1.60±0.05 mm
- 4 PRODUCT SPECIFICATION : REFER TO PS-67998-0000

PART NUMBER LEGEND:

P/N	COLOR	CONTACT PLATING	SHELL AND SOLDER TAIL PLATING
67171-0000	BLACK	GOLD FLASH	TIN-LEAD PLATING
67171-0001	BLACK	0.76 MICROMETER/ 30 MICROINCH GOLD	
67171-2000	BLACK	GOLD FLASH	PURE TIN PLATING (LEAD-FREE)
67171-2001	BLACK	0.76 MICROMETER/ 30 MICROINCH GOLD	
67171-3000	WHITE	GOLD FLASH	
67171-3001	WHITE	0.76 MICROMETER/ 30 MICROINCH GOLD	

DELETE NON ROHS PRODUCTS EC NO: SH2006-0759 DRWN:FYANG05 CHKD:HWANG APPR: JNCHEN	2006/10/26 2006/10/28 2006/11/14	DESCRIPTION REV	QUALITY SYMBOLS	GENERAL TOLERANCES (UNLESS SPECIFIED)	DIMENSION STYLE	SCALE	DESIGN UNITS	THIRD ANGLE PROJECTION
			$\nabla=0$ $\nabla C=0$	mm INCH	MM ONLY	4:1	METRIC	
			4 PLACES ± --- ± --- 3 PLACES ± --- ± --- 2 PLACES ± 0.25 ± --- 1 PLACE ± 0.25 ± --- ANGULAR ± 3 °	DRAWN BY: VL IN DATE: 1998/05/06 CHECKED BY: DATE: 1998/05/06 APPROVED BY: MEGA LIN DATE: 1998/05/06	TITLE	USB B VERTICAL CONNECTOR		
			DRAFT WHERE APPLICABLE MUST REMAIN WITHIN DIMENSIONS	MATERIAL NO. SEE CHART	MOLEX INCORPORATED	DOCUMENT NO. SD-67171-001	SHEET NO. 1 OF 1	
			THIS DRAWING CONTAINS INFORMATION THAT IS PROPRIETARY TO MOLEX INCORPORATED AND SHOULD NOT BE USED WITHOUT WRITTEN PERMISSION					