

# Type SF Dual, Round & Oval, Oil-Filled Motor Run Capacitors

## Type SF Dual Oval

Case Code	Dimensions (Inches)		
	A	B	H
C	1.91	2.91	See Ratings Table
D	1.97	3.66	See Ratings Table

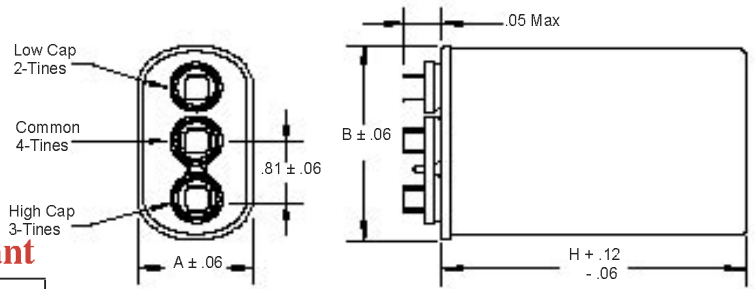

## Ratings ————— RoHS Compliant

Cap ( $\mu\text{F}$ - $\mu\text{F}$ )	Catalog Part Number	Case Code	H (Inches)
<b>370 Vac Oval 70 °C Case Temperature</b>			
15-5	SFC37S15-5K303E-F	C	3.03
15-10	SFC37S15-10K303E-F	C	3.03
20-5	SFC37S20-5K303E-F	C	3.03
20-7.5	SFC37S20-7.5K303E-F	C	3.03
20-10	SFC37S20-10K303E-F	C	3.03
25-5	SFC37S25-5K303E-F	C	3.03
25-7.5	SFC37S25-7.5K303E-F	C	3.03
25-10	SFC37S25-10K303E-F	C	3.03
25-15	SFC37S25-15K391E-F	C	3.91
30-5	SFC37S30-5K391E-F	C	3.91
30-7.5	SFC37S30-7.5K391E-F	C	3.91
30-10	SFC37S30-10K391E-F	C	3.91
30-15	SFC37S30-15K391E-F	C	3.91
30-20	SFC37S30-20K391E-F	C	3.91
35-5	SFC37S35-5K391E-F	C	3.91
35-7.5	SFC37S35-7.5K391E-F	C	3.91
35-10	SFC37S35-10K391E-F	C	3.91
35-15	SFC37S35-15K391E-F	C	3.91
35-20	SFC37S35-20K391E-F	C	3.91
40-5	SFC37S40-5K391E-F	C	3.91
40-7.5	SFC37S40-7.5K391E-F	C	3.91
40-10	SFC37S40-10K391E-F	C	3.91
40-15	SFD37S40-15K391E-F	D	3.91
45-5	SFD37S45-5K391E-F	D	3.91
45-7.5	SFD37S45-7.5K391E-F	D	3.91
45-10	SFD37S45-10K391E-F	D	3.91
45-15	SFD37S45-15K391E-F	D	3.91
50-5	SFD37S50-5K391E-F	D	3.91
50-7.5	SFD37S50-7.5K391E-F	D	3.91
50-10	SFD37S50-10K391E-F	D	3.91
60-5	SFD37S60-5K491E-F	D	4.91
60-7.5	SFD37S60-7.5K491E-F	D	4.91
60-10	SFD37S60-10K491E-F	D	4.91
70-5	SFD37S70-5K491E-F	D	4.91
70-7.5	SFD37S70-7.5K491E-F	D	4.91
70-10	SFD37S70-10K491E-F	D	4.91
80-5	SFD37S80-5K491E-F	D	4.91
80-7.5	SFD37S80-7.5K491E-F	D	4.91
80-10	SFD37S80-10K491E-F	D	4.91

## Hardware and Brackets:

For Capacitor Hardware, refer to page 5.000

## Ratings ————— RoHS Compliant

Cap ( $\mu\text{F}$ - $\mu\text{F}$ )	Catalog Part Number	Case Code	H (Inches)
<b>440 Vac Oval 70 °C Case Temperature</b>			
15-5	SFC44S15-5K303E-F	C	3.03
15-10	SFC44S15-10K303E-F	C	3.03
20-5	SFC44S20-5K303E-F	C	3.03
20-7.5	SFC44S20-7.5K303E-F	C	3.03
20-10	SFC44S20-10K303E-F	C	3.03
25-5	SFC44S25-5K391E-F	C	3.91
25-7.5	SFC44S25-7.5K391E-F	C	3.91
25-10	SFC44S25-10K391E-F	C	3.91
25-15	SFC44S25-15K391E-F	C	3.91
30-5	SFC44S30-5K391E-F	C	3.91
30-7.5	SFC44S30-7.5K391E-F	C	3.91
30-10	SFC44S30-10K391E-F	C	3.91
30-15	SFC44S30-15K391E-F	C	3.91
30-20	SFC44S30-20K391E-F	C	3.91
35-5	SFC44S35-5K491E-F	C	4.91
35-7.5	SFC44S35-7.5K491E-F	C	4.91
35-10	SFC44S35-10K491E-F	C	4.91
35-15	SFC44S35-15K491E-F	C	4.91
35-20	SFC44S35-20K491E-F	C	4.91
40-5	SFD44S40-5K491E-F	D	4.91
40-7.5	SFD44S40-7.5K491E-F	D	4.91
40-10	SFD44S40-10K491E-F	D	4.91
40-15	SFD44S40-15K491E-F	D	4.91
45-5	SFD44S45-5K491E-F	D	4.91
45-7.5	SFD44S45-7.5K491E-F	D	4.91
45-10	SFD44S45-10K491E-F	D	4.91
45-15	SFD44S45-15K491E-F	D	4.91
50-5	SFD44S50-5K491E-F	D	4.91
50-7.5	SFD44S50-7.5K491E-F	D	4.91
50-10	SFD44S50-10K491E-F	D	4.91
60-5	SFD44S60-5K616E-F	D	6.16
60-7.5	SFD44S60-7.5K616E-F	D	6.16
60-10	SFD44S60-10K616E-F	D	6.16