

Spice Model

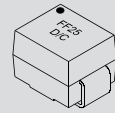

MD90FF25



Part Number	Working Reverse Voltage (V _{rw})	Average Rectified Current (I _o)		Reverse Current @ V _{rw} (I _r)		Forward Voltage (V _f)		1 Cycle Surge Current t _p =8.3ms (I _{fsm})	Repetitive Surge Current (I _{frm})	Reverse Recovery Time (3) (T _{rr})	Thermal Impd. J-L	Junction Cap. @50VDC @1kHz (C _j)	Markings
		55°C(1)	100°C(2)	25°C	100°C	25°C	25°C	25°C	25°C	25°C	25°C	25°C	
	Volts	Amps	Amps	µA	µA	Volts	Amps	Amps	Amps	ns	°C / W	pF	
MD90FF25	2500	0.35	0.20	1.0	25	6.2	0.50	10	2.5	30	26	10	FF25

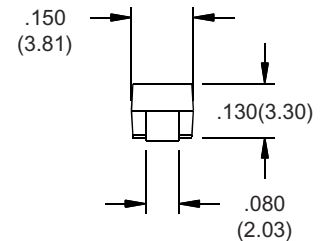
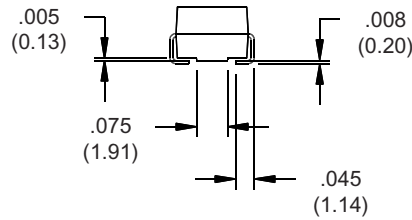
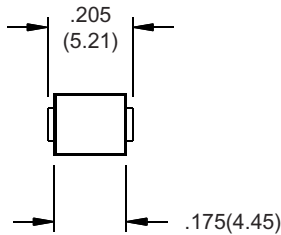

NAME	PARAMETER	VALUE	UNITS
IS	Reverse leakage current	1.00E-06	Amps
N	Emission coefficient	16.5	
T	Temperature	25	C
RS	Diode series resistance	1.9	Ohm
TT	Transit time	30	nS
CJ0	Zero-bias junction capacitance	18.23	pF
VJ	Bulk junction potential	1.41	Volts
M	Grading coefficient	0.5	
EG	Energy-band gap	1.11	Volts
XTI	Temperature coefficient	3	
KF	Flicker-noise coefficient	0	
AF	Flicker-noise exponent	1	
FC	Coefficient for capacitance	0.5	
BV	Diode breakdown voltage	2500	Volts
IBV	Diode breakdown current	100	uAmps



Voltage Multipliers, Inc.
8711 W. Roosevelt Ave.
Visalia, CA 93291

Tel (559) 651-1402
Fax (559) 651-0740
www.voltagemultipliers.com