

707480 707491 707508

ML9

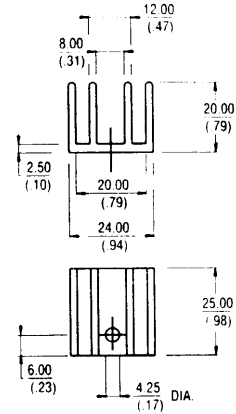

Model R_{θ} ($^{\circ}\text{C}/\text{W}$)
ML9-----13.2

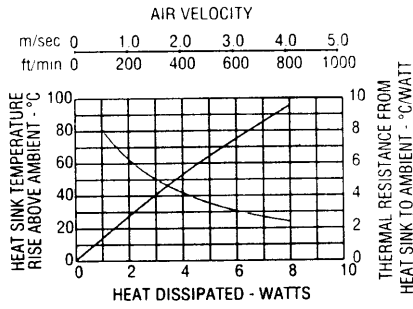
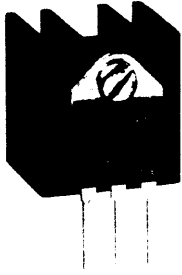

UNIVERSAL HEAT SINKS

6296 Series, ML 97 Series



Model	Dim. A mm (inches)	Dim. B mm (inches)	Dim. C mm (inches)	R_{θ} ($^{\circ}\text{C}/\text{W}$)	Notes
6296B	-- 25.40 (1.000)	-- 21.59 (.850)	-- 3.81 (.150)	-- 4.7	▲
6298B	-- 38.10 (1.500)	-- 21.59 (.850)	-- 3.81 (.150)	-- 3.9	▲
ML97/1	-- 38.10 (1.500)	-- 21.59 (.850)	-- 3.60 (.142)	-- 3.9	---
6299B	-- 50.80 (2.000)	-- 21.59 (.850)	-- 3.81 (.150)	-- 3.6	▲
ML97/1.5	-- 50.80 (2.000)	-- 21.59 (.850)	-- 3.60 (.142)	-- 3.6	---
6300B	-- 63.50 (2.500)	-- 21.59 (.850)	-- 3.81 (.150)	-- 3.1	▲
ML97/2	-- 63.50 (2.500)	-- 21.59 (.850)	-- 3.60 (.142)	-- 3.1	---

Model	Dim. A mm (inches)	Dim. B mm (inches)	Dim. C mm (inches)	R_{θ} ($^{\circ}\text{C}/\text{W}$)
6298B-2*	-- 38.10 (1.500)	-- 18.29 (.720)	--- 3.81 (.150)	-- 3.9
6299B-2*	-- 50.80 (2.000)	-- 18.29 (.720)	--- 3.81 (.150)	-- 3.6
6300B-2*	-- 63.50 (2.500)	-- 18.29 (.720)	--- 3.81 (.150)	-- 3.1

* Available, but not normally stocked.

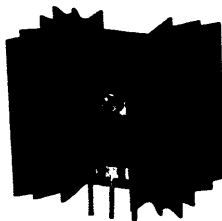

▲ 6298B

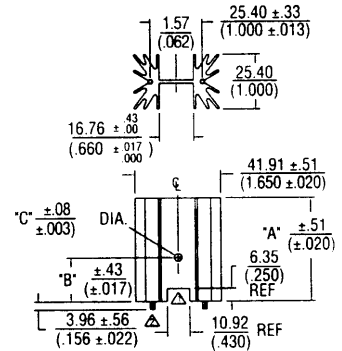
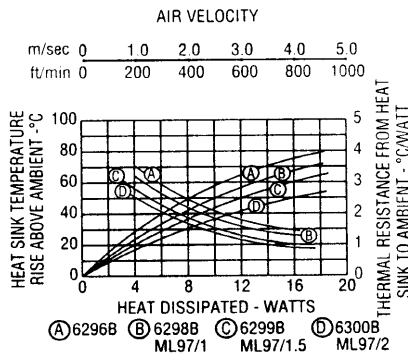

Notes: To order optional solderable roll pin with shoulder for the 6296 Series, add "P2" after model number, e.g. 6298B-P2. Shoulder is 1.27 ± .38/.13 (.050 ± .015/.005) thick. These parts are also available without roll pins: 6292B is 38.10mm (1.5") tall without roll pins, 6293B is 50.80mm (2.0") tall without roll pins, and 6294B is 63.50mm (2.5") tall without roll pins. Tolerances are ±.25 (.010) unless otherwise specified.

The Productivity Enhancements shown in the circles above are for use with the 6296 Series only

▲ 6.35 (.250) x 10.92 (.430) notch on these parts only

▲ Solderable roll pin (P1) standard as shown.

ML33



Model R_{θ} ($^{\circ}\text{C}/\text{W}$)
ML33-----8.5

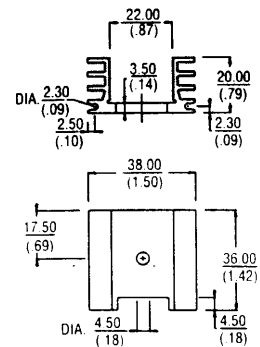
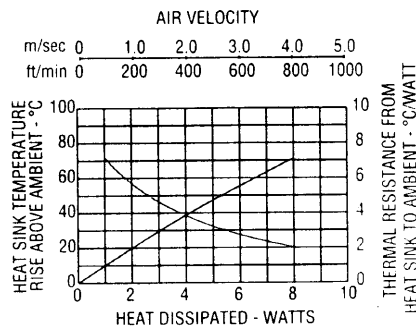
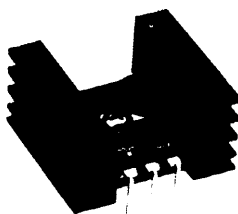

(.23)  4.25 DIA.
(.17)



Dim. A mm (inches)	Dim. B mm (inches)	Dim. C mm (inches)	R _θ (°C/W)
3.10 (1.500)	-- 18.29 (.720)	--- 3.81 (.150)	-- 3.9
3.80 (2.000)	-- 18.29 (.720)	--- 3.81 (.150)	-- 3.6
3.50 (2.500)	-- 18.29 (.720)	--- 3.81 (.150)	-- 3.1

able, but not normally stocked.

SINK TO AMBIENT - °C/WATT

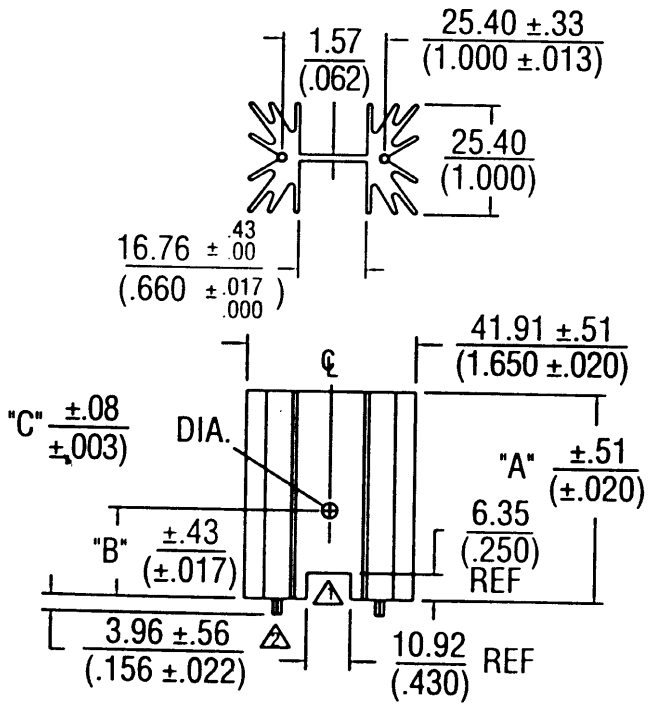

- 1 6.35 (.250) x 10.92 (.430) notch on these parts only
- 2 Solderable roll pin (P1) standard as shown.