

G Series Connectors (Continued)

**Right Angle
PC Board Mount Plug**

Includes board retention feature to prevent tipping during solder process.
Tin-lead plated body to facilitate soldering process.



Part No. 415406-2

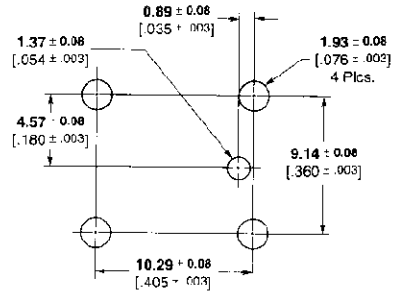

PC Board Layout

**Vertical PC Board
Mount Plug**

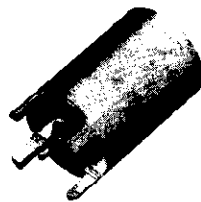

Part No. 1274045-1

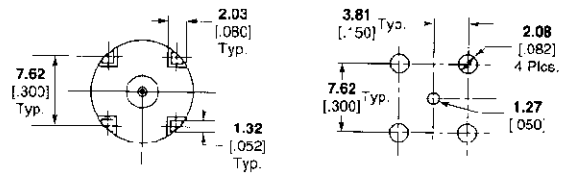

PC Board Layout

Adapters

**F Jack to G Jack
Bulkhead Adapter Sealed**



Part No. 887058-1

**F Jack to G Jack
Bulkhead Adapter**



Part No. 415327-1

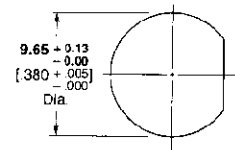

Recommended Panel Cutout

**F Jack to G Plug
Bulkhead Adapter**

Connector will accept center conductor diameter range of 0.51-1.19 [.020-.047].

Panel nut 887003-3 available for float mounting.



Part No. 415523-1

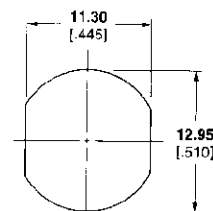

Recommended Panel Cutout