

REV A	AUTH JLE	DATE 10/17/02	INITIAL RELEASE
REV B	AUTH RL	DATE 05/14/04	CORRECTED FREQ. NOTES.
REV C	AUTH RL	DATE 10/26/06	TOLERANCES REVISED; FORMAT UPDATE, REDESIGNATED AS 5231W

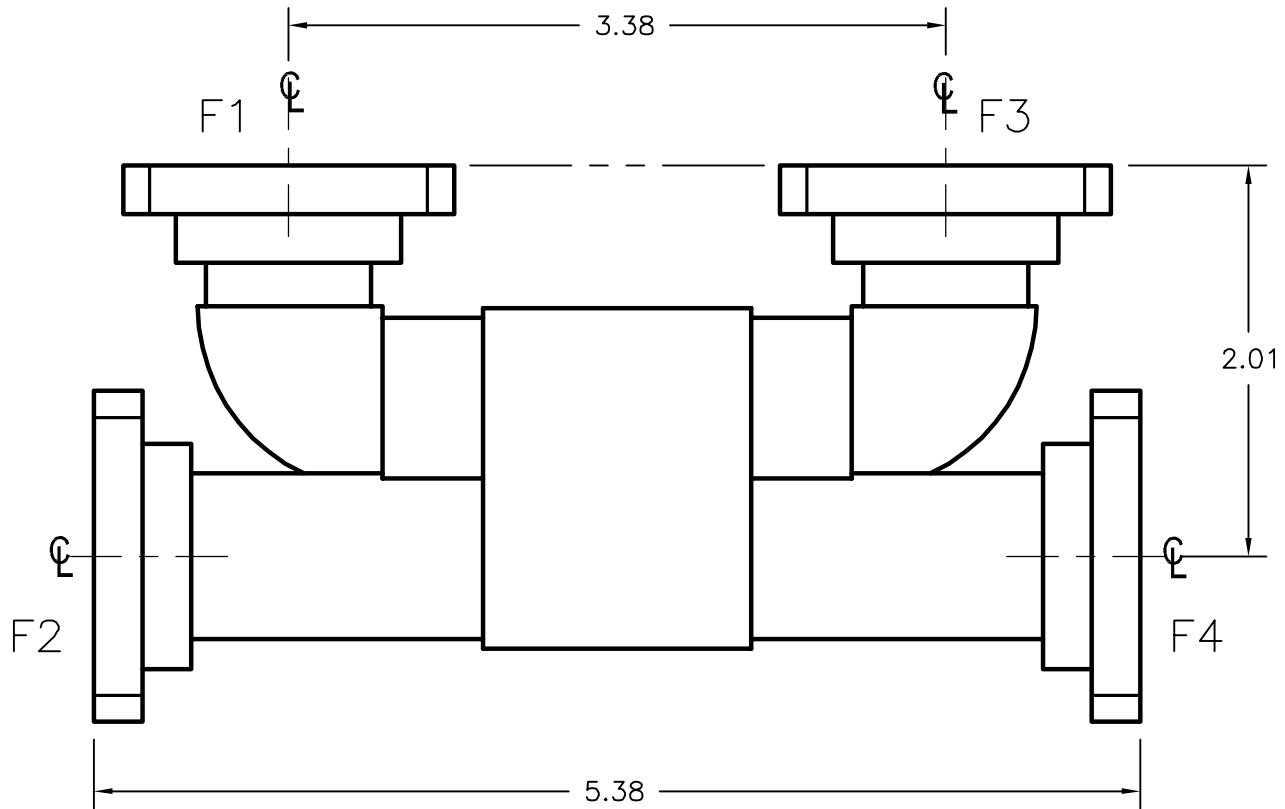

FLANGE TYPE
1 = CPRG
2 = CPRF
6 = UG COVER
7 = UG CHOKE
8 = COVER GROOVE

FREQUENCY	MODEL
10.0–11.6 GHz	75–261A–Z–F1–F2–F3–F4
11.6–13.4 GHz	75–262A–Z–F1–F2–F3–F4
13.0–15.0 GHz	75–263A–Z–F1–F2–F3–F4

NOTE: REPLACE "F1, F2, F3, & F4" NOTATION WITH NUMBER CORRESPONDING TO FLANGE TYPE DESIRED, AS SHOWN ON TABLE ABOVE.

THIRD ANGLE PROJECTION:		APPROVALS	DATE	ADVANCED TECHNICAL MATERIALS, INC. TEL: (631) 289-0363 FAX: (631) 289-0358 www.atmmicrowave.com	<small>THE INFORMATION IN THIS DRAWING IS PROPRIETARY AND SHALL NOT BE USED OR DISCLOSED WITHOUT THE PRIOR WRITTEN CONSENT OF ATM INC. DO NOT SCALE DWG.</small>
UNLESS OTHERWISE NOTED, DIMENSIONS ARE IN INCHES. TOLERANCES ARE: FRACTIONS: $\pm 1/64$ ANGLES: $\pm 1/2^\circ$		DRAWN RL	10/26/06		
BASIC DIMENSION	DECIMALS 2 PLACE 3 PLACE	CHKD.	APRVD.	OUTLINE, WR75 Z–STYLE COMBINER–DIVIDER (HYBRID COUP.)	
UNDER 6"	±.02 ±.005	MATERIAL PER ORDER			
6" – 12"	±.03 ±.010	TREATMENT -			
OVER 12"	±.06 ±.015	FINISH ATM GRAY		SIZE A	CAGE CODE 0R8N4
				ATM DWG # 5231W	REVISION C
				SCALE 1 : 1	SHEET 1/1
				MODEL # 75–26XX–Z–F1–F2–F3–F4	