

## 2-Way Power Divider

P/N: JXWBGF-T-2-0.2-1000

Frequency Range(MHz)	0.2 - 1000
Insertion Loss(dB)	L: 0.2/0.8 Typ/Max
	M: 0.5/1.0 Typ/Max
	U: 0.9/1.2 Typ/Max
Isolation(dB)	L: 20/15 Typ/Min
	M: 25/20 Typ/Min
	U: 23/18 Typ/Min
Phase Unbalance(°)	4 max
Amplitude Unbalance(dB)	0.3 max
VSWR	1.5
Impedance(Ohm)	50
Connector	BNC
Operating Temperature(°C)	-40 ~ +80
Storage Temperature(°C)	-55 ~ +85

### Outline Drawing (Size: mm)

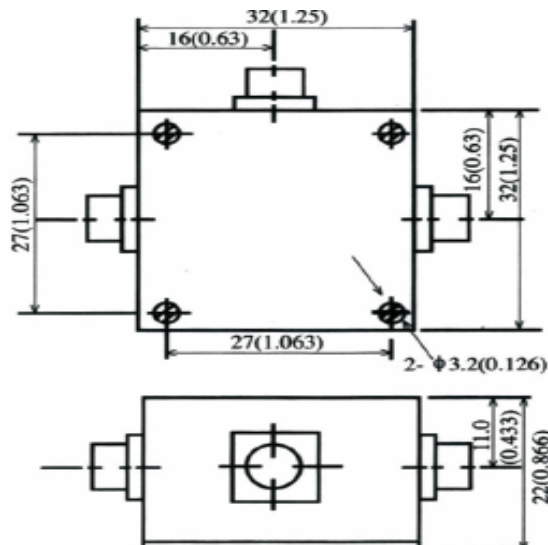

For current data sheets, please contact: [sales@aacix.com](mailto:sales@aacix.com)