



SW6620W(6V180Ah)



Specifications

Nominal Voltage	6V	
CAPACITY(15 minutes rate to 1.67V/cell)	620W	
Rated capacity (10 hour rate)	180Ah	
Dimensions	Total Height	229 mm (9.02 inches)
	Height	224 mm (8.93 inches)
	Length	323 mm (12.7 inches)
	Width	178 mm (7.01 inches)
Weight Approx	30 Kg (66.1 lbs)	

Characteristics

Capacity 25°C(77°F)	30min rate 15min rate 5min rate	1121W 1860W 3282W
Internal Resistance	Full charged Battery at 25°C(77°F)	1.5 mΩ
Capacity affected by Temperature (20hour rate)	40°C(104°F) 25°C(77°F) 0°C(32°F) -15°C(5°F)	102% 100% 85% 65%
Self-Discharge at 25°C(77°F)	Capacity after 3 month storage Capacity after 6 month storage Capacity after 12 month storage	91% 82% 64%
Terminal	T10、T19	
Charge (constant Voltage)	Cycle	Initial Charging Current less than 36A Voltage 7.05-7.20V
	Float	Voltage 6.75-6.90V

Constant power discharge :watts(25°C, 77 °F)

	5min	10min	15min	20min	30min	45min	60min	90min
4.8V	3282	2455	1902	1568	1169	861	675	502
5.0V	3142	2375	1860	1541	1142	829	659	485
5.1V	3001	2285	1817	1504	1121	818	643	468
10.5V	2864	2232	1770	1477	1100	792	616	446
10.8V	2724	1998	1568	1371	978	707	558	428
11.1V	2426	1785	1424	1265	909	664	524	407

Outer dimensions (mm)

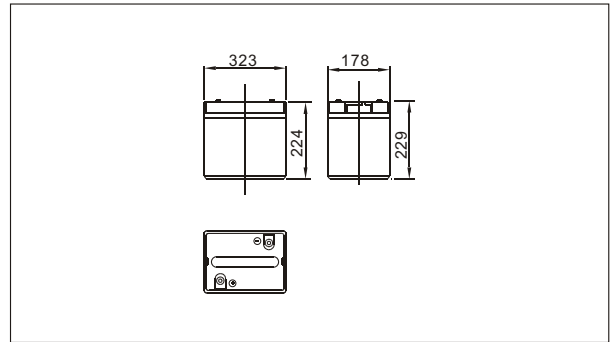

Terminal Type (mm)

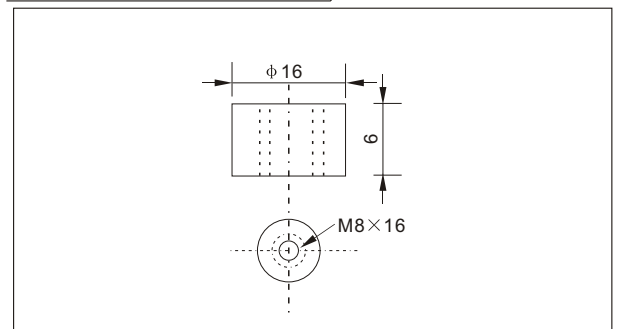

Discharge Curves 25°C(77°F)

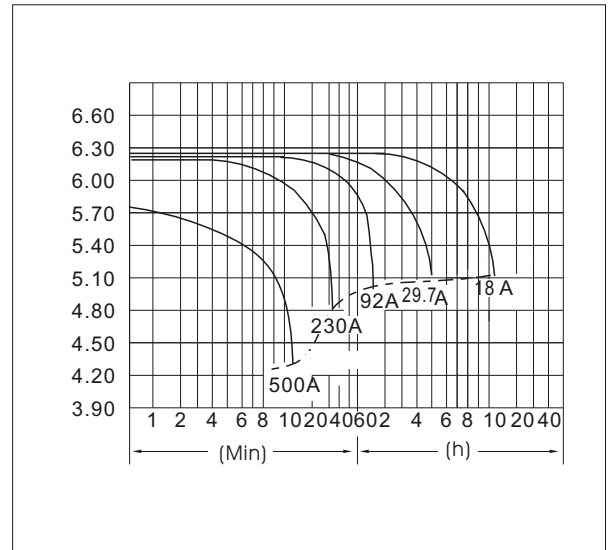

Constant current discharge unit:A(25°C, 77 °F)

	5min	15min	30min	45min	60min	90min	5h	10h
4.8V	679.8	392.1	239.9	175.4	136.9	101.6	30.3	19.7
5.0V	643.7	376.5	230.2	166.4	130.9	96.4	29.9	19.3
5.1V	598.7	362.8	222.4	162.7	126.6	92.3	29.7	18.9
5.25V	553.6	339.4	206.8	149.4	115.5	86.6	29.3	18.0
5.4V	527.9	300.4	186.9	135.0	106.3	81.2	29.0	17.8
5.55V	463.5	275.1	174.4	126.6	99.7	77.1	28.3	17.4