

P-tec Corp. Tel:(800)688-0613  
 2405 Commerce Circle Tel:(719) 589 3122  
 Alamosa Co. 81101 Fax:(719) 589 3592  
 www.p-tec.net sales@p-tec.net



## PL00290 Series SMD LED Right Angle 1204 Package

### Features

- \*Oval Lens Side View Package 3.0 x 1.5 x 1.0mm
- \*AlGaInP Ultra Bright Orange-Red Chip used
- \*Low Current Requirements
- \*High Light Output
- \*Compatible with IR Solder-Process
- \*Industry Standard Footprint
- \*2000 or 1000 pcs per Reel
- \*RoHS Compliant

### Absolute Maximum Ratings at $T_A = 25^\circ\text{C}$

|  |                      |
|--|----------------------|
| Power Dissipation .....  | 130mW                |
| Reverse Voltage (<100 $\mu\text{A}$ ) .....                    | 5.0V                 |
| Max Forward Current .....                                      | 50mA                 |
| Peak Forward Current(1/10 Duty Cycle, 0.1ms Pulse Width) ..... | 100mA                |
| Operating Temperature Range .....                              | -40°C to +85°C       |
| Storage Temperature Range .....                                | -40°C to +85°C       |
| Reflow Soldering Temperature.....                              | 260°C for 10 seconds |

### Electrical & Optical Characteristics at $T_A = 25^\circ\text{C}$

| Part Number      | Emitting Color | Chip Material | Peak Wave Length | Dominant Wave Length | Viewing Angle 2 $\theta$ 1/2 | Forward Voltage @20mA (V) |     | Luminous Intensity @20mA (mcd) |       |
|------------------|----------------|---------------|------------------|----------------------|------------------------------|---------------------------|-----|--------------------------------|-------|
|                  |                |               |                  |                      |                              | Typ                       | Max | Min                            | Typ   |
| Water Clear Lens |                |               | nm               | nm                   | Deg                          |                           |     |                                |       |
| PL00290-WCR10    | Orange-Red     | AlGaInP       | 632              | 624                  | 120°                         | 2.0                       | 2.6 | 90.0                           | 165.0 |

Package Dimensions are in **Millimeters**. Tolerance is  $\pm 0.25\text{mm}$  unless otherwise specified.

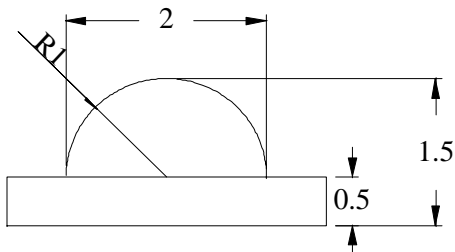
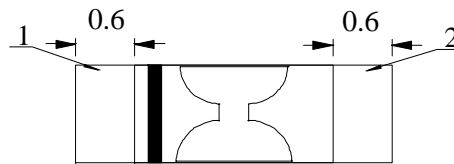
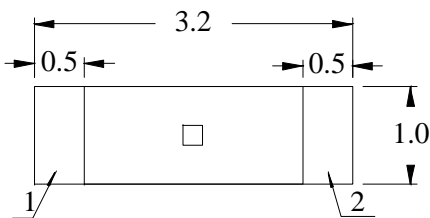

### Recommended Soldering Pad Layout

