

REV A	AUTH JLE	DATE 10/17/02	INITIAL RELEASE
REV B	AUTH RL	DATE 10/31/06	ILLUSTRATION, NOTES, FORMAT UPDATED.

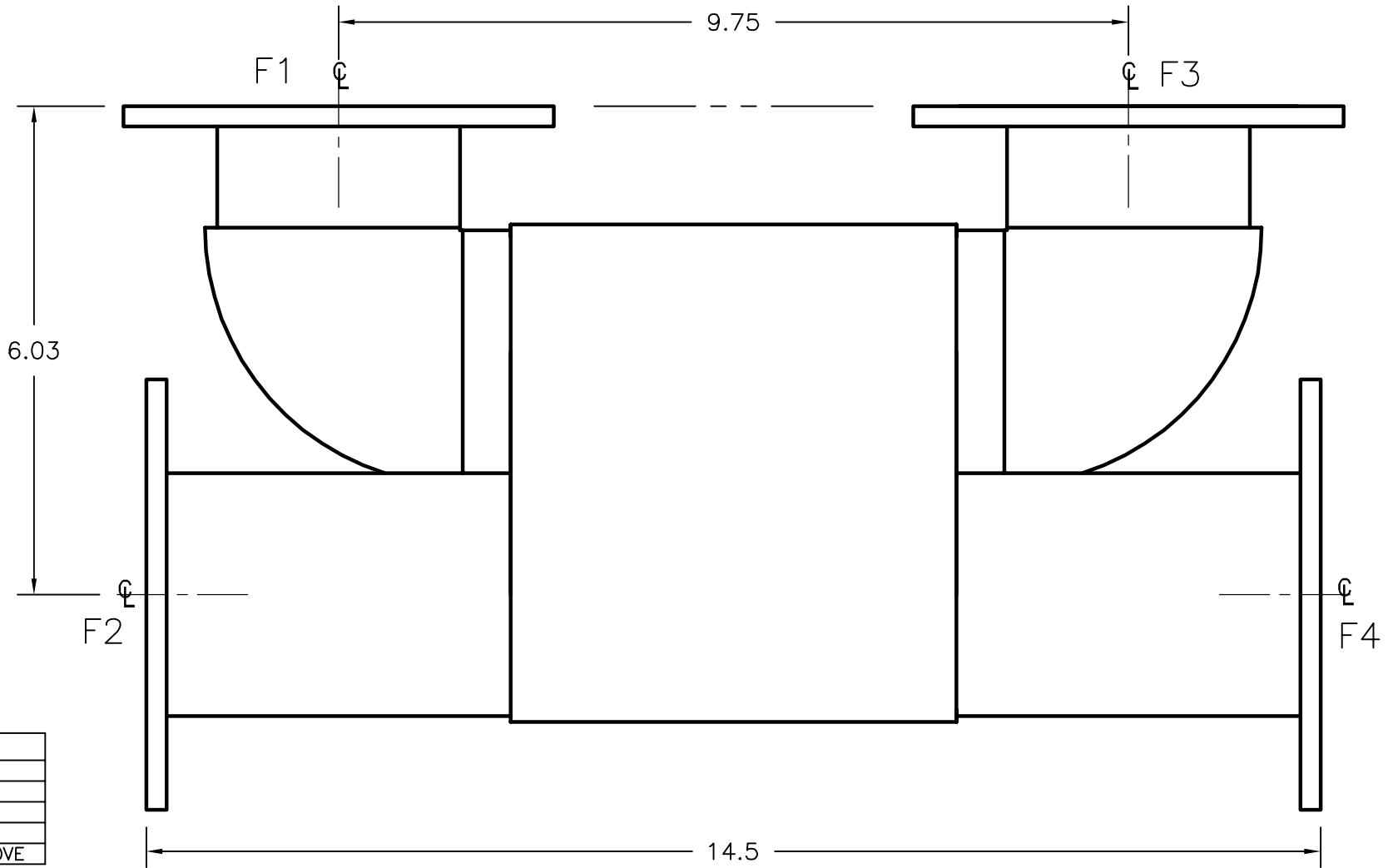

FLANGE TYPE	
1	= CPRG
2	= CPRF
6	= U/G COVER
7	= U/G CHOKE
8	= U/G COVER GROOVE

FREQUENCY	MODEL
2.66–2.99 GHz	284–261X–Z–F1–F2–F3–F4
2.99–3.44 GHz	284–262X–Z–F1–F2–F3–F4
3.44–3.95 GHz	284–263X–Z–F1–F2–F3–F4

NOTE: REPLACE "F1, F2, F3, & F4" NOTATION WITH NUMBER CORRESPONDING TO FLANGE TYPE DESIRED, AS SHOWN ON TABLE ABOVE.

THIRD ANGLE PROJECTION:		APPROVALS	DATE	ADVANCED TECHNICAL MATERIALS, INC. TEL: (631) 289-0363 FAX: (631) 289-0358 www.atmmicrowave.com	<small>THE INFORMATION IN THIS DRAWING IS PROPRIETARY AND SHALL NOT BE USED OR DISCLOSED WITHOUT THE PRIOR WRITTEN CONSENT OF ATM, INC. DO NOT SCALE DWG.</small>
UNLESS OTHERWISE NOTED, DIMENSIONS ARE IN INCHES. TOLERANCES ARE: FRACTIONS: $\pm 1/64$ ANGLES: $\pm 1/2^\circ$		DRAWN JLE	10/17/02		
BASIC DIMENSION	DECIMALS 2 PLACE 3 PLACE	CHKD.	APRVD.	OUTLINE, WR284 'Z'-STYLE COMBINER-DIVIDER (HYBRID-COUP.)	
UNDER 6"	$\pm .02$ $\pm .005$	MATERIAL PER ORDER			
6" – 12"	$\pm .03$ $\pm .010$	TREATMENT -			
OVER 12"	$\pm .06$ $\pm .015$	FINISH ATM STD. GRAY		SIZE A	CAGE CODE 0R8N4
				ATM DWG # 5221W	REVISION B
				SCALE 1 : 2	SHEET 1/1
				MODEL # SEE NOTES	