

DB ELECTRO^{CO., LTD.}

Présente / Presents:

NINGBO HUAGUAN ELECTRONICS CO., LTD.

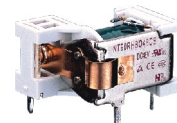



27.3×23×30.2(+20.3)

NVF9



Features

- Heavy contact load (30A).
- Insert mounting available.
- Suitable for automation system and automobile auxiliary etc.

Ordering Information

NVF9 A Z 30 a DC12V
 1 2 3 4 5 6

1 Part number: NVF9
 2 Contact arrangement: A:1A;
 3 Enclosure: Z: Dust cover;
 4 Contact current: 15:15A/24VDC; 30:30A/14VDC
 5 Terminals: a: plug in type
 6 Coil rated voltage(V): DC:6,12,24

Contact Data

Contact arrangement	1A (1H) (SPSTNO)		
Contact Material	AgSnO ₂ , AgNi		
Contact Rating (resistive)	30A/14VDC,15A/24VDC		
Max. Switching Power	420W		
Contact Resistance or Voltage drop	75VDC	Max. switching current:30A	
	≤100mV(at 30A)	Item 3.12 of IEC 255-7	
Operation life	Electrical	10 ⁵	Item 3.30 of IEC 255-7
	Mechanical	5×10 ⁶	Item 3.31 of IEC 255-7

Coil Parameter

Dash numbers	Coil voltage VDC		Coil resistance Ω ±10%	Pickup voltage VDC(max) (70% of rated voltage)	Release voltage VDC(min) (10% of rated voltage)	Coil power consumption W	Operate Time ms	Release Time ms
	Rated	Max.						
006-1440	06	7.8	25	4.2	0.6	1.44	≤7	≤5
012-1440	12	15.6	100	8.4	1.2			
024-1440	24	31.2	400	16.8	2.4			

CAUTION: 1.The use of any coil voltage less than the rated coil voltage will compromise the operation of the relay.
 2.Pickup and release voltage are for test purposes only and are not to be used as design criteria.

Operation condition

Insulation Resistance	100MΩ min. (500VDC)	Item 7 of IEC255-5
Dielectric Strength		
Between contacts	50Hz 500V	Item 6 of IEC255-5
Between contact and coil	50Hz 750V	Item 6 of IEC255-5
Shock resistance	147m/s ² 11ms	IEC68-2-27 Test Ea
Vibration resistance	10~60Hz double amplitude 1.5mm	IEC68-2-6 Test Fc
Terminals strength	8N	IEC68-2-21 Test Ua2
Solderability	235℃ ±2℃ 10±0.5s	IEC68-2-20 Test Ta method 1
Ambient Temperature	-40~85℃	
Relative Humidity	85% (40℃)	IEC68-2-3 Test Ca
Mass	40g	

Qualification inspection:

Perform the qualification test as specified in the table IV of IEC255-19-1 and minimum sample size 24.

Dimensions

mm /inch

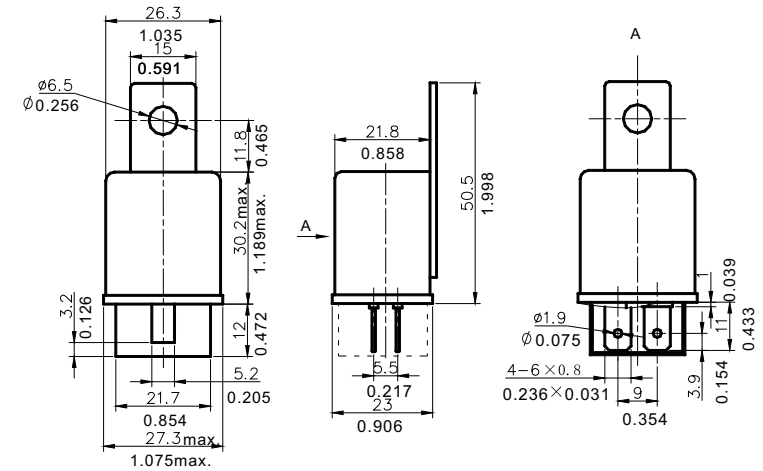

Dimensions

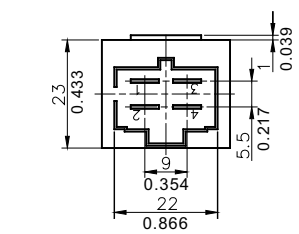

Mounting (Bottom view)

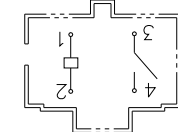

Wiring diagram (Bottom view)

NOTES 1).Dimensions are in millimeters.
 2).Inch equivalents are given for general information only.