

VICOR CONFIDENTIAL
 THIS DOCUMENT AND THE DATA DISCLOSED
 HEREIN OR HEREWITH IS NOT TO BE REPRODUCED,
 USED, OR DISCLOSED IN WHOLE OR IN PART
 TO ANYONE WITHOUT PERMISSION OF VICOR CORP.

REV.	DESCRIPTION	DATE	APPROVED
#1	RELEASED FOR DEVELOPMENT	DPK 11/17/97	SWN
#2	ADDED ±.010 TOL TO DIM	DPK 12/8/97	SWN
#3	REMOVED P/N STAMPING	DPK 8/24/98	SWN
#4	.40 WAS .400: ADDED 'O' TO .100 & .190	DPK 9/11/98	SWN
#5	ADDED NOTE 4, CRITICAL CHA. 'O'	AK 10/6/99	SWN

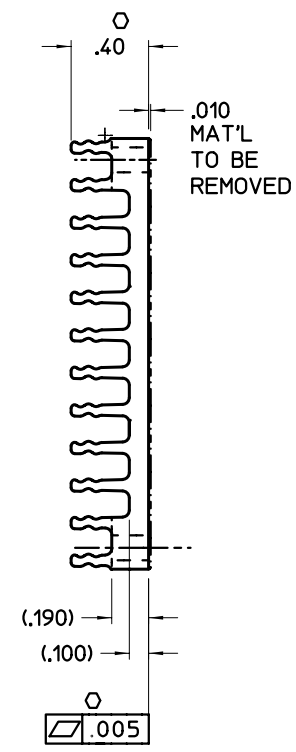
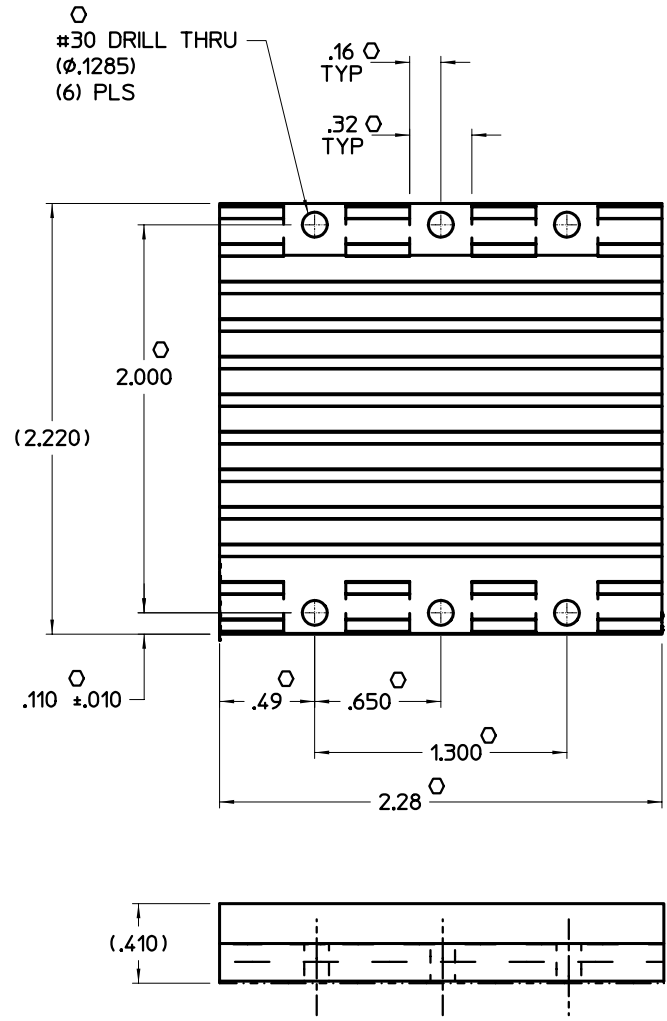

NOTES

1. MAKE FROM VICOR EXTRUSION P/N 17475.
2. REMOVE ALL BURRS AND SHARP EDGES.
3. FINISH: CLEAR CHROMATE.
4. 'O' DENOTES CRITICAL CHARACTERISTICS FOR LOT INSPECTION.

DRAWN BY D.P. KELLY	DATE 11/97		
<small>UNLESS OTHERWISE SPECIFIED DIMENSIONS ARE IN INCHES. TOLERANCES ARE: FRACTIONS DECIMALS ANGLES #/64 .00# ±.01 #° .00# ±.005 #°</small>		HTSNK "B" LONG .4H LOW FLOW, THRU HOLE	
THIRD ANGLE PROJECTION 	SIZE B 67131	DWG NO 18039	REV #5
DO NOT SCALE DRAWING	SCALE 2-1	SHEET 1 OF 1	