

SPECIFICATIONS

Contact Rating: As per individual switch
 Initial Contact Resistance: Less than 20 milliohms
 Insulation Resistance: 500VDC – 100 milliohms
 Dielectric Strength: 500V AC for 1 minute between any terminal and frame
 Operating Temperature: -20°C to +70°C (-4°F to +158°F)
 Soldering: Auto 270 ± 5°C/3 seconds; Manual 350 ± 10° C/3 seconds
 Life: 10,000 cycles minimum
 Timing: See individual specifications
 For special applications, contact factory

MATERIALS

Contact: Silver plated copper alloy

HOW TO ORDER

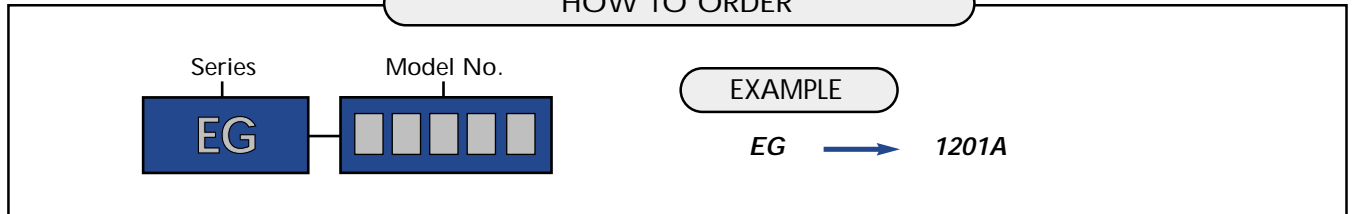

SPECIFICATIONS SUBJECT TO CHANGE WITHOUT NOTICE.

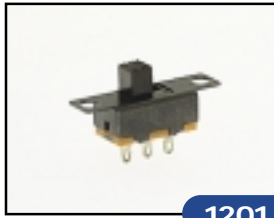

1201

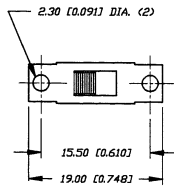

PANEL MOUNT

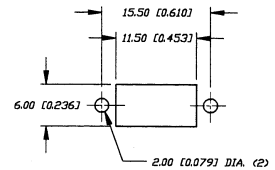

Model No.	L
EG1201	4
EG1201A	5.5

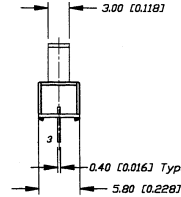
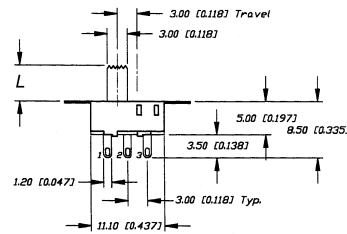

Schematic

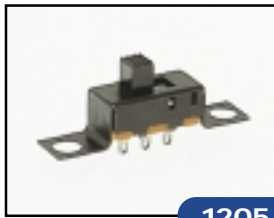
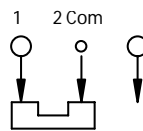

1205

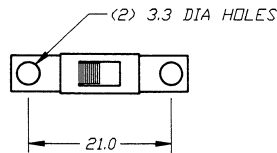

P.C. MOUNTING

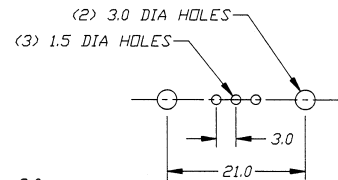

Model No.	L
EG1205	4
EG1205A	5.5

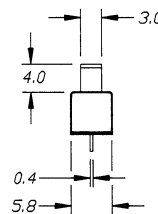
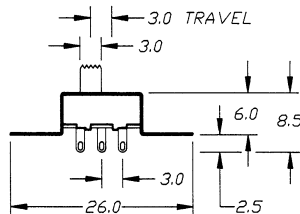

Schematic

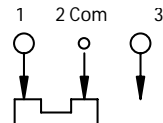

SERIES E G SWITCHES

SLIDE SWITCHES

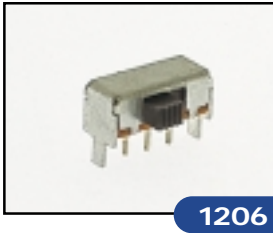

1206

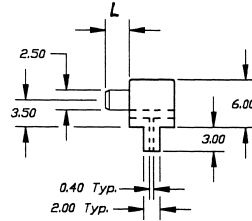
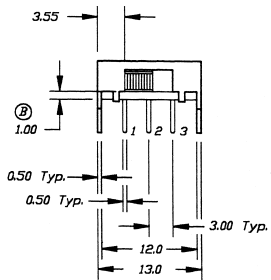
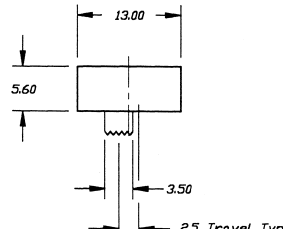

P.C. MOUNTING

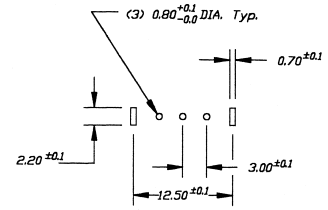

Schematic

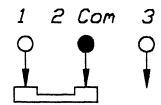

Model No.	L
EG1206	3
EG1206A	6

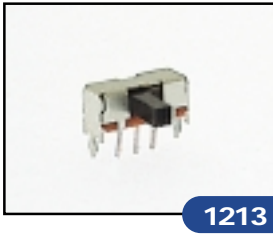

1213

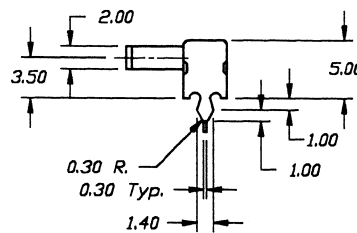
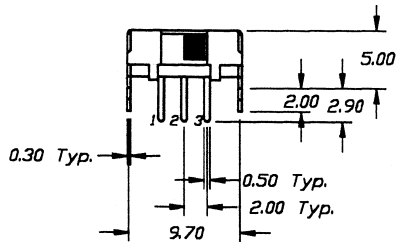
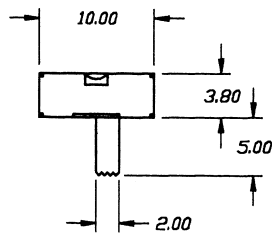

P.C. MOUNTING

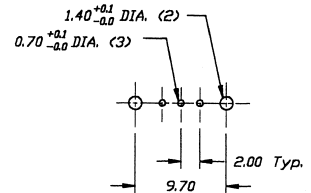

Schematic

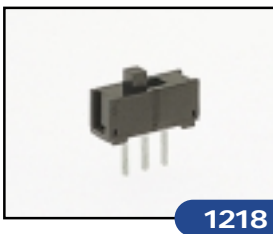
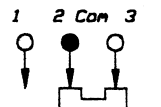

1218

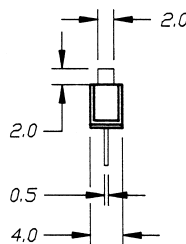
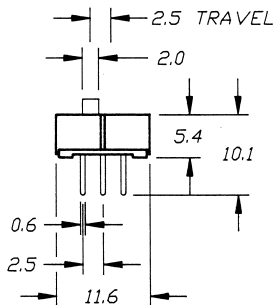

P.C. MOUNTING

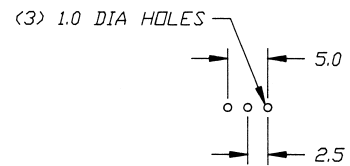

Schematic

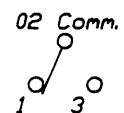

SPECIFICATIONS SUBJECT TO CHANGE WITHOUT NOTICE.

SERIES E G SWITCHES

SLIDE SWITCHES



1224

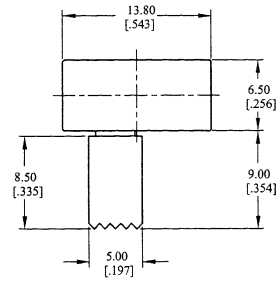

P.C. MOUNTING

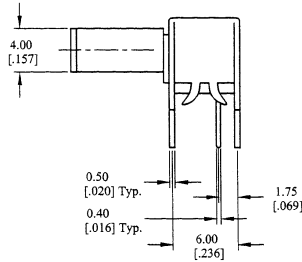
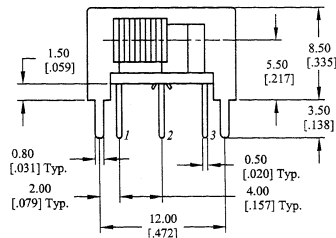
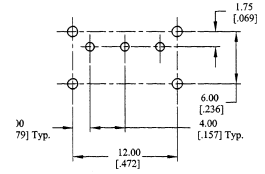

Schematic

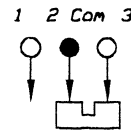

1247

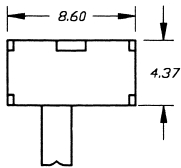

P.C. MOUNTING

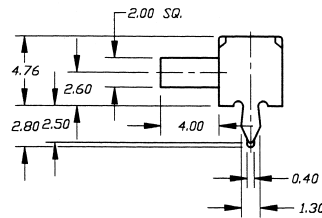
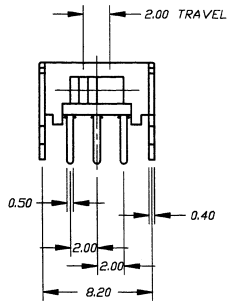
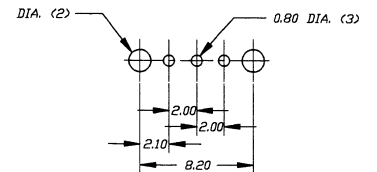

Schematic

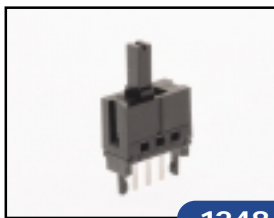
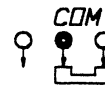

1248

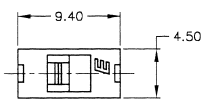

P.C. MOUNTING

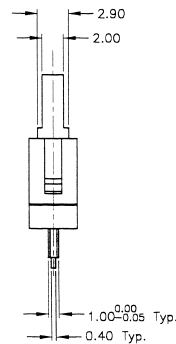
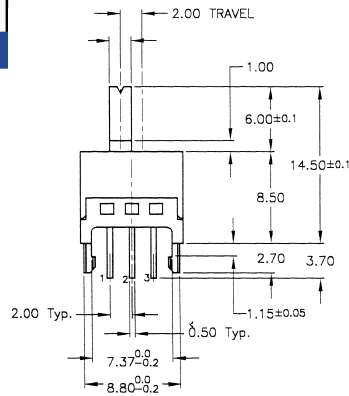
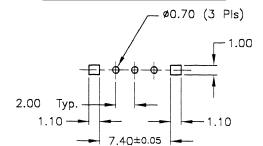

Schematic

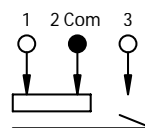

SPECIFICATIONS SUBJECT TO CHANGE WITHOUT NOTICE.

SERIES E G SWITCHES

SLIDE SWITCHES

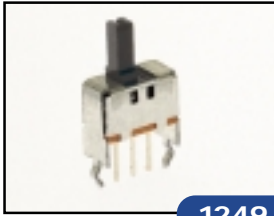

1249

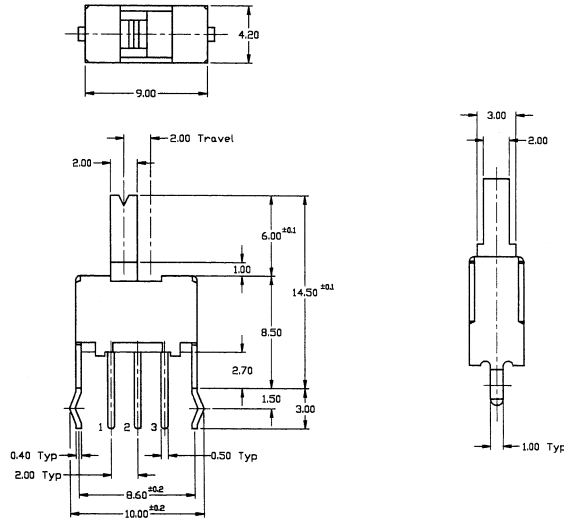

P.C. MOUNTING

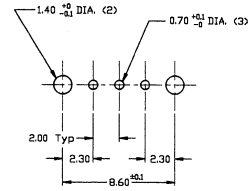

Schematic

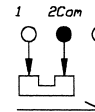

1253

Momentary Only

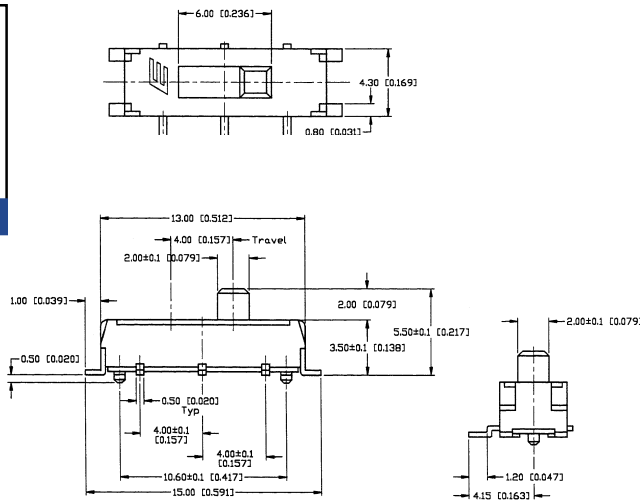

P.C. MOUNTING

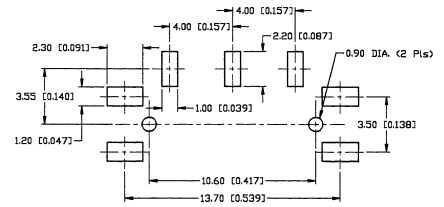

Schematic

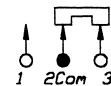

1257

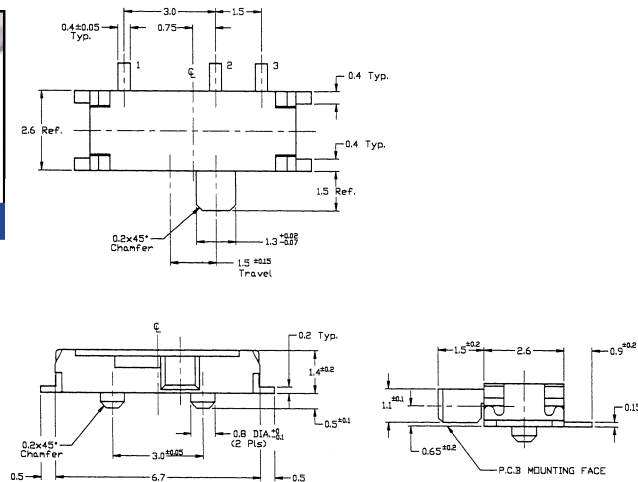

P.C. MOUNTING

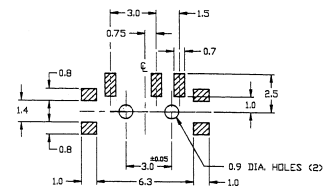

Schematic

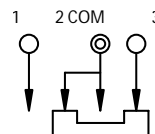

SPECIFICATIONS SUBJECT TO CHANGE WITHOUT NOTICE.

SERIES E G SWITCHES

SLIDE SWITCHES



1270

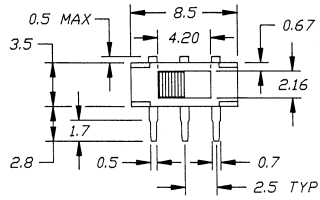

P.C. MOUNTING

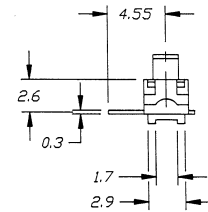
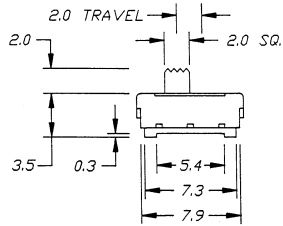
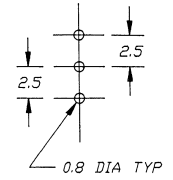

Schematic

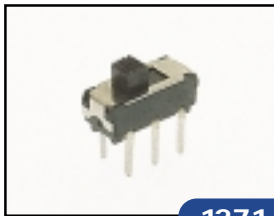
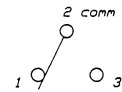

1271

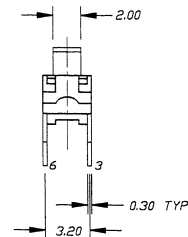
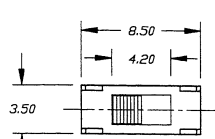

P.C. MOUNTING

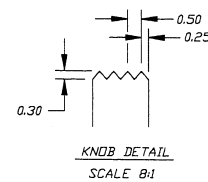
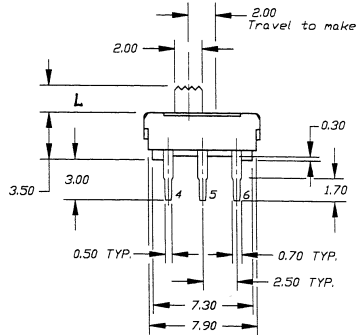
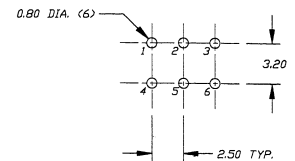

Schematic

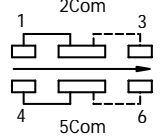

Model No.	L
EG1271	2
EG1271A	4,4

SPECIFICATIONS SUBJECT TO CHANGE WITHOUT NOTICE.



1302

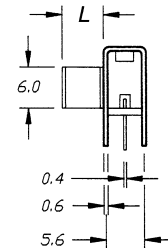
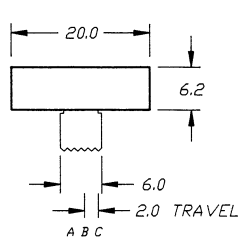

P.C. MOUNTING

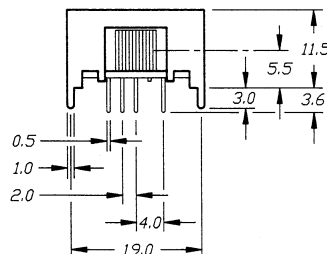
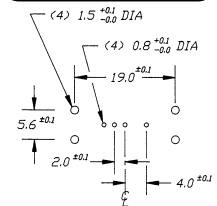

Schematic

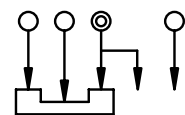

Model No.	L
EG1302	6
EG1302A	9