

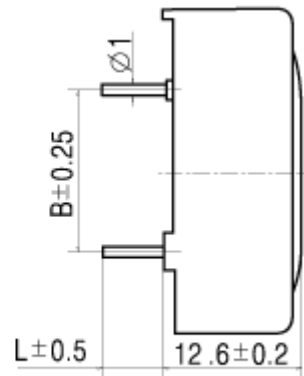

Type	BDT-401H	BDT-402H	BDT-403H	BDT-404H
Rated Impedance(Ω)	100 \pm 15%	8 \pm 15%	32 \pm 15%	16 \pm 15%
Rated(Max.) Power(W)	0.15(0.2)			
Resonance Frequency(Hz)	1000 \pm 20%			
Rated Freq. Range(Hz)	700~5000			
Sound Output at 10cm,1.5KHz(dB)	$>$ 81			
Operating Temperature($^{\circ}$ C)	-20~+85			
Storage Temperature($^{\circ}$ C)	-40~+90			
Weight(g)	10			

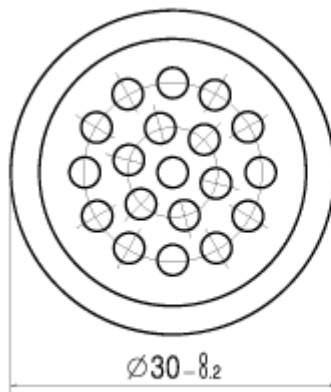

Unit:mm

